

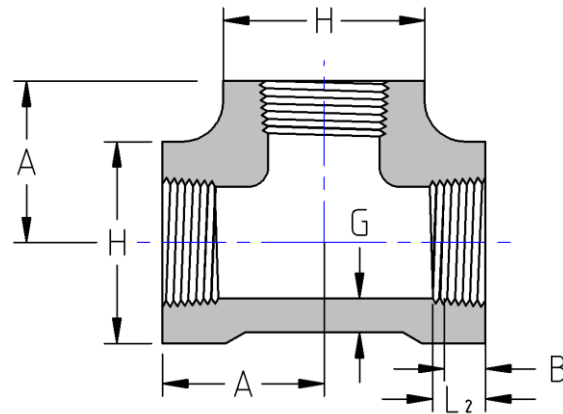

Threaded Tee
2000# Forged Steel
Inches / Pounds



Size	A	H	G (Minimum)	B**	L ₂ ** (Minimum)	Approximate Weight (in Pounds)
1/8	0.81	0.88	0.125	0.25	0.2639	0.31
1/4	0.81	0.88	0.125	0.32	0.4018	0.29
3/8	0.97	1.00	0.125	0.36	0.4078	0.37
1/2	1.12	1.31	0.125	0.43	0.5337	0.67
3/4	1.31	1.50	0.125	0.50	0.5457	0.91
1	1.50	1.81	0.145	0.58	0.6828	1.38
1 1/4	1.75	2.19	0.153	0.67	0.7068	1.96
1 1/2	2.00	2.44	0.158	0.70	0.7235	3.10
2	2.38	2.97	0.168	0.75	0.7565	4.98
2 1/2	3.00	3.62	0.221	0.93	1.1380	9.31
3	3.38	4.31	0.236	1.02	1.2000	13.3
4	4.19	5.75	0.258	1.09	1.3000	28.0

***ASME B16.11**

****Dimension B is minimum length of perfect thread. The length of useful thread (B plus threads with fully formed roots and flat crests) shall not be less than L₂ (effective length of external thread) required by ASME B1.20.1**