

REPLACEMENT PARTS PT MOTOR (38 OR 57 RPM)

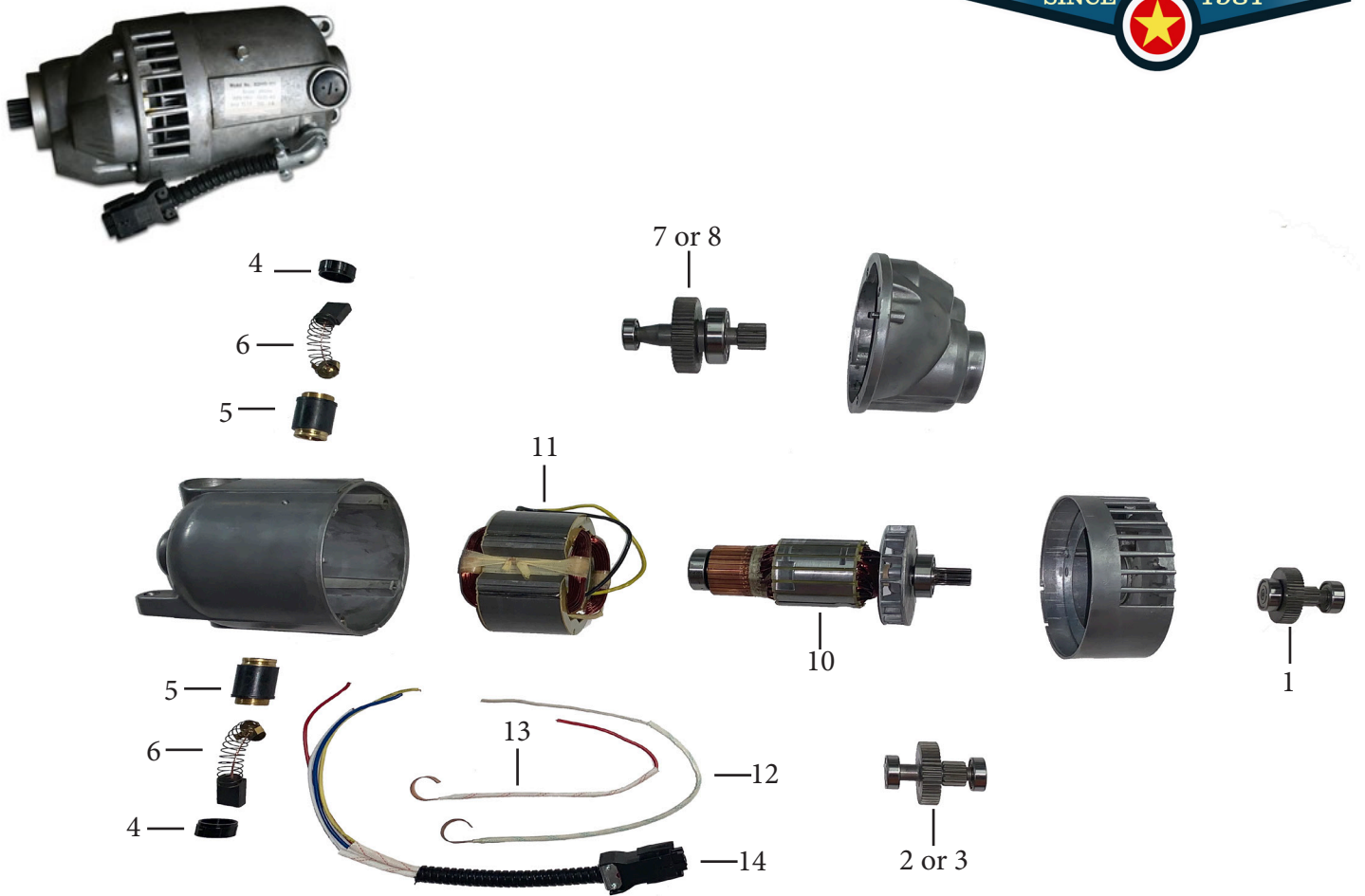

DESCRIPTION	ITEM #	DESCRIPTION	ITEM #
1: PT First Gear Assembly 38/57RPM Fits 44975 300 Power Drive Motor	3304138	8: PT Main Drive Gear Assembly 57 RPM Fits 45375 300 Power Drive	3304223-57
2: PT Second Gear Assembly 38 RPM Fits 45005 300 Power Drive Motor	3304139	9: PT Motor Armature Bearing Fits 44565 300 Power Drive	3304224
3: PT Second Gear Assembly 57 RPM Fits 44990 300 Power Drive Motor	3304139-57	10: PT Armature Fits 44010 300 Power Drive	3304225
4: PT Motor Brush Cap (2 Pack) Fits 44545 300 Power Drive Motor	3304220	11: PT Field 115v Fits 44015 300 Power Drive Motor	3304226
5: PT Motor Brush Holder (2 Pack) Fits 45025 300 Power Drive Motor	3304221	12: PT White Lead Wire Fits 86680 300 Power Drive Motor	3304229
6: PT Motor Brush Set (2 Pack) Fits 44540 300 Power Drive Motor	3304222	13: PT Red Lead Wire Fits 86685 300 Power Drive Motor	3304230
7. PT Main Drive Gear Assembly 38 RPM Fits 45370 300 Power Drive Motor	3304223	14: PT Quick Disconnect Fits 50552 300Power Drive Motor	3303324

RIDGID® is a registered trademark of RIDGID, Inc.
 ARGCO is not an authorized distributor of RIDGID® products
 ARGCO.com
 Updated 11/5/2019

