

DIMENSIONAL SPECIFICATIONS

FORGED CARBON STEEL FITTINGS 2000 LB.

THREADED 90 DEGREE ELBOW

Part #	Size (IN.)	Approx. Net WT. (LB.)	A	B	G	H	L2
C2501-04	1/4	0.18	0.81	0.32	0.13	0.88	0.40
C2501-06	3/8	0.29	0.97	0.36	0.13	1.00	0.41
C2501-08	1/2	0.55	1.12	0.43	0.13	1.31	0.53
C2501-12	3/4	0.77	1.31	0.50	0.13	1.50	0.56
C2501-16	1	1.17	1.50	0.58	0.15	1.81	0.68
C2501-20	1-1/4	1.81	1.75	0.67	0.15	2.19	0.71
C2501-24	1-1/2	2.34	2.00	0.70	0.16	2.44	0.72
C2501-32	2	3.75	2.38	0.75	0.17	2.97	0.76
C2501-40	2-1/2	6.92	3.00	0.93	0.22	3.62	1.14
C2501-48	3	10.01	3.38	1.02	0.24	4.31	1.20
C2501-64	4	22.50	4.19	1.09	0.26	5.75	1.30

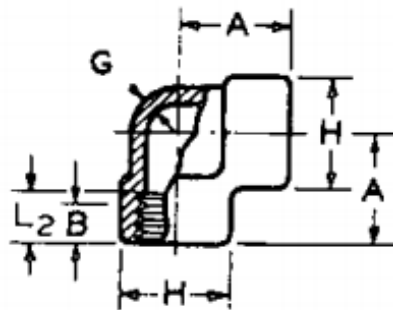

MERIT
BRASS

DIRECTING THE FLOW OF *Quality*

DIMENSIONAL SPECIFICATIONS

FORGED CARBON STEEL FITTINGS 2000 LB.

THREADED 45 DEGREE ELBOW

Part #	Size (IN.)	Approx. Net WT. (LB.)	C	H
C2502-04	1/4	0.29	0.69	0.88
C2502-06	3/8	0.22	0.75	1.00
C2502-08	1/2	0.44	0.88	1.31
C2502-12	3/4	0.60	1.00	1.50
C2502-16	1	0.90	1.12	1.81
C2502-20	1-1/4	1.50	1.31	2.19
C2502-24	1-1/2	1.81	1.38	2.44
C2502-32	2	3.11	1.69	2.97
C2502-40	2-1/2	7.63	2.06	3.62
C2502-48	3	11.99	2.50	4.31
C2502-64	4	19.75	3.12	5.75

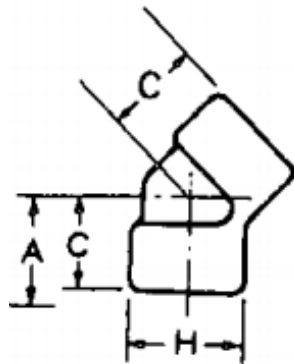

MERIT
BRASS

DIRECTING THE FLOW OF *Quality*

DIMENSIONAL SPECIFICATIONS

FORGED CARBON STEEL FITTINGS 2000 LB.



THREADED TEE

Part #	Size (IN.)	Approx. Net WT. (LB.)	A	H
C2506-04	1/4	0.26	0.81	0.88
C2506-06	3/8	0.37	0.97	1.00
C2506-08	1/2	0.68	1.12	1.31
C2506-12	3/4	0.95	1.31	1.50
C2506-16	1	1.52	1.50	1.81
C2506-20	1-1/4	2.36	1.75	2.19
C2506-24	1-1/2	3.06	2.00	2.44
C2506-32	2	4.76	2.38	2.97
C2506-40	2-1/2	9.06	3.00	3.62
C2506-48	3	13.49	3.38	4.31
C2506-64	4	32.49	4.19	5.75

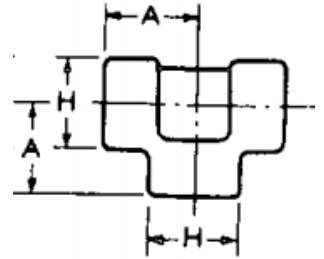
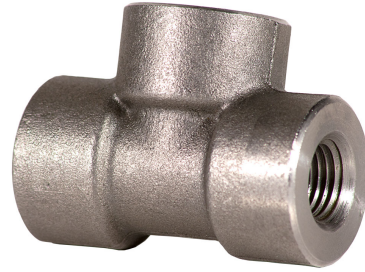

THREADED CROSS

Part #	Size (IN.)	Approx. Net WT. (LB.)	A	H
C2510-08	1/2	0.88	1.12	1.31
C2510-12	3/4	1.12	1.31	1.50
C2510-16	1	1.70	1.50	1.81
C2510-20	1-1/4	2.45	1.75	2.19
C2510-24	1-1/2	3.57	2.00	2.44
C2510-32	2	5.77	2.38	2.97

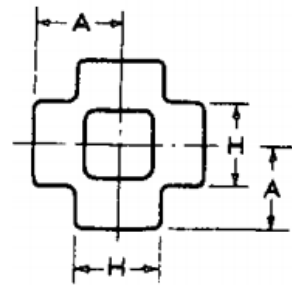

**MERIT
BRASS**

DIRECTING THE FLOW OF *Quality*

DIMENSIONAL SPECIFICATIONS

FORGED CARBON STEEL FITTINGS 3000 LB.

THREADED 90 DEGREE ELBOW

Part #	Size (IN.)	Approx. Net WT. (LB.)	A	B	G	H	L2
C3501-02	1/8	0.22	0.81	0.25	0.13	0.88	0.26
C3501-04	1/4	0.73	0.97	0.32	0.13	1.00	0.40
C3501-06	3/8	0.64	1.12	0.36	0.14	1.31	0.41
C3501-08	1/2	0.90	1.31	0.43	0.16	1.50	0.53
C3501-12	3/4	1.59	1.50	0.50	0.17	1.81	0.56
C3501-16	1	2.27	1.75	0.58	0.20	2.19	0.68
C3501-20	1-1/4	3.13	2.00	0.67	0.21	2.44	0.71
C3501-24	1-1/2	4.87	2.38	0.70	0.22	2.97	0.72
C3501-32	2	5.44	2.50	0.75	0.28	3.31	0.76
C3501-40	2-1/2	13.20	3.25	0.93	0.30	4.00	1.14
C3501-48	3	19.57	3.75	1.02	0.35	4.75	1.20
C3501-64	4	32.73	4.50	1.09	0.44	6.00	1.30

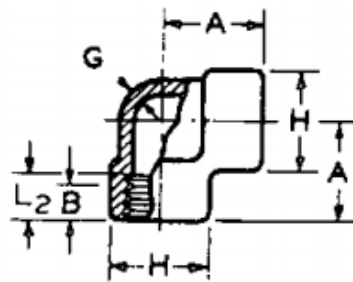

**MERIT
BRASS**

DIRECTING THE FLOW OF *Quality*

DIMENSIONAL SPECIFICATIONS

FORGED CARBON STEEL FITTINGS 3000 LB.

THREADED 90 DEGREE STREET ELBOW

Part #	Size (IN.)	Approx. Net WT. (LB.)	A	B	G1	G2	H	J	L	L2
C3503-02	1/8	0.20	0.75	0.25	0.13	0.11	0.75	1.00	0.38	0.26
C3503-04	1/4	0.24	0.88	0.32	0.13	0.13	1.00	1.25	0.44	0.40
C3503-06	3/8	0.48	1.00	0.36	0.14	0.14	1.25	1.50	0.50	0.41
C3503-08	1/2	0.68	1.12	0.43	0.16	0.16	1.50	1.62	0.56	0.54
C3503-12	3/4	1.17	1.38	0.50	0.17	0.19	1.75	1.88	0.62	0.55
C3503-16	1	2.25	1.75	0.58	0.20	0.22	2.00	2.25	0.75	0.68
C3503-20	1-1/4	2.49	2.00	0.67	0.21	0.22	2.44	2.62	0.81	0.71
C3503-24	1-1/2	4.43	2.12	0.70	0.21	0.24	2.75	2.81	0.81	0.72
C3503-32	2	6.41	2.50	0.75	0.28	0.30	3.31	3.31	0.88	0.76

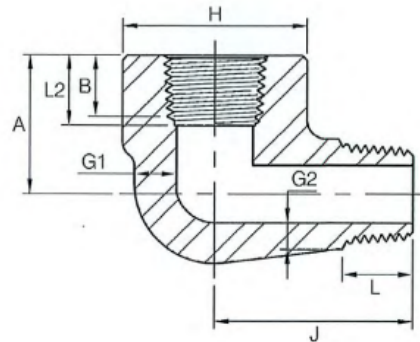
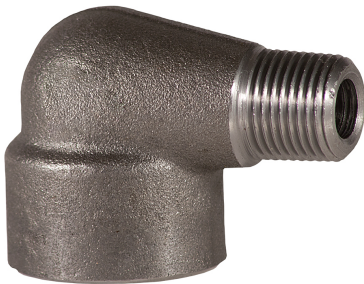

**MERIT
BRASS**

DIRECTING THE FLOW OF *Quality*

DIMENSIONAL SPECIFICATIONS

FORGED CARBON STEEL FITTINGS 3000 LB.

THREADED 45 DEGREE ELBOW

Part #	Size (IN.)	Approx. Net WT. (LB.)	C	H
C3502-02	1/8	0.29	0.69	0.88
C3502-04	1/4	0.26	0.75	1.00
C3502-06	3/8	0.53	0.88	1.31
C3502-08	1/2	0.75	1.00	1.50
C3502-12	3/4	1.23	1.12	1.81
C3502-16	1	2.07	1.31	2.19
C3502-20	1-1/4	2.27	1.38	2.44
C3502-24	1-1/2	4.52	1.69	2.97
C3502-32	2	4.91	1.72	3.31
C3502-40	2-1/2	8.18	2.06	4.00
C3502-48	3	13.16	2.50	4.75
C3502-64	4	19.75	3.12	6.00

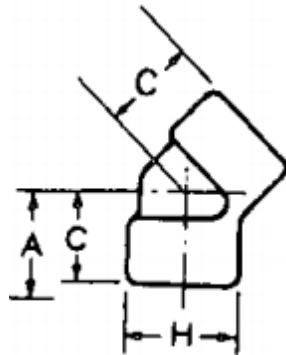

MERIT
BRASS

DIRECTING THE FLOW OF *Quality*

DIMENSIONAL SPECIFICATIONS

FORGED CARBON STEEL FITTINGS 3000 LB.

THREADED TEE

Part #	Size (IN.)	Approx. Net WT. (LB.)	A	H
C3506-02	1/8	0.29	0.81	0.88
C3506-04	1/4	0.44	0.97	1.00
C3506-06	3/8	0.84	1.12	1.31
C3506-08	1/2	1.23	1.31	1.50
C3506-12	3/4	2.03	1.50	1.81
C3506-16	1	3.28	1.75	2.19
C3506-20	1-1/4	3.88	2.00	2.44
C3506-24	1-1/2	7.21	2.38	2.97
C3506-32	2	7.78	2.50	3.31
C3506-40	2-1/2	15.41	3.25	4.00
C3506-48	3	22.46	3.75	4.75
C3506-64	4	39.67	4.50	6.00

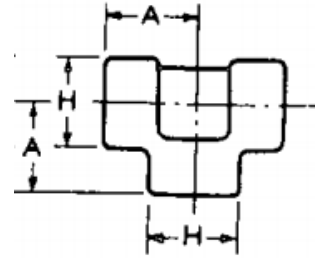
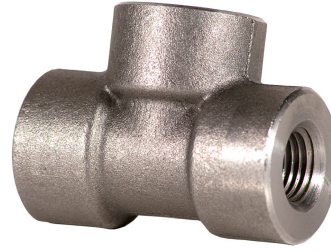

THREADED REDUCING TEE

Part #	Size (IN.)	Approx. Net WT. (LB.)	A	B	C
C3506-1208	3/4 X 1/2	1.85	1.08	1.08	1.11
C3506-1608	1 X 1/2	3.00	1.20	1.20	1.24
C3506-1612	1 X 3/4	3.00	1.30	1.30	1.31
C3506-2408	1-1/2 X 1/2	6.83	1.32	1.32	1.53

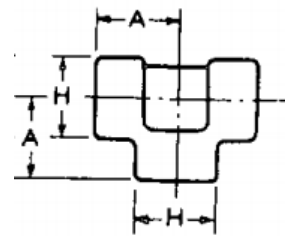
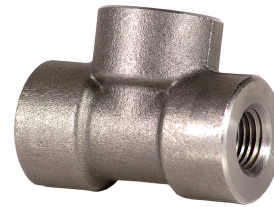

**MERIT
BRASS**

DIRECTING THE FLOW OF *Quality*

DIMENSIONAL SPECIFICATIONS

FORGED CARBON STEEL FITTINGS 3000 LB.

THREADED CROSS

Part #	Size (IN.)	Approx. Net WT. (LB.)	A	H
C3510-08	1/2	1.43	1.31	1.50
C3510-12	3/4	2.31	1.50	1.81
C3510-16	1	3.75	1.75	2.19
C3510-20	1-1/4	4.78	2.00	2.44
C3510-24	1-1/2	8.66	2.38	2.97
C3510-32	2	9.68	2.50	3.31

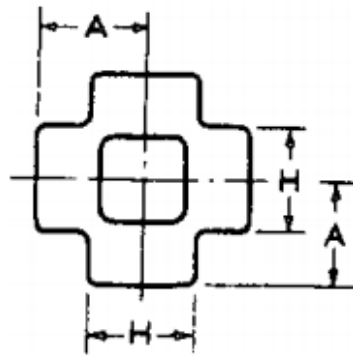

MERIT
BRASS

DIRECTING THE FLOW OF *Quality*

DIMENSIONAL SPECIFICATIONS

FORGED CARBON STEEL FITTINGS 3000 LB.

THREADED COUPLING

Part #	Size (IN.)	Approx. Net WT. (LB.)	B	D	L2	W
C3511-02	1/8	0.11	0.25	0.62	0.26	1.25
C3511-04	1/4	0.09	0.32	0.75	0.40	1.38
C3511-06	3/8	0.13	0.36	0.88	0.41	1.50
C3511-08	1/2	0.29	0.43	1.12	0.53	1.81
C3511-12	3/4	0.42	0.50	1.38	0.56	2.00
C3511-16	1	0.99	0.58	1.75	0.70	2.38
C3511-20	1-1/4	1.79	0.67	2.25	0.71	2.62
C3511-24	1-1/2	2.36	0.70	2.50	0.73	3.12
C3511-32	2	3.09	0.75	3.00	0.76	3.38
C3511-40	2-1/2	5.05	0.93	3.62	1.14	3.62
C3511-48	3	7.45	1.02	4.25	1.20	4.25
C3511-64	4	13.84	1.09	5.50	1.30	4.75

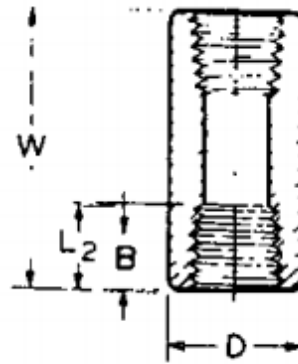

MERIT
BRASS

DIRECTING THE FLOW OF *Quality*

DIMENSIONAL SPECIFICATIONS

FORGED CARBON STEEL FITTINGS 3000 LB.

THREADED HALF COUPLING

Part #	Size (IN.)	Approx. Net WT. (LB.)	B	D	L2	W/2
C3511H-02	1/8	0.04	0.25	0.62	0.26	0.63
C3511H-04	1/4	0.04	0.32	0.75	0.40	0.69
C3511H-06	3/8	0.04	0.36	0.88	0.41	0.75
C3511H-08	1/2	0.13	0.43	1.12	0.53	0.91
C3511H-12	3/4	0.22	0.50	1.38	0.56	1.00
C3511H-16	1	0.51	0.58	1.75	0.68	1.19
C3511H-20	1-1/4	0.75	0.67	2.25	0.71	1.34
C3511H-24	1-1/2	1.19	0.70	2.50	0.73	1.56
C3511H-32	2	1.54	0.75	3.00	0.76	1.70
C3511H-40	2-1/2	2.49	0.93	3.62	1.14	1.81
C3511H-48	3	3.70	1.02	4.25	1.20	2.13
C3511H-64	4	6.85	1.09	5.50	1.30	2.38

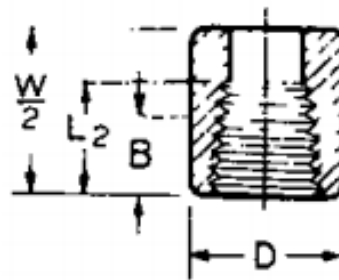

MERIT
BRASS

DIRECTING THE FLOW OF *Quality*

DIMENSIONAL SPECIFICATIONS

FORGED CARBON STEEL FITTINGS 3000 LB.

THREADED REDUCING COUPLING

Part #	Size (IN.)	Approx. Net WT. (LB.)	A
C3512-0402	1/4 X 1/8	0.11	0.92
C3512-0602	3/8 X 1/8	0.15	0.92
C3512-0604	3/8 X 1/4	0.13	0.92
C3512-0802	1/2 X 1/8	0.29	1.17
C3512-0804	1/2 X 1/4	0.29	1.17
C3512-0806	1/2 X 3/8	0.29	1.17
C3512-1202	3/4 X 1/8	0.42	1.35
C3512-1204	3/4 X 1/4	0.42	1.35
C3512-1206	3/4 X 3/8	0.42	1.35
C3512-1208	3/4 X 1/2	0.42	1.35
C3512-1602	1 X 1/8	0.86	1.56
C3512-1604	1 X 1/4	0.86	1.56
C3512-1606	1 X 3/8	0.86	1.56
C3512-1608	1 X 1/2	0.86	1.56
C3512-1612	1 X 3/4	0.86	1.56
C3512-2002	1-1/4 X 1/8	1.50	1.77
C3512-2004	1-1/4 X 1/4	1.50	1.77
C3512-2006	1-1/4 X 3/8	1.50	1.77
C3512-2008	1-1/4 X 1/2	1.50	1.77
C3512-2012	1-1/4 X 3/4	1.50	1.77
C3512-2016	1-1/4 X 1	1.50	1.80
C3512-2402	1-1/2 X 1/8	2.18	1.80
C3512-2404	1-1/2 X 1/4	2.18	1.80
C3512-2406	1-1/2 X 3/8	2.18	1.80

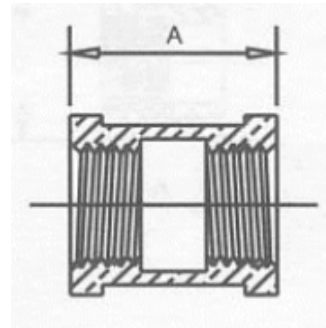

**MERIT
BRASS**

DIRECTING THE FLOW OF *Quality*

DIMENSIONAL SPECIFICATIONS

FORGED CARBON STEEL FITTINGS 3000 LB.

THREADED REDUCING COUPLING CONTINUED

Part #	Size (IN.)	Approx. Net WT. (LB.)	A
C3512-2408	1-1/2 X 1/2	2.18	1.80
C3512-2412	1-1/2 X 3/4	2.18	1.80
C3512-2416	1-1/2 X 1	2.18	1.80
C3512-2420	1-1/2 X 1-1/4	2.18	1.80
C3512-3202	2 X 1/8	3.02	2.03
C3512-3204	2 X 1/4	3.02	2.03
C3512-3206	2 X 3/8	3.02	2.03
C3512-3208	2 X 1/2	3.02	2.03
C3512-3212	2 X 3/4	3.02	2.03
C3512-3216	2 X 1	4.54	2.03
C3512-3220	2 X 1-1/4	3.31	2.03
C3512-3224	2 X 1-1/2	3.92	2.03
C3512-4016	2-1/2 X 1	4.56	3.15
C3512-4020	2-1/2 X 1-1/4	4.56	3.15
C3512-4024	2-1/2 X 1-1/2	4.56	3.15
C3512-4032	2-1/2 X 2	4.56	3.15
C3512-4816	3 X 1	6.79	3.69
C3512-4820	3 X 1-1/4	6.79	3.69
C3512-4824	3 X 1-1/2	6.79	3.69
C3512-4832	3 X 2	6.79	3.69
C3512-6424	4 X 1-1/2	11.99	4.38
C3512-6432	4 X 2	11.99	4.38
C3512-6448	4 X 3	11.99	4.38

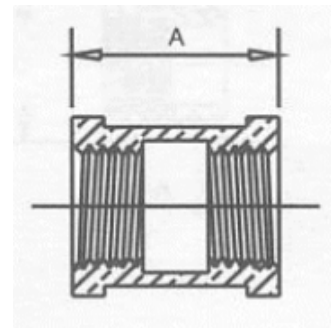

**MERIT
BRASS**

DIRECTING THE FLOW OF *Quality*

DIMENSIONAL SPECIFICATIONS

FORGED CARBON STEEL FITTINGS 3000 LB.

THREADED HEX HEAD BUSHING

Part #	Size (IN.)	Approx. Net WT. (LB.)	A	F	G
C3514-0402	1/4 X 1/8	0.02	0.44	0.62	0.12
C3514-0602	3/8 X 1/8	0.02	0.50	0.69	0.16
C3514-0604	3/8 X 1/4	0.02	0.50	0.69	0.16
C3514-0804	1/2 X 1/4	0.07	0.56	0.88	0.19
C3514-0806	1/2 X 3/8	0.07	0.56	0.88	0.19
C3514-1204	3/4 X 1/4	0.11	0.62	1.06	0.22
C3514-1206	3/4 X 3/8	0.11	0.62	1.06	0.22
C3514-1208	3/4 X 1/2	0.11	0.62	1.06	0.22
C3514-1604	1 X 1/4	0.20	0.75	1.38	0.25
C3514-1606	1 X 3/8	0.20	0.75	1.38	0.25
C3514-1608	1 X 1/2	0.20	0.75	1.38	0.25
C3514-1612	1 X 3/4	0.20	0.75	1.38	0.25
C3514-2004	1-1/4 X 1/4	0.55	0.81	1.75	0.28
C3514-2008	1-1/4 X 1/2	0.55	0.81	1.75	0.28
C3514-2012	1-1/4 X 3/4	0.55	0.81	1.75	0.28

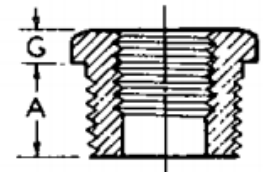
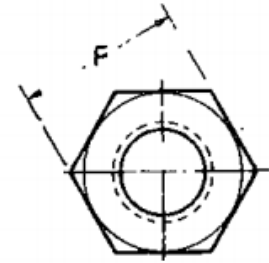

**MERIT
BRASS**

DIRECTING THE FLOW OF *Quality*

DIMENSIONAL SPECIFICATIONS

FORGED CARBON STEEL FITTINGS 3000 LB.

THREADED HEX HEAD BUSHING CONTINUED

Part #	Size (IN.)	Approx. Net WT. (LB.)	A	F	G
C3514-2016	1-1/4 X 1	0.55	0.81	1.75	0.28
C3514-2408	1-1/2 X 1/2	0.75	0.81	2.00	0.31
C3514-2412	1-1/2 X 3/4	0.88	0.81	2.00	0.31
C3514-2416	1-1/2 X 1/2	0.75	0.81	2.00	0.31
C3514-2420	1-1/2 X 1-1/4	0.75	0.81	2.00	0.31
C3514-3204	2 X 1/4	0.99	0.88	2.50	0.34
C3514-3208	2 X 1/2	1.83	0.88	2.50	0.34
C3514-3212	2 X 3/4	1.70	0.88	2.50	0.34
C3514-3216	2 X 1	1.54	0.88	2.50	0.34
C3514-3220	2 X 1-1/4	0.99	0.88	2.50	0.34
C3514-3224	2 X 1-1/2	0.99	0.88	2.50	0.34
C3514-4032	2-1/2 X 2	1.32	1.06	3.00	0.38
C3514-4832	3 X 2	2.56	1.12	3.50	0.41
C3514-4840	3 X 2-1/2	2.56	1.12	3.50	0.41
C3514-6448	4 X 3	4.63	1.25	4.62	0.50

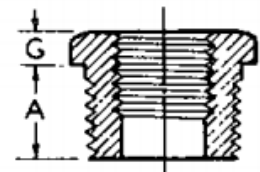
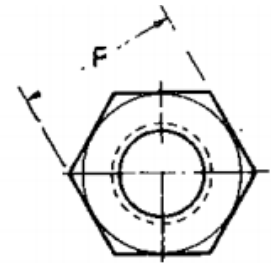

MERIT
BRASS

DIRECTING THE FLOW OF *Quality*

DIMENSIONAL SPECIFICATIONS

FORGED CARBON STEEL FITTINGS 3000 LB.

THREADED CAP

Part #	Size (IN.)	Approx. Net WT. (LB.)	B	D	G	L2	P
C3516-02	1/8	0.04	0.25	0.62	0.19	0.26	0.75
C3516-04	1/4	0.09	0.32	0.75	0.19	0.40	1.00
C3516-06	3/8	0.11	0.36	0.88	0.19	0.41	1.00
C3516-08	1/2	0.24	0.43	1.12	0.25	0.53	1.25
C3516-12	3/4	0.40	0.50	1.38	0.25	0.56	1.44
C3516-16	1	0.82	0.58	1.75	0.38	0.68	1.62
C3516-20	1-1/4	1.37	0.67	2.25	0.38	0.71	1.75
C3516-24	1-1/2	1.59	0.70	2.50	0.44	0.72	1.75
C3516-32	2	2.40	0.75	3.00	0.50	0.76	1.88
C3516-40	2-1/2	4.89	0.93	3.62	0.62	1.14	2.38
C3516-48	3	7.71	1.02	4.25	0.75	1.20	2.56
C3516-64	4	10.67	1.09	5.50	0.88	1.30	2.69

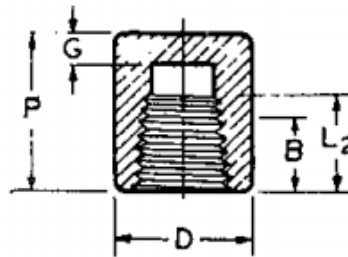

MERIT
BRASS

DIRECTING THE FLOW OF *Quality*

DIMENSIONAL SPECIFICATIONS

FORGED CARBON STEEL FITTINGS 3000 LB.



THREADED SQUARE HEAD CORED PLUG

Part #	Size (IN.)	Approx. Net WT. (LB.)	A	B	C
C3517-08	1/2	0.11	0.56	0.38	0.56
C3517-12	3/4	0.20	0.62	0.44	0.62
C3517-16	1	0.35	0.75	0.50	0.81
C3517-20	1-1/4	0.60	0.81	0.56	0.94
C3517-24	1-1/2	0.84	0.81	0.62	1.12
C3517-32	2	1.39	0.88	0.69	1.31

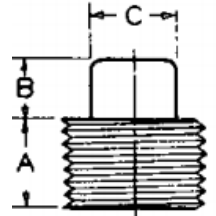

THREADED SQUARE HEAD SOLID PLUG

Part #	Size (IN.)	Approx. Net WT. (LB.)	A	B	C
C3517A-02	1/8	0.02	0.38	0.25	0.28
C3517A-04	1/4	0.02	0.44	0.25	0.38
C3517A-06	3/8	0.07	0.50	0.31	0.44

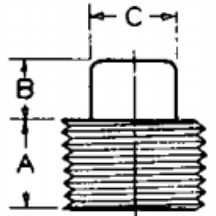

MERIT
BRASS

DIRECTING THE FLOW OF *Quality*

DIMENSIONAL SPECIFICATIONS

FORGED CARBON STEEL FITTINGS 3000 LB.



THREADED HEX HEAD PLUG

Part #	Size (IN.)	Approx. Net WT. (LB.)	A	F	H
C3517H-02	1/8	0.02	0.38	0.44	0.25
C3517H-04	1/4	0.07	0.44	0.62	0.25
C3517H-06	3/8	0.09	0.50	0.69	0.31
C3517H-08	1/2	0.15	0.56	0.88	0.31
C3517H-12	3/4	0.31	0.62	1.06	0.38
C3517H-16	1	0.48	0.75	1.38	0.38
C3517H-20	1-1/4	0.97	0.81	1.75	0.56
C3517H-24	1-1/2	1.30	0.81	2.00	0.62
C3517H-32	2	2.27	0.88	2.50	0.69

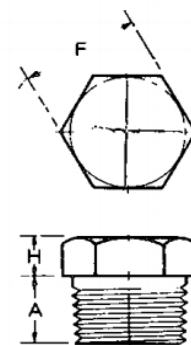

THREADED ROUND HEAD PLUG

Part #	Size (IN.)	Approx. Net WT. (LB.)	D	E
C3517R-02	1/8	0.10	1.38	0.41
C3517R-04	1/4	0.15	1.62	0.53
C3517R-06	3/8	0.20	1.62	0.69
C3517R-08	1/2	0.26	1.75	0.84
C3517R-12	3/4	0.44	1.75	1.06
C3517R-16	1	0.75	2.00	1.31
C3517R-20	1-1/4	1.21	2.00	1.69
C3517R-24	1-1/2	1.74	2.00	1.91
C3517R-32	2	3.24	2.50	2.38

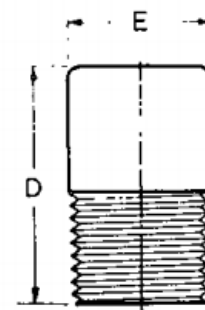

MERIT
BRASS

DIRECTING THE FLOW OF *Quality*

DIMENSIONAL SPECIFICATIONS

FORGED CARBON STEEL FITTINGS 3000 LB.

THREADED UNION

Part #	Size (IN.)	Approx. Net WT. (LB.)	A	C	D	F	G	J	L	N
C3587-02	1/8	0.62	0.58	0.09	0.26	0.12	0.13	0.05	1.63	1.93
C3587-04	1/4	0.62	0.75	0.12	0.38	0.12	0.13	0.05	1.63	1.93
C3587-06	3/8	0.53	0.90	0.13	0.54	0.14	0.13	0.05	1.81	2.17
C3587-08	1/2	0.75	1.09	0.15	0.68	0.14	0.15	0.06	1.93	2.24
C3587-12	3/4	1.06	1.32	0.15	0.85	0.16	0.16	0.07	2.24	2.64
C3587-16	1	1.70	1.63	0.18	1.10	0.18	0.17	0.07	2.44	3.11
C3587-20	1-1/4	2.27	1.99	0.19	1.40	0.21	0.20	0.08	2.80	3.70
C3587-24	1-1/2	3.59	2.25	0.20	1.63	0.23	0.22	0.09	3.01	4.37
C3587-32	2	5.36	2.76	0.22	2.06	0.26	0.25	0.11	3.39	5.20
C3587-40	2-1/2	8.01	3.36	0.28	2.54	0.29	0.28	0.12	4.03	5.83
C3587-48	3	11.62	4.03	0.30	3.05	0.32	0.31	0.14	4.29	6.89
C3587-64	4	26.45	5.59	0.32	4.03	0.36	0.33	0.15	4.98	7.50

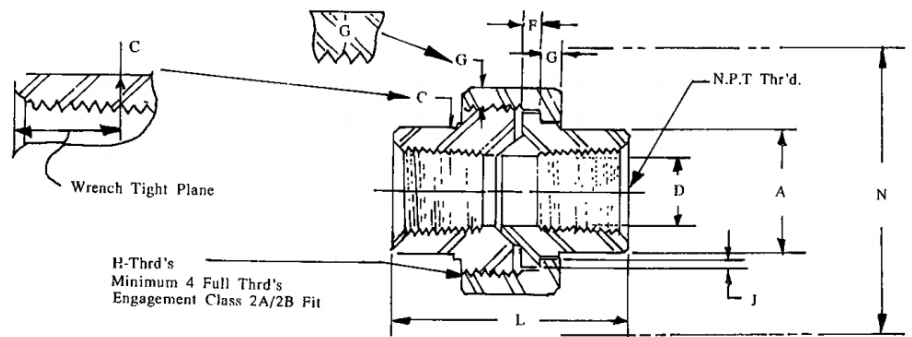

MERIT BRASS

DIRECTING THE FLOW OF *Quality*

DIMENSIONAL SPECIFICATIONS

FORGED CARBON STEEL FITTINGS 3000 LB.

SOCKET WELD 90 DEGREE ELBOW

Part #	Size (IN.)	Approx. Net WT. (LB.)	A	B	C	D	G	J
CSW3501-02	1/8	0.20	0.44	0.43	0.13	0.27	0.10	0.38
CSW3501-04	1/4	0.31	0.44	0.57	0.15	0.36	0.12	0.38
CSW3501-06	3/8	0.26	0.53	0.70	0.16	0.49	0.13	0.38
CSW3501-08	1/2	0.48	0.62	0.87	0.18	0.63	0.15	0.38
CSW3501-12	3/4	0.73	0.75	1.08	0.19	0.82	0.15	0.50
CSW3501-16	1	1.17	0.88	1.34	0.22	1.05	0.18	0.50
CSW3501-20	1-1/4	1.85	1.06	1.69	0.24	1.38	0.19	0.50
CSW3501-24	1-1/2	2.38	1.25	1.93	0.25	1.61	0.20	0.50
CSW3501-32	2	3.70	1.50	2.42	0.27	2.07	0.22	0.62
CSW3501-40	2-1/2	7.05	1.62	2.92	0.35	2.47	0.28	0.62
CSW3501-48	3	11.86	2.25	3.55	0.38	3.07	0.30	0.62
CSW3501-64	4	24.13	2.62	4.56	0.42	4.03	0.34	0.62

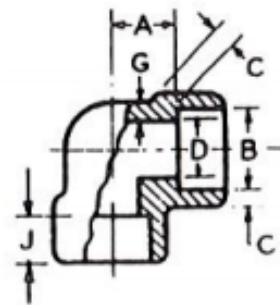

MERIT
BRASS

DIRECTING THE FLOW OF *Quality*

DIMENSIONAL SPECIFICATIONS

FORGED CARBON STEEL FITTINGS 3000 LB.

SOCKET WELD 45 DEGREE ELBOW

Part #	Size (IN.)	Approx. Net WT. (LB.)	A	B	C	D	G	J
CSW3502-02	1/8	0.35	0.31	0.43	0.13	0.27	0.10	0.38
CSW3502-04	1/4	0.31	0.31	0.57	0.15	0.36	0.12	0.38
CSW3502-06	3/8	0.26	0.31	0.70	0.16	0.49	0.13	0.38
CSW3502-08	1/2	0.44	0.44	0.87	0.18	0.62	0.15	0.38
CSW3502-12	3/4	0.62	0.50	1.08	0.19	0.82	0.15	0.50
CSW3502-16	1	0.93	0.56	1.34	0.22	1.05	0.18	0.50
CSW3502-20	1-1/4	1.52	0.69	1.69	0.24	1.38	0.19	0.50
CSW3502-24	1-1/2	1.76	0.81	1.93	0.25	1.61	0.20	0.50
CSW3502-32	2	2.98	1.00	2.42	0.27	2.07	0.22	0.62
CSW3502-40	2-1/2	5.58	1.12	2.92	0.35	2.47	0.28	0.62
CSW3502-48	3	11.24	1.25	3.55	0.38	3.07	0.30	0.62
CSW3502-64	4	20.74	1.62	4.56	0.42	4.03	0.34	0.62

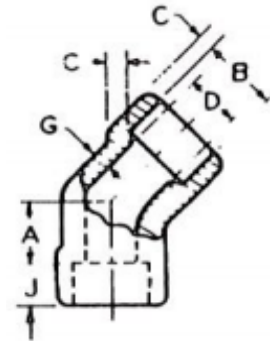

**MERIT
BRASS**

DIRECTING THE FLOW OF *Quality*

DIMENSIONAL SPECIFICATIONS

FORGED CARBON STEEL FITTINGS 3000 LB.

SOCKET WELD TEE

Part #	Size (IN.)	Approx. Net WT. (LB.)	A	B	C	D	G	J
CSW3506-02	1/8	0.29	0.44	0.43	0.13	0.27	0.10	0.38
CSW3506-04	1/4	0.20	0.44	0.57	0.15	0.36	0.12	0.38
CSW3506-06	3/8	0.33	0.53	0.70	0.16	0.49	0.13	0.38
CSW3506-08	1/2	0.64	0.62	0.87	0.18	0.62	0.15	0.38
CSW3506-12	3/4	0.93	0.75	1.08	0.19	0.82	0.15	0.50
CSW3506-16	1	1.43	0.88	1.34	0.22	1.05	0.18	0.50
CSW3506-20	1-1/4	2.29	1.06	1.69	0.24	1.38	0.19	0.50
CSW3506-24	1-1/2	2.98	1.25	1.93	0.25	1.61	0.20	0.50
CSW3506-32	2	4.50	1.50	2.42	0.27	2.07	0.22	0.62
CSW3506-40	2-1/2	8.77	1.62	2.92	0.35	2.47	0.28	0.62
CSW3506-48	3	13.00	2.25	3.55	0.38	3.07	0.30	0.62
CSW3506-64	4	39.47	2.62	4.56	0.42	4.03	0.34	0.62

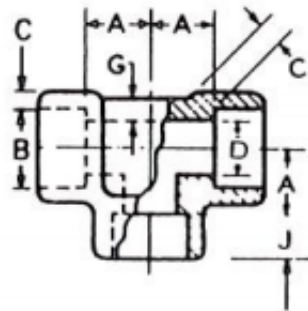

**MERIT
BRASS**

DIRECTING THE FLOW OF *Quality*

DIMENSIONAL SPECIFICATIONS

FORGED CARBON STEEL FITTINGS 3000 LB.

SOCKET WELD CROSS

Part #	Size (IN.)	Approx. Net WT. (LB.)	A	B	C	D	J
CSW3510-08	1/2	0.86	0.62	0.87	0.18	0.62	0.38
CSW3510-12	3/4	1.06	0.75	1.08	0.19	0.82	0.50
CSW3510-16	1	1.65	0.88	1.34	0.22	1.05	0.50
CSW3510-20	1-1/4	2.62	1.06	1.69	0.24	1.38	0.50
CSW3510-24	1-1/2	3.55	1.25	1.93	0.25	1.61	0.50
CSW3510-32	2	5.18	1.50	2.42	0.27	2.07	0.63

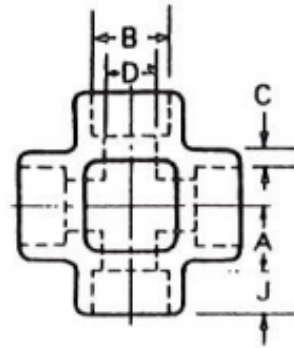

MERIT
BRASS

DIRECTING THE FLOW OF *Quality*

DIMENSIONAL SPECIFICATIONS

FORGED CARBON STEEL FITTINGS 3000 LB.

SOCKET WELD COUPLING

Part #	Size (IN.)	Approx. Net WT. (LB.)	B	C	D	E	J
CSW3511-02	1/8	0.09	0.43	0.13	0.27	0.25	0.38
CSW3511-04	1/4	0.11	0.57	0.15	0.36	0.25	0.38
CSW3511-06	3/8	0.15	0.70	0.16	0.49	0.25	0.38
CSW3511-08	1/2	0.29	0.87	0.18	0.62	0.38	0.38
CSW3511-12	3/4	0.37	1.08	0.19	0.82	0.38	0.50
CSW3511-16	1	0.64	1.34	0.22	1.05	0.53	0.50
CSW3511-20	1-1/4	0.99	1.69	0.24	1.38	0.53	0.50
CSW3511-24	1-1/2	1.30	1.93	0.25	1.61	0.53	0.50
CSW3511-32	2	1.90	2.42	0.27	2.07	0.75	0.62
CSW3511-40	2-1/2	3.09	2.92	0.35	2.47	0.5	0.62
CSW3511-48	3	3.92	3.55	0.38	3.07	0.75	0.62
CSW3511-64	4	6.28	4.56	0.42	4.03	0.5	0.62

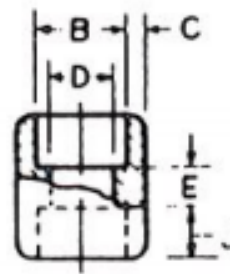

**MERIT
BRASS**

DIRECTING THE FLOW OF *Quality*

DIMENSIONAL SPECIFICATIONS

FORGED CARBON STEEL FITTINGS 3000 LB.

SOCKET WELD HALF COUPLING

Part #	Size (IN.)	Approx. Net WT. (LB.)	B	C	D	F	J
CSW3511H-02	1/8	0.11	0.43	0.13	0.27	0.62	0.38
CSW3511H-04	1/4	0.11	0.57	0.15	0.36	0.62	0.38
CSW3511H-06	3/8	0.15	0.70	0.16	0.49	0.69	0.38
CSW3511H-08	1/2	0.29	0.87	0.18	0.62	0.88	0.38
CSW3511H-12	3/4	0.46	1.08	0.19	0.82	0.94	0.50
CSW3511H-16	1	0.66	1.34	0.22	1.05	1.12	0.50
CSW3511H-20	1-1/4	0.75	1.69	0.24	1.38	1.19	0.50
CSW3511H-24	1-1/2	1.45	1.93	0.25	1.61	1.25	0.50
CSW3511H-32	2	2.40	2.42	0.27	2.07	1.62	0.62
CSW3511H-40	2-1/2	3.59	2.92	0.35	2.47	1.69	0.62
CSW3511H-48	3	4.63	3.55	0.38	3.07	1.75	0.62
CSW3511H-64	4	8.18	4.56	0.42	4.03	1.88	0.62

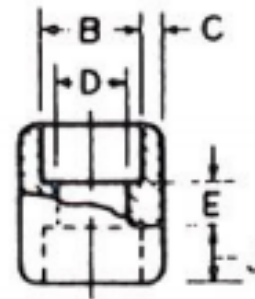

**MERIT
BRASS**

DIRECTING THE FLOW OF *Quality*

DIMENSIONAL SPECIFICATIONS

FORGED CARBON STEEL FITTINGS 3000 LB.



SOCKET WELD REDUCING COUPLING

Part #	Size (IN.)	Approx. Net WT. (LB.)	A
CSW3512-2016	1-1/4 X 1	1.08	1.77

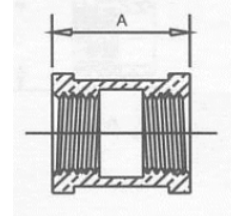

SOCKET WELD AND THREADED FULL COUPLING

Part #	Size (IN.)	Approx. Net WT. (LB.)	A
CTSW3511-08	1/2	0.29	1.29
CTSW3511-12	3/4	0.37	1.43
CTSW3511-16	1	0.64	1.68
CTSW3511-20	1-1/4	0.99	1.86
CTSW3511-24	1-1/2	1.30	1.92
CTSW3511-32	2	1.90	2.20
CTSW3511-40	2-1/2	3.09	2.88
CTSW3511-48	3	3.92	3.18
CTSW3511-64	4	6.28	3.69

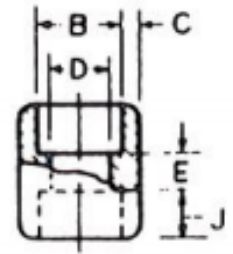

**MERIT
BRASS**

DIRECTING THE FLOW OF *Quality*

DIMENSIONAL SPECIFICATIONS

FORGED CARBON STEEL FITTINGS 3000 LB.

SOCKET WELD REDUCER INSERT

Part #	Size (IN.)	Approx. Net WT. (LB.)	A	B	C	D	K	SD	RL
CSW3580-0804	1/2 X 1/4	0.15	0.83	0.56	0.15	0.35	0.39	0.84	1.00
CSW3580-1208	3/4 X 1/2	0.40	0.87	0.86	0.18	0.63	0.39	1.05	1.00
CSW3580-1608	1 X 1/2	0.31	0.63	0.86	0.18	0.63	0.39	1.31	1.10
CSW3580-1612	1 X 3/4	0.55	0.94	1.08	0.19	0.83	0.51	1.31	1.10
CSW3580-2008	1-1/4 X 1/2	0.99	0.75	0.86	0.18	0.63	0.39	1.66	1.26
CSW3580-2012	1-1/4 X 3/4	0.99	0.71	1.08	0.19	0.83	0.51	1.66	1.26
CSW3580-2016	1-1/4 X 1	0.99	0.98	1.34	0.22	1.04	0.51	1.66	1.26
CSW3580-2408	1-1/2 X 1/2	0.90	0.83	0.86	0.18	0.63	0.39	1.90	1.30
CSW3580-2412	1-1/2 X 3/4	1.23	0.75	1.08	0.19	0.83	0.51	1.90	1.30
CSW3580-2416	1-1/2 X 1	1.23	0.71	1.34	0.22	1.04	0.51	1.90	1.30
CSW3580-2420	1-1/2 X 1-1/4	1.23	1.10	1.69	0.24	1.38	0.51	1.90	1.30
CSW3580-3208	2 X 1/2	1.98	0.98	0.86	0.18	0.63	0.39	2.37	1.50
CSW3580-3212	2 X 3/4	1.98	0.94	1.08	0.19	0.83	0.51	2.37	1.50
CSW3580-3216	2 X 1	1.98	0.87	1.34	0.22	1.04	0.51	2.37	1.50
CSW3580-3220	2 X 1-1/4	1.12	0.83	1.69	0.24	1.38	0.51	2.37	1.50
CSW3580-3224	2 X 1-1/2	1.98	1.26	1.93	0.25	1.61	0.51	2.37	1.50

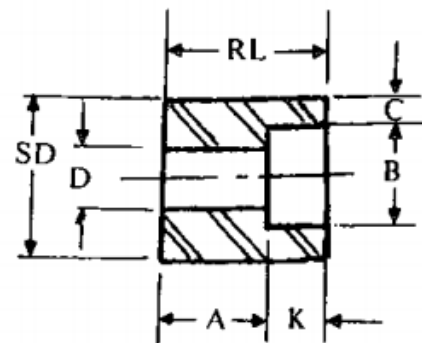

MERIT BRASS

DIRECTING THE FLOW OF *Quality*

DIMENSIONAL SPECIFICATIONS

FORGED CARBON STEEL FITTINGS 3000 LB.

SOCKET WELD CAP

Part #	Size (IN.)	Approx. Net WT. (LB.)	B	C	J	K
CSW3516-02	1/8	0.09	0.43	0.13	0.38	0.19
CSW3516-04	1/4	0.09	0.57	0.15	0.38	0.19
CSW3516-06	3/8	0.15	0.70	0.16	0.38	0.19
CSW3516-08	1/2	0.22	0.87	0.18	0.38	0.25
CSW3516-12	3/4	0.35	1.08	0.19	0.50	0.25
CSW3516-16	1	0.55	1.34	0.22	0.50	0.38
CSW3516-20	1-1/4	0.99	1.69	0.24	0.50	0.38
CSW3516-24	1-1/2	1.30	1.93	0.25	0.50	0.44
CSW3516-32	2	2.12	2.42	0.27	0.62	0.50
CSW3516-40	2-1/2	3.15	2.92	0.35	0.62	0.62
CSW3516-48	3	6.04	3.55	0.38	0.62	0.75
CSW3516-64	4	9.35	4.56	0.42	0.62	0.88

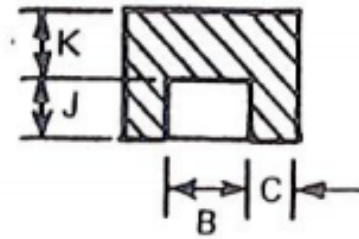

MERIT
BRASS

DIRECTING THE FLOW OF *Quality*

DIMENSIONAL SPECIFICATIONS

FORGED CARBON STEEL FITTINGS 3000 LB.

SOCKET WELD UNION

Part #	Size (IN.)	Approx. Net WT. (LB.)	A	C	D	F	G	J	L	N
CSW3587-02	1/8	0.62	0.86	0.12	0.26	0.12	0.12	0.05	1.63	1.93
CSW3587-04	1/4	0.62	0.86	0.13	0.38	0.12	0.12	0.05	1.63	1.93
CSW3587-06	3/8	0.55	1.02	0.14	0.54	0.14	0.14	0.05	1.81	2.17
CSW3587-08	1/2	1.08	1.23	0.16	0.68	0.14	0.14	0.06	1.93	2.24
CSW3587-12	3/4	1.08	1.46	0.17	0.85	0.16	0.16	0.07	2.24	2.64
CSW3587-16	1	1.68	1.79	0.20	1.10	0.18	0.17	0.07	2.44	3.11
CSW3587-20	1-1/4	2.42	2.16	0.21	1.40	0.21	0.21	0.08	2.80	3.70
CSW3587-24	1-1/2	3.55	2.42	0.22	1.63	0.23	0.22	0.09	3.01	4.37
CSW3587-32	2	4.76	2.96	0.24	2.06	0.26	0.25	0.11	3.39	5.20
CSW3587-48	3	11.35	4.30	0.33	3.05	0.32	0.31	0.14	4.29	6.89
CSW3587-64	4	25.55	5.59	0.36	4.03	0.33	0.32	0.15	4.98	7.50

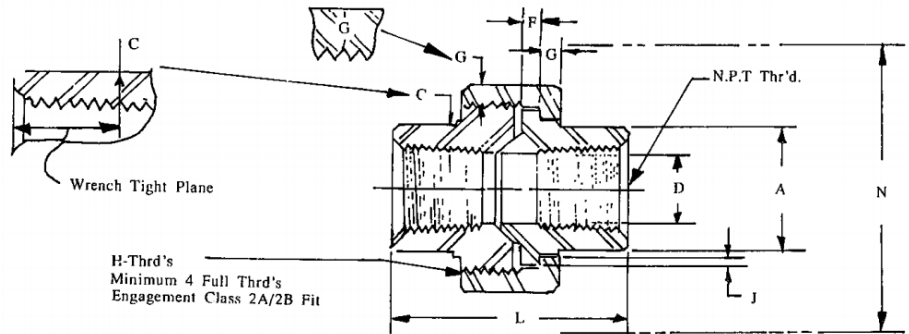

MERIT BRASS

DIRECTING THE FLOW OF *Quality*

DIMENSIONAL SPECIFICATIONS

FORGED CARBON STEEL WELD-ON OUTLETS

THREAD OUTLET 3000 LB.

Part #	Size (IN.)	Approx. Net WT. (LB.)	A	B	C	F	T
C3590-08	1/2 X 3/4 THRU 36	0.33	1.00	1.38	0.94	1.25	0.21
C3590-12	3/4 X 1 THRU 36	0.44	1.06	1.75	1.19	1.44	0.19
C3590-16	1 X 2 THRU 36	0.81	1.31	2.13	1.44	1.81	0.25
C3590-20A	1-1/4 X 2 THRU 3	0.92	1.31	2.56	1.75	2.19	0.26
C3590-20B	1-1/4 X 3-1/2 THRU 36	0.92	1.31	2.56	1.75	2.19	0.26
C3590-24A	1-1/2 X 2-1/2 THRU 4	1.41	1.38	2.88	2.00	2.44	0.27
C3590-24B	1-1/2 X 5 THRU 36	1.41	1.38	2.88	2.00	2.44	0.27
C3590-32A	2 X 4 THRU 6	2.33	1.50	3.50	2.56	2.94	0.28
C3590-32B	2 X 8 THRU 36	2.33	1.50	3.50	2.56	2.94	0.28
C3590-40A	2-1/2 X 3-1/2 THRU 4	2.99	1.81	4.06	3.00	3.44	0.28
C3590-40B	2-1/2 X 5 THRU 8	2.99	1.81	4.06	3.00	3.44	0.28
C3590-40C	2-1/2 X 10 THRU 36	2.99	1.81	4.06	3.00	3.44	0.28
C3590-48A	3 X 5	4.55	2.00	4.81	3.69	4.13	0.34
C3590-48B	3 X 6	4.55	2.00	4.81	3.69	4.13	0.34
C3590-48C	3 X 8 THRU 12	4.55	2.00	4.81	3.69	4.13	0.34
C3590-48D	3 X 14 THRU 36	4.55	2.00	4.81	3.69	4.13	0.34
C3590-64A	4 X 8	7.11	2.25	6.00	4.75	5.13	0.31
C3590-64B	4 X 10	7.11	2.25	6.00	4.75	5.13	0.31
C3590-64C	4 X 12 THRU 16	7.11	2.25	6.00	4.75	5.13	0.31
C3590-64D	4 X 18 THRU 36	7.11	2.25	6.00	4.75	5.13	0.31

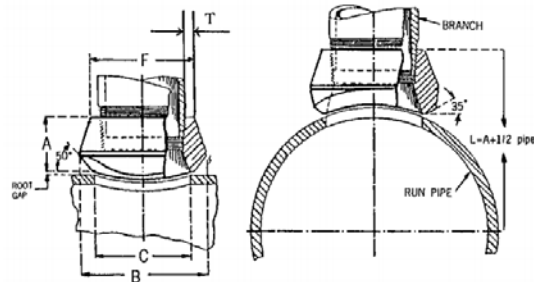

MERIT BRASS

DIRECTING THE FLOW OF *Quality*

DIMENSIONAL SPECIFICATIONS

FORGED CARBON STEEL WELD-ON OUTLETS]

SOCKET WELD OUTLET 3000 LB.

Part #	Size (IN.)	Approx. Net WT. (LB.)	A	B	C	D	E	F	G	H
CSW3590-08	1/2 X 3/4 THRU 36	0.33	1.00	1.38	0.94	0.62	0.86	1.25	0.44	0.20
CSW3590-12	3/4 X 1 THRU 36	0.44	1.06	1.75	1.19	0.82	1.07	1.44	0.50	0.19
CSW3590-16	1 X 2 THRU 36	0.81	1.31	2.13	1.44	1.05	1.33	1.81	0.53	0.25
CSW3590-20A	1-1/4 X 2 THRU 3	0.92	1.31	2.56	1.75	1.38	1.68	2.19	0.59	0.25
CSW3590-20B	1-1/4 X 3-1/2 THRU 36	0.92	1.31	2.56	1.75	1.38	1.68	2.19	0.59	0.25
CSW3590-24A	1-1/2 X 2-1/2 THRU 4	1.41	1.38	2.88	2.00	1.61	1.92	2.44	0.63	0.23
CSW3590-24B	1-1/2 X 5 THRU 36	1.41	1.38	2.88	2.00	1.61	1.92	2.44	0.63	0.23
CSW3590-32A	2 X 4 THRU 6	2.33	1.50	3.50	2.56	2.07	2.41	2.94	0.69	0.27
CSW3590-32B	2 X 8 THRU 36	2.33	1.50	3.50	2.56	2.07	2.41	2.94	0.69	0.27
CSW3590-40A	2-1/2 X 3-1/2 THRU 4	2.99	1.81	4.06	3.00	2.47	2.91	3.44	0.94	0.30
CSW3590-40B	2-1/2 X 5 THRU 8	2.99	1.81	4.06	3.00	2.47	2.91	3.44	0.94	0.30
CSW3590-40C	2-1/2 X 10 THRU 36	2.99	1.81	4.06	3.00	2.47	2.91	3.44	0.94	0.30
CSW3590-48A	3 X 5	4.55	2.00	4.81	3.69	3.07	3.53	4.13	1.13	0.30
CSW3590-48B	3 X 6	4.55	2.00	4.81	3.69	3.07	3.53	4.13	1.13	0.30
CSW3590-48C	3 X 8 THRU 12	4.55	2.00	4.81	3.69	3.07	3.53	4.13	1.13	0.30
CSW3590-48D	3 X 14 THRU 36	4.55	2.00	4.81	3.69	3.07	3.53	4.13	1.13	0.30
CSW3590-64A	4 X 8	7.11	2.13	5.25	4.00	3.55	4.04	4.81	1.13	0.30
CSW3590-64B	4 X 10	7.11	2.13	5.25	4.00	3.55	4.04	4.81	1.13	0.30
CSW3590-64C	4 X 12 THRU 16	7.11	2.13	5.25	4.00	3.55	4.04	4.81	1.13	0.30
CSW3590-64D	4 X 18 THRU 36	7.11	2.13	5.25	4.00	3.55	4.04	4.81	1.13	0.30

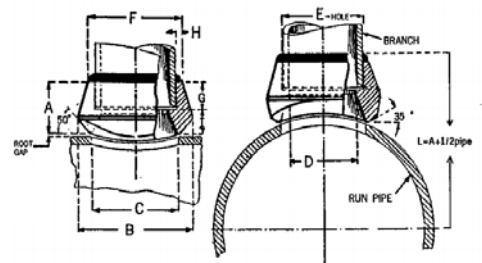

MERIT BRASS

DIRECTING THE FLOW OF *Quality*

DIMENSIONAL SPECIFICATIONS

FORGED CARBON STEEL WELD-ON OUTLETS

BUTTWELD OUTLET 3000 LB.

Part #	Size (IN.)	Approx. Net WT. (LB.)	A	B	C	T
C04490-08	1/2 X 3/4 THRU 36	0.33	0.75	1.38	0.94	0.13
C04490-12	3/4 X 1 THRU 36	0.44	0.88	1.75	1.19	0.13
C04490-16	1 X 2 THRU 36	0.81	1.06	2.13	1.44	0.13
C04490-20A	1-1/4 X 2 THRU 3	0.92	1.25	2.56	1.75	0.14
C04490-20B	1-1/4 X 3-1/2 THRU 36	0.92	1.25	2.56	1.75	0.14
C04490-24A	1-1/2 X 2-1/2 THRU 4	1.41	1.31	2.88	2.00	0.15
C04490-24B	1-1/2 X 5 THRU 36	1.41	1.31	2.88	2.00	0.15
C04490-32A	2 X 4 THRU 6	2.33	1.50	3.50	2.56	0.15
C04490-32B	2 X 8 THRU 36	2.33	1.50	3.50	2.56	0.15
C04490-40A	2-1/2 X 3-1/2 THRU 4	2.99	1.63	4.17	3.00	0.20
C04490-40B	2-1/2 X 5 THRU 8	2.99	1.63	4.17	3.00	0.20
C04490-40C	2-1/2 X 10 THRU 36	2.99	1.63	4.17	3.00	0.20
C04490-48A	3 X 5	4.55	1.75	4.81	3.69	0.22
C04490-48B	3 X 6	4.55	1.75	4.81	3.69	0.22
C04490-48C	3 X 8 THRU 12	4.55	1.75	4.81	3.69	0.22
C04490-48D	3 X 14 THRU 36	4.55	1.75	4.81	3.69	0.22
C04490-64A	4 X 8	7.11	2.00	6.00	4.75	0.24
C04490-64B	4 X 10	7.11	2.00	6.00	4.75	0.24
C04490-64C	4 X 12 THRU 16	7.11	2.00	6.00	4.75	0.24
C04490-64D	4 X 18 THRU 36	7.11	2.00	6.00	4.75	0.24

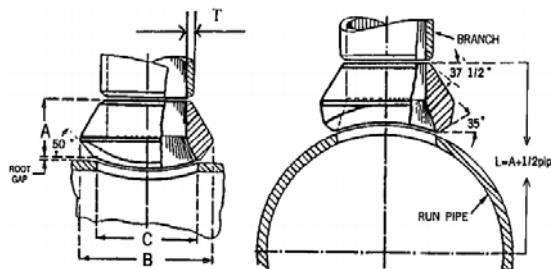

MERIT BRASS

DIRECTING THE FLOW OF *Quality*