

DIMENSIONAL SPECIFICATIONS

DUCTILE IRON FLANGES

DUCTILE IRON BACKUP FLANGE

Part #	Size (IN.)	Approx. Net WT. (LB.)	BC	ID	OD	T	# Bolts
ADI-08	1/2	0.95	2.38	0.09	3.50	0.44	4
ADI-12	3/4	1.45	2.75	1.11	3.88	0.50	4
ADI-16	1	1.60	3.13	1.38	4.25	0.50	4
ADI-20	1-1/4	1.82	3.50	1.72	4.63	0.50	4
ADI-24	1-1/2	2.15	3.88	1.87	5.00	0.50	4
ADI-32	2	3.00	4.75	2.44	6.00	0.50	4
ADI-40	2-1/2	4.15	5.50	2.94	7.00	0.50	4
ADI-48	3	4.00	8.00	3.56	7.50	0.50	4
ADI-64	4	6.78	7.50	4.56	9.00	0.56	8
ADI-96	6	9.42	9.50	6.75	11.00	0.63	8
ADI-128	8	11.90	11.75	8.75	13.50	0.63	8
ADI-160	10	16.95	14.25	10.88	16.00	0.63	12
ADI-192	12	26.43	17.00	12.88	19.00	0.75	12

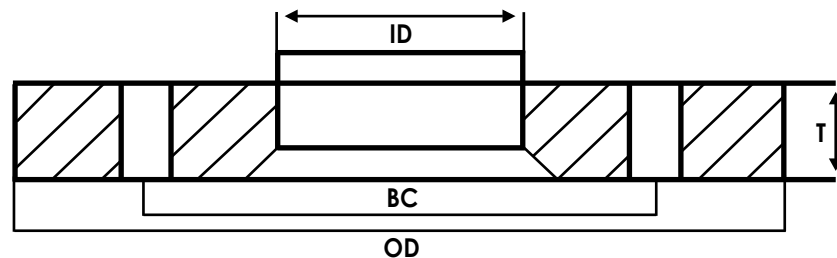

**MERIT
BRASS**

DIRECTING THE FLOW OF *Quality*

DIMENSIONAL SPECIFICATIONS

DUCTILE IRON FLANGES

GALVANIZED DUCTILE IRON BACKUP FLANGE

Part #	Size (IN.)	Approx. Net WT. (LB.)	BC	ID	OD	T	# Bolts
AGDI-16	1	1.60	3.13	1.38	4.25	0.50	4
AGDI-20	1-1/4	1.82	3.50	1.72	4.63	0.50	4
AGDI-24	1-1/2	2.15	3.88	1.87	5.00	0.50	4
AGDI-32	2	3.00	4.75	2.44	6.00	0.50	4
AGDI-40	2-1/2	4.00	5.50	2.94	7.00	0.50	4
AGDI-48	3	4.00	8.00	3.56	7.50	0.50	4
AGDI-64	4	6.78	7.50	4.56	9.00	0.56	8
AGDI-80	5	7.28	8.50	5.62	10.00	0.63	8
AGDI-96	6	9.42	9.50	6.75	11.00	0.63	8
AGDI-128	8	11.90	11.75	8.75	13.50	0.63	8
AGDI-160	10	16.96	14.25	10.88	16.00	0.63	12
AGDI-192	12	26.43	17.00	12.88	19.00	0.75	12

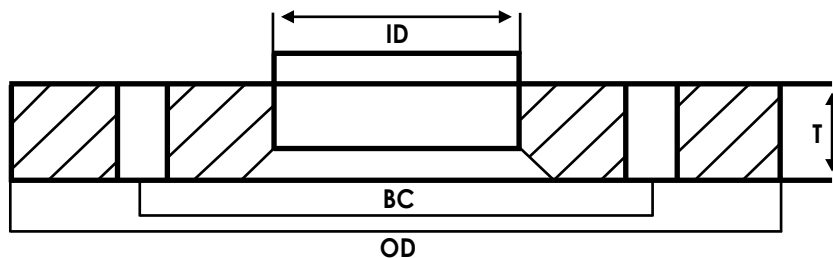

**MERIT
BRASS**

DIRECTING THE FLOW OF *Quality*