

Find us in

MasterSpec®

Powered by Deltek Specpoint®

www.meritbrass.com
www.mbwebxpress.com



CarbonPress®
By Merit Brass Co.

2023

PRODUCT CATALOG



**MERIT
BRASS**
DIRECTING THE FLOW OF *Quality*

Merit Brass Co.

One Merit Dr. • PO Box 43127
Cleveland, OH 44143

CarbonPress® is Merit Brass' solution for professionals choosing to join steel pipes through the use of press technology. **CarbonPress®** is focused on quality, safety, reliability, and ease of use.

- 1/2" — 2" including couplings, elbows, tees, adapters, coupling reducers, unions, and flange adapters.
- Extensive offering of reducing tees.
- Dual leak detection feature identify uncrimped connections:
 - » **Mechanical Leak Before Press (LBP) sealing elements.**
 - » **FIRST TO MARKET Visual Indicator Press Ring® (VIPR®)** – facilitates immediate identification of unpressed connections as well as application – green = EPDM (water) and yellow = HNBR (gas).
- Compatible with most common pressing tools and jaws in the market.
- EPDM (Ethylene Propylene Diene Monomer) and HNBR (Hydrogenated Nitrile Butadiene Rubber) seals are factory-installed & lubricated.
- Packaged in common industry quantities.
- Box, bag and ring are color-coded to the sealing element.
- **Most comprehensive package with over 400 SKUs.**



Merit Brass reserves the right to change any portion of the information shown in this product catalog without obligation to change **CarbonPress®** products previously or subsequently sold.

See meritbrass.com for most current information.

TABLE OF CONTENTS

Why CarbonPress[®] Fittings?	3
Features & Benefits	4
System Data	5
Tooling Reference Guide	5
Approved Applications	6
Sealing Elements	6
Dimensional Data	7
Coupling With Stop	7
Coupling No Stop	7
Extended Coupling No Stop	7
Reducing Coupling	8
Bushing Reducer	8
Reducing Tee	9
Equal Tee	9
90° Street Elbow	10
90° Elbow	10
45° Elbow	10
45° Street Elbow	11
Male Adapter	11
Cap	11
Female Adapter	12
Union	12
Female Reducing Tee	13
Female Union	13
Flange Adapter	14
Installation Instructions	15
Limited Warranty	16
Notes	17



WHY CARBONPRESS® FITTINGS?

CarbonPress® is a ½"- 2" carbon steel press fitting system suitable for use on black iron, epoxy coated, and galvanized schedule 10 to 40 carbon steel pipe.

When pressed, a grab ring deforms and its sharp edges grip the outside diameter of the pipe, securing the fitting axially and preventing movement. At the same time an elastomeric sealing element impinges on the pipe, creating a leak tight seal. Press technology has a multi-decade history of successful use in applications including hydronic heating and fire sprinkler systems and the conveyance of fluids, gases, oils, and low pressure steam.

FEATURES & BENEFITS

15-year limited warranty on our CarbonPress[®] offering.

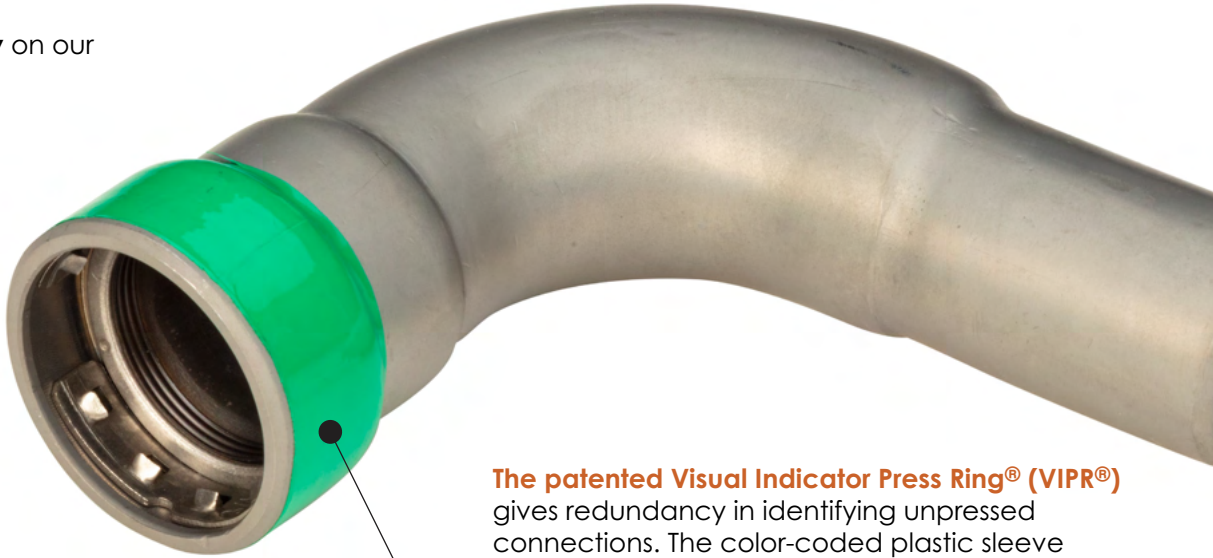

The patented Visual Indicator Press Ring[®] (VIPR[®]) gives redundancy in identifying unpressed connections. The color-coded plastic sleeve can be easily removed when the connection is pressed, and also indicates the sealing element material preventing costly and potentially unsafe installation errors.

Most Comprehensive Package with over 400 SKUs

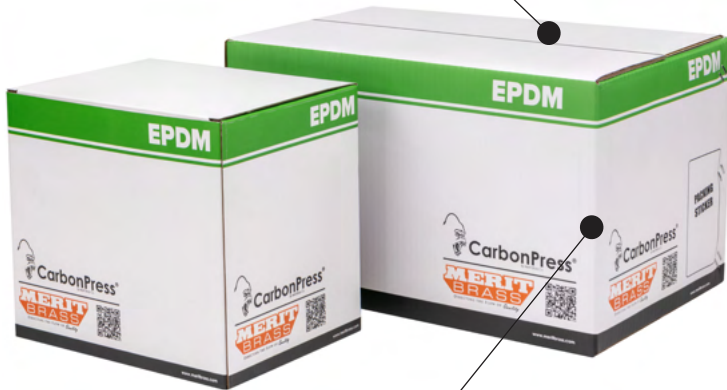

Box, bag and ring are color-coordinated to the sealing element for ease of receipt and identification.

Grab Ring deforms and grips outside diameter of pipe

Corrosion resistant Zn-Ni plating ensures years of trouble-free service.



Engineered sealing elements are designed to leak before they are pressed, giving a visual indication of a connection that has not been pressed.

SYSTEM DATA

CarbonPress® Codes and Standards

- ASME B31.1 Power Piping
- ASME B31.3 Process Piping
- ASME B31.9 Building Service Piping
- CSA B149.1 Natural Gas and Propane Installation Code
- IAPMO Uniform Mechanical Code (UMC)
- IAPMO Uniform Plumbing Code (UPC)

CarbonPress® Certifications

- IAPMO Z 1117 (EPDM)
- IAPMO/ANSI LC 4/CSA 6.32 (HNBR)

CarbonPress® Temperature & Pressure

- **EPDM:** Temperature Range from -40°F to 300°F (-40°C to 148°C). Working pressure range from full vacuum to 250 psi (17.2 bar) for water
- **HNBR:** Temperature Range from -40°F to 200°F (-40°C to 93°C). Working pressure range from full vacuum to 125 psi (8.6 bar) for gas
- **Surface Protection:** Corrosion Resistant Zn-Ni Plating

TOOLING REFERENCE GUIDE

CarbonPress® fittings can be pressed with Milwaukee or Ridgid tools and associated jaws/rings for carbon steel applications. Below is a table of Milwaukee and Ridgid's part numbers for your reference.



CarbonPress® Tools, Kits, Jaws and Rings

Size	Milwaukee Part #	Tooling Name	Adapter	Ridgid Part #	Tooling Name	Adapter	Profile
0.5" - 2"	2773-20	M18 Force Logic Press Tool		67063	RP 350 Press Tool		
0.5" - 1"	49-16-2696	M18 Black Iron Press Kit (0.5" - 1")		48558	Press Jaw Kit (0.5" - 1")		
0.5" - 2"	49-16-2697	M18 Black Iron Press Kit (0.5" - 2")		48553	Press Jaw Kit (0.5" - 2")		
2.5" - 4"	2773-20L	M18 Force Logic Long Throw Press Tool		60658	Press Booster		
0.5"	49-16-2650B	0.5" M18 Black Iron Press Jaw		37958	0.5" Press Jaw		IPS - Grab Ring
0.75"	49-16-2651B	0.75" M18 Black Iron Press Jaw		37963	0.75" Press Jaw		IPS - Grab Ring
1"	49-16-2652B	1" M18 Black Iron Press Jaw		37968	1" Press Jaw		IPS - Grab Ring
1.25"	49-16-2653B	1.25" M18 Black Iron Press Ring	49-16-2659	37973	1.25" Press Ring	21878	IPS - Grab Ring
1.5"	49-16-2654B	1.5" M18 Black Iron Press Ring	49-16-2659	37978	1.5" Press Ring	21878	IPS - Grab Ring
2"	49-16-2655B	2" M18 Black Iron Press Ring	49-16-2659	37983	2" Press Ring	21878	IPS - Grab Ring
2.5"	49-16-2656B	2.5" M18 Black Iron Press Ring	49-16-2659	60643	2.5" Press Ring	Press Booster	IPS - Grab Ring
3"	49-16-2657B	3" M18 Black Iron Press Ring	49-16-2659	60648	3" Press Ring	Press Booster	IPS - Grab Ring
4"	49-16-2658B	4" M18 Black Iron Press Ring	49-16-2659	64653	4" Press Ring	Press Booster	IPS - Grab Ring
1.25" - 2"	49-16-2659	Ring Jaw 1		21878	V2 Press Ring Actuator		
2.5" - 4"	49-16-2659S	Ring Jaw 2					
2.5" - 4"	49-16-2698	M18 Black Iron Press Kit XL (2.5" - 4")		60638	Press Booster with Press Rings (2.5" - 4")		



Note: CarbonPress®, by Merit Brass Co. products can be used with Milwaukee, REMS, Ridgid, and Rothenberger tools with the associated Jaws for Carbon Steel/Black Iron Pipe. Please contact Merit Brass Co. for additional information.

APPROVED APPLICATIONS

TYPES OF SERVICE		SYSTEM OPERATING CONDITIONS			CARBONPRESS [®] SEALS	
		NOTES	PRESSURE	TEMPERATURE	EPDM (WATER)	HNBR (GAS)
FLUIDS/ WATER	Chilled Water	Low-Pressure System Steam	230 psi	Min. -40°F	✓	
	Hydronic Heating	Ethylene Glycol, Propylene Glycol	230 psi	300°F	✓	
	Low-Pressure System Steam		15 psi max.	300°F	✓	
GASES	Argon		230 psi	Max. 140°F	✓	✓
	Carbon Dioxide		230 psi	Max. 140°F	✓	✓
	Compressed Air	Oil Concentrate <25mg/m3	230 psi	Max. 140°F	✓	✓
		Oil Concentrate >25mg/m3	230 psi	Max. 140°F		✓
	Natural Gas, LP Gas -40°F to 180°F and Fuel Oil		125 psi max.	-40°F to 180°F		✓
	Nitrogen		230 psi	Max. 140°F	✓	✓
Vacuum		29.2 in Hg max.	Max. 140°F			
OIL & LUBRICANTS	Diesel Fuel	Compliant with NFPA 30 & 30A	125 psi			✓
	Engine Oil		150 psi	Ambient		✓
	Heating Fuel Oil		125 psi	-40°F to 180°F		✓
	Hydraulic Fluid	Mineral Based	230 psi	Ambient		✓
	Transmission Fluid		230 psi	Ambient		✓

Contact Merit Brass for additional information regarding applications not listed above.

SEALING ELEMENTS

EPDM SEALING ELEMENT		
EPDM	Ethylene-propylene-diene monomer	
Color	Black	
Temperature	-40°F to 300°F (-40°C to 148°C)	
Common Applications	Hydronic Heating	
	Chilled Water	
	Oil Free Air	
Manufacturing Process	Synthetically manufactured & peroxide-cured	
Benefits of Sealing Element	Excellent oxidation resistance	
HNBR SEALING ELEMENT		
HNBR	Hydrogenated Nitrile Butadiene Rubber	
Color	Yellow	
Temperature	-40°F to 200°F (-40°C to 93°C)	
Common Applications	Fuel Gas Applications	
	Petroleum-based products and lubricants	
	Salt solutions	
Manufacturing Process	Synthetically manufactured and peroxide-cured	
Benefits of Sealing Element	Excellent resilience and tear resistance	

DIMENSIONAL DATA

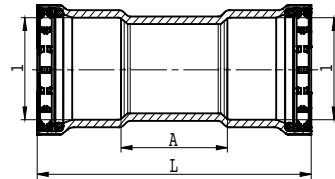

Coupling with Stop				P x P	
Item Number		Nominal Size 1	A (in)	L (in)	
EPDM	HNBR				
MB90000	MB90001	1/2"	0.79	2.83	
MB90005	MB90006	3/4"	0.87	3.23	
MB90010	MB90011	1"	0.87	3.58	
MB90015	MB90016	1 1/4"	1.12	4.72	
MB90020	MB90021	1 1/2"	1.18	4.88	
MB90025	MB90026	2"	1.22	5.08	

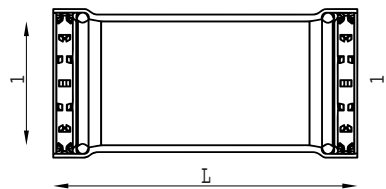

Coupling No Stop			P x P	
Item Number		Nominal Size 1	L (in)	
EPDM	HNBR			
MB90045	MB90046	1/2"	2.83	
MB90050	MB90051	3/4"	3.23	
MB90055	MB90056	1"	3.58	
MB90060	MB90061	1 1/4"	4.72	
MB90065	MB90066	1 1/2"	4.88	
MB90070	MB90071	2"	5.08	

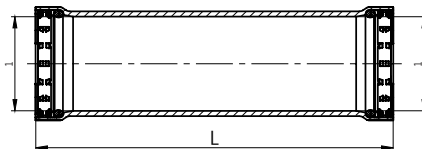

Extended Coupling No Stop			P x P	
Item Number		Nominal Size 1	L (in)	
EPDM	HNBR			
MB90090	MB90091	1/2"	3.82	
MB90095	MB90096	3/4"	3.98	
MB90100	MB90101	1"	4.37	
MB90105	MB90106	1 1/4"	5.31	
MB90110	MB90111	1 1/2"	5.43	
MB90115	MB90116	2"	5.63	

DIMENSIONAL DATA

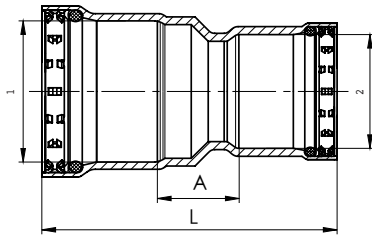

Reducing Coupling				P x P	
Item Number		Nominal Size		A (in)	L (in)
EPDM	HNBR	Size 1	Size 2		
MB90120	MB90121	¾"	½"	1.10	3.01
MB90125	MB90126	1"	½"	1.04	3.44
MB90130	MB90131	1"	¾"	1.24	3.78
MB90135	MB90136	1¼"	¾"	1.32	4.25
MB90140	MB90141	1¼"	1"	0.85	4.15
MB90137	MB90139	1½"	¾"	1.54	4.57
MB90142	MB90143	1½"	1"	1.22	4.43
MB90145	MB90146	1½"	1¼"	0.96	4.72
MB90147	MB90148	2"	1"	1.56	4.84
MB90150	MB90151	2"	1¼"	1.83	5.31
MB90155	MB90156	2"	1½"	1.95	5.24

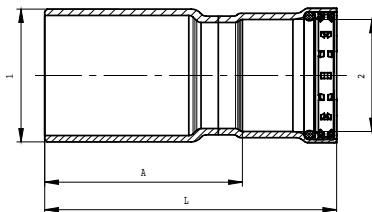

Bushing Reducer				FTG x P	
Item Number		Nominal Size		A (in)	L (in)
EPDM	HNBR	Size 1	Size 2		
MB90160	MB90161	¾"	½"	1.99	3.01
MB90165	MB90166	1"	½"	2.32	3.37
MB90170	MB90171	1"	¾"	2.26	3.50
MB90172	MB90173	1¼"	¾"	2.91	4.09
MB90175	MB90176	1¼"	1"	2.74	4.09
MB90180	MB90181	1½"	¾"	3.27	4.45
MB90185	MB90186	1½"	1"	2.87	4.25
MB90190	MB90191	1½"	1¼"	2.93	4.72
MB90195	MB90196	2"	1"	3.35	4.72
MB90200	MB90201	2"	1¼"	3.39	5.18
MB90205	MB90206	2"	1½"	3.33	5.16

DIMENSIONAL DATA

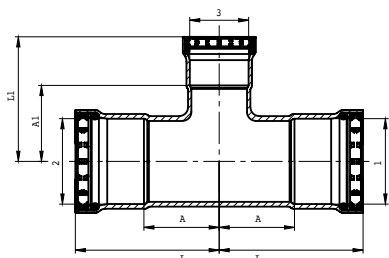

Reducing Tee						P x P x P			
Item Number		Nominal Size			A (in)	A1 (in)	L (in)	L1 (in)	
EPDM	HNBR	Size 1	Size 2	Size 3					
MB90300	MB90301	3/4"	3/4"	1/2"	1.02	0.96	2.20	2.01	
MB90305	MB90306	1"	1"	1/2"	1.18	1.12	2.54	2.17	
MB90310	MB90311	1"	1"	3/4"	1.18	1.18	2.54	2.36	
MB90315	MB90316	1 1/4"	1 1/4"	1/2"	1.48	1.30	3.29	2.34	
MB90320	MB90321	1 1/4"	1 1/4"	3/4"	1.48	1.36	3.29	2.54	
MB90325	MB90326	1 1/4"	1 1/4"	1"	1.48	1.36	3.46	2.72	
MB90330	MB90331	1 1/2"	1 1/2"	1/2"	1.61	1.40	3.46	2.44	
MB90335	MB90336	1 1/2"	1 1/2"	3/4"	1.61	1.46	3.46	2.64	
MB90340	MB90341	1 1/2"	1 1/2"	1"	1.61	1.46	3.46	2.81	
MB90345	MB90346	1 1/2"	1 1/2"	1 1/4"	1.61	1.59	3.86	3.39	
MB90350	MB90351	2"	2"	1/2"	1.93	1.69	3.86	2.74	
MB90355	MB90356	2"	2"	3/4"	1.93	1.75	3.86	2.93	
MB90360	MB90361	2"	2"	1"	1.93	1.75	3.86	3.11	
MB90365	MB90366	2"	2"	1 1/4"	1.93	1.89	3.86	3.68	
MB90370	MB90371	2"	2"	1 1/2"	1.93	1.91	3.86	3.76	

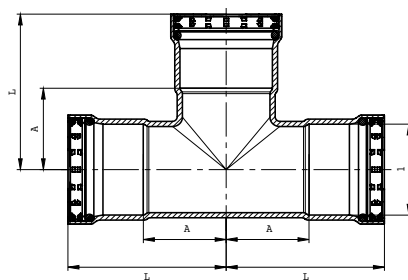

Equal Tee			P x P x P	
Item Number		Nominal Size 1	A (in)	L (in)
EPDM	HNBR			
MB90270	MB90271	1/2"	0.89	1.91
MB90275	MB90276	3/4"	1.02	2.20
MB90280	MB90281	1"	1.18	2.54
MB90285	MB90286	1 1/4"	1.48	3.29
MB90290	MB90291	1 1/2"	1.61	3.46
MB90295	MB90296	2"	1.93	3.86

DIMENSIONAL DATA

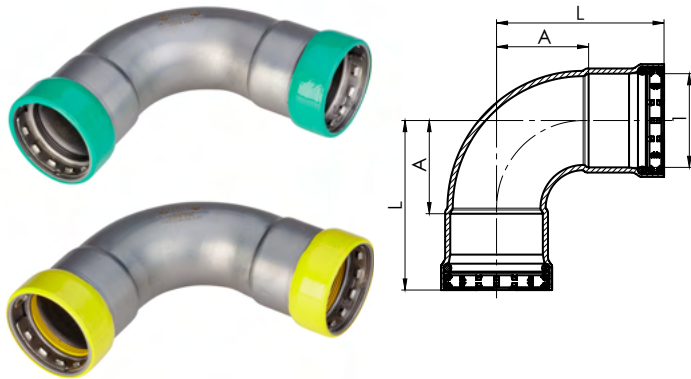

90° Elbow			P x P		
Item Number		Nominal Size 1	A (in)	L (in)	
EPDM	HNBR				
MB90450	MB90451	½"	1.56	2.58	
MB90455	MB90456	¾"	1.83	3.01	
MB90460	MB90461	1"	2.20	3.56	
MB90465	MB90466	1¼"	2.66	4.45	
MB90470	MB90471	1½"	2.93	4.76	
MB90475	MB90476	2"	3.66	5.59	

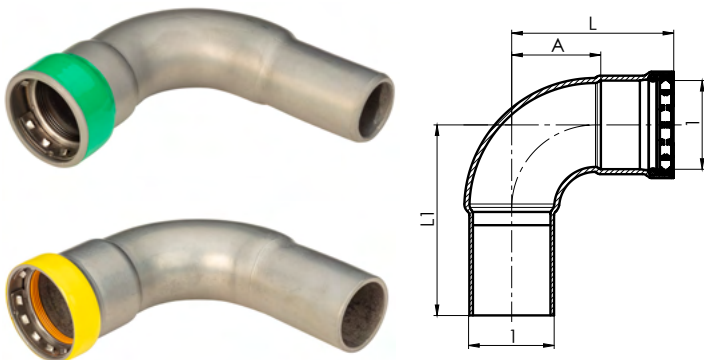

90° Street Elbow			FTG x Press		
Item Number		Nominal Size 1	A (in)	L (in)	L1 (in)
EPDM	HNBR				
MB90495	MB90496	½"	1.56	2.58	2.87
MB90500	MB90501	¾"	1.83	3.01	3.27
MB90505	MB90506	1"	2.20	3.56	3.86
MB90510	MB90511	1¼"	2.66	4.47	4.61
MB90515	MB90516	1½"	2.93	4.76	5.12
MB90520	MB90521	2"	3.66	5.59	6.08

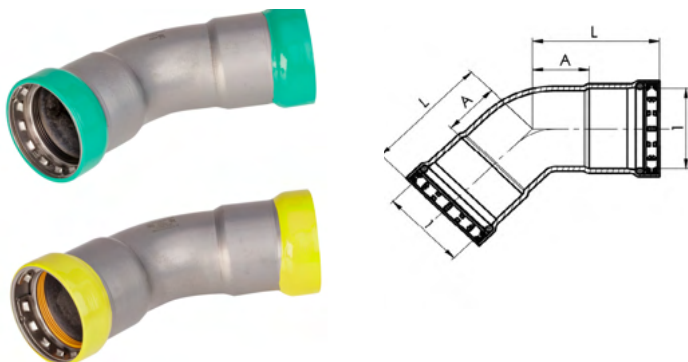

45° Elbow			P x P		
Item Number		Nominal Size 1	A (in)	L (in)	
EPDM	HNBR				
MB90540	MB90541	½"	0.87	1.89	
MB90545	MB90546	¾"	1.00	2.19	
MB90550	MB90551	1"	1.16	2.52	
MB90555	MB90556	1¼"	1.42	3.23	
MB90560	MB90561	1½"	1.56	3.41	
MB90565	MB90566	2"	1.87	3.80	

DIMENSIONAL DATA

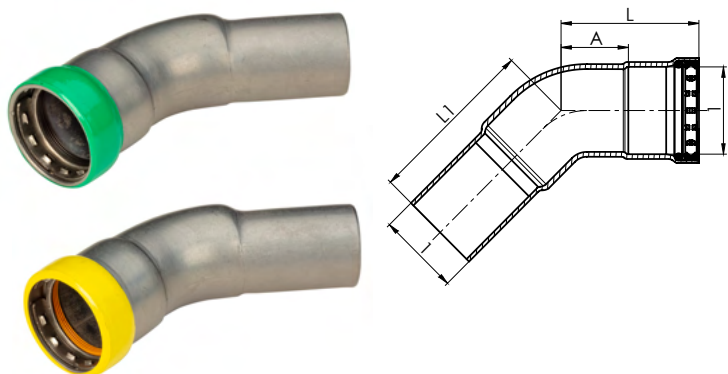

45° Street Elbow				FTG x P	
Item Number		Nominal Size 1	A (in)	L (in)	L1 (in)
EPDM	HNBR				
MB90585	MB90586	½"	1.56	1.89	2.17
MB90590	MB90591	¾"	1.83	2.19	2.42
MB90595	MB90596	1"	2.20	2.52	3.07
MB90600	MB90601	1¼"	2.66	3.23	3.43
MB90605	MB90606	1½"	2.93	3.41	3.74
MB90610	MB90611	2"	3.66	3.80	3.94

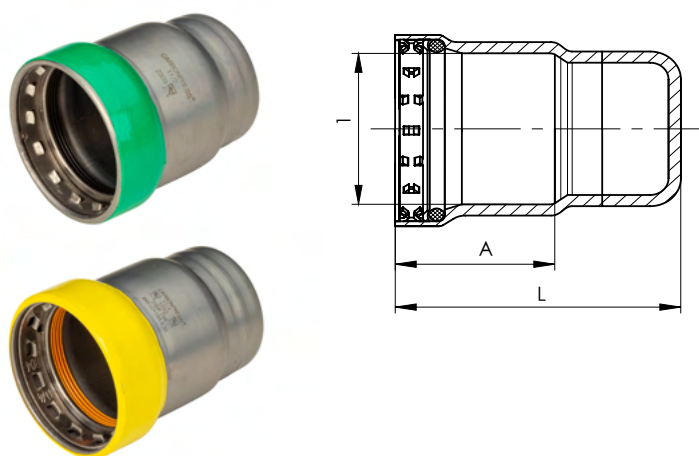

Cap				
Item Number		Nominal Size 1	A (in)	L (in)
EPDM	HNBR			
MB90630	MB90631	½"	1.02	1.81
MB90635	MB90636	¾"	1.18	2.01
MB90640	MB90641	1"	1.36	2.19
MB90645	MB90646	1¼"	1.81	2.83
MB90650	MB90651	1½"	1.85	2.91
MB90655	MB90656	2"	1.93	3.01

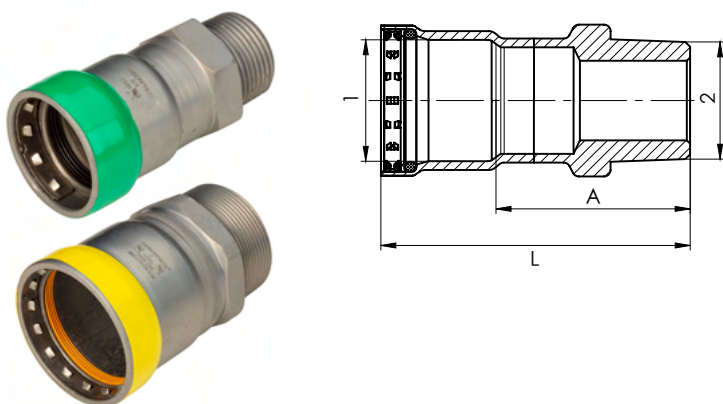

Male Adapter				P x MPT	
Item Number		Nominal Size		A (in)	L (in)
EPDM	HNBR	Size 1	Size 2		
MB90675	MB90676	½"	½"	1.63	2.68
MB90680	MB90681	¾"	¾"	1.69	2.87
MB90685	MB90686	1"	1"	1.73	3.09
MB90690	MB90691	1¼"	1¼"	2.07	3.86
MB90695	MB90696	1½"	1½"	2.24	4.09
MB90700	MB90701	2"	2"	2.40	4.33

DIMENSIONAL DATA



Female Adapter				P x FPT	
Item Number		Nominal Size		A (in)	L (in)
EPDM	HNBR	Size 1	Size 2		
MB90720	MB90721	1/2"	1/2"	0.83	2.52
MB90725	MB90726	3/4"	1/2"	0.98	2.83
MB90730	MB90731	3/4"	3/4"	0.87	2.72
MB90735	MB90736	1"	1/2"	1.46	3.48
MB90740	MB90741	1"	3/4"	1.08	3.05
MB90745	MB90746	1"	1"	0.91	3.05
MB90750	MB90751	1 1/4"	1/2"	1.67	4.13
MB90755	MB90756	1 1/4"	3/4"	1.67	4.13
MB90760	MB90761	1 1/4"	1"	1.16	3.74
MB90765	MB90766	1 1/4"	1 1/4"	0.96	3.72
MB90770	MB90771	1 1/2"	1/2"	1.69	4.21
MB90775	MB90776	1 1/2"	3/4"	1.69	4.21
MB90780	MB90781	1 1/2"	1"	1.73	4.37
MB90785	MB90786	1 1/2"	1 1/4"	1.10	3.94
MB90790	MB90791	1 1/2"	1 1/2"	1.06	3.90
MB90795	MB90796	2"	1/2"	1.71	4.31
MB90800	MB90801	2"	3/4"	1.71	4.31
MB90805	MB90806	2"	1"	1.75	4.47
MB90810	MB90811	2"	1 1/4"	1.67	4.57
MB90815	MB90816	2"	1 1/2"	1.46	4.37
MB90820	MB90821	2"	2"	1.20	4.15

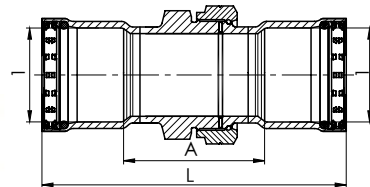

Union			P x P	
Item Number		Nominal Size 1	A (in)	L (in)
EPDM	HNBR			
MB90897	MB90919	1/2"	2.81	4.88
MB90900	MB90922	3/4"	3.03	5.43
MB90903	MB90925	1"	3.31	6.02
MB90909	MB90928	1 1/4"	4.07	7.68
MB90912	MB90931	1 1/2"	4.27	7.95
MB90915	MB90934	2"	5.41	8.90

DIMENSIONAL DATA

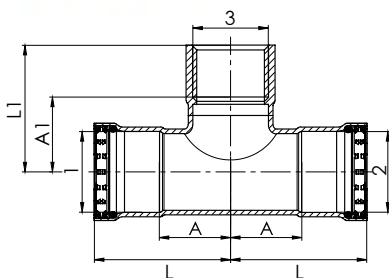

Female Reducing Tee						P x P x FPT			
Item Number		Nominal Size			A (in)	A1 (in)	L (in)	L1 (in)	
EPDM	HNBR	Size 1	Size 2	Size 3					
MB90840	MB90841	3/4"	3/4"	1/2"	1.02	1.18	2.20	1.85	
MB90843	MB90844	3/4"	3/4"	3/4"	1.02	1.18	2.20	1.85	
MB90846	MB90847	1"	1"	1/2"	1.18	1.34	2.54	2.01	
MB90849	MB90850	1"	1"	3/4"	1.18	1.34	2.54	2.01	
MB90852	MB90853	1 1/4"	1 1/4"	1/2"	1.48	1.52	3.29	2.19	
MB90855	MB90856	1 1/4"	1 1/4"	3/4"	1.48	1.52	3.29	2.19	
MB90858	MB90859	1 1/4"	1 1/4"	1"	1.48	1.56	3.29	2.34	
MB90861	MB90862	1 1/2"	1 1/2"	1/2"	1.61	1.61	3.46	2.28	
MB90864	MB90865	1 1/2"	1 1/2"	3/4"	1.61	1.61	3.46	2.28	
MB90867	MB90868	1 1/2"	1 1/2"	1"	1.61	1.65	3.46	2.44	
MB90870	MB90871	1 1/2"	1 1/2"	1 1/4"	1.61	1.57	3.46	2.54	
MB90873	MB90874	2"	2"	1/2"	1.93	1.91	3.86	2.58	
MB90876	MB90877	2"	2"	3/4"	1.93	1.91	3.86	2.58	
MB90879	MB90880	2"	2"	1"	1.93	1.95	3.86	2.74	
MB90882	MB90883	2"	2"	1 1/4"	1.93	1.87	3.86	2.83	
MB90885	MB90886	2"	2"	1 1/2"	1.93	1.95	3.86	2.93	

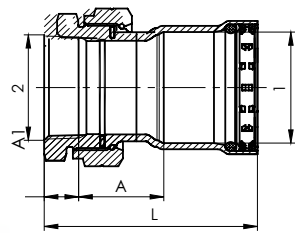

Female Union				P x FPT		
Item Number		Nominal Size		A (in)	A1 (in)	L (in)
EPDM	HNBR	Size 1	Size 2			
MB90936	MB90955	1/2"	1/2"	1.52	0.59	2.48
MB90939	MB90958	3/4"	3/4"	1.75	0.67	2.78
MB90942	MB90961	1"	1"	1.85	0.71	3.09
MB90945	MB90964	1 1/4"	1 1/4"	2.42	0.71	4.09
MB90948	MB90967	1 1/2"	1 1/2"	2.48	0.87	4.27
MB90951	MB90970	2"	2"	2.93	1.04	4.92

DIMENSIONAL DATA

Flange Adapter						P x Flange		
Item Number		Nominal Size 1	A (in)	L (in)	b (in)	K (in)	D (in)	d (in)
EPDM	HNBR							
MB90972	MB90973	½"	2.24	2.36	0.46	2.36	3.54	0.63
MB90975	MB90976	¾"	2.60	2.76	0.52	2.76	3.94	0.63
MB90978	MB90979	1"	2.95	3.11	0.58	3.11	4.33	0.63
MB90981	MB90982	1¼"	2.87	3.50	0.64	3.50	4.53	0.63
MB90984	MB90985	1½"	3.03	3.86	0.70	3.86	4.92	0.63
MB90987	MB90988	2"	3.19	4.76	0.77	4.76	5.91	0.75

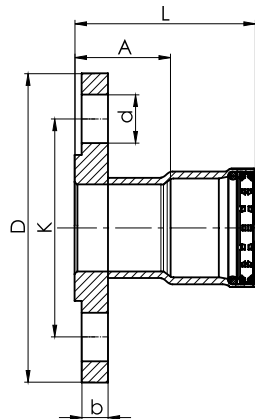

CarbonPress® is a ½"- 2" carbon steel press fitting system suitable for use on black iron, epoxy coated, and galvanized schedule 10 to 40 carbon steel pipe.

Contact Customer Service at **800.726.9800** or meritbrass.com for more information on applications not listed and applications outside the temperature and pressure range listed above.

Fluids containing hydrocarbon-based oils are not compatible with the EPDM seal.

INSTALLATION INSTRUCTIONS

WARNING: CarbonPress® fittings must be installed in accordance with this section. Always ensure that the pressing tool and its jaws are appropriate for the schedule of pipe and size of fitting. Always refer to the pressing tool manufacturer's instructions for operation and maintenance prior to use with CarbonPress® fittings. Always wear PPE such as a hardhat, gloves, and safety glasses when making press connections. Failure to follow these instructions may void the warranty and result in extensive property damage, serious injury or death.

1. Cut pipe

After selecting the correct size of pipe for the job, ensure that it is clean and free from imperfections. Once inspected, cut the pipe squarely to length using a pipe cutter, fine-toothed steel saw or an electrical mechanical saw to avoid jagged edges or scratching the pipe's surface. When cutting pipe, it must be cut all the way through. Never partially cut the pipe and break it off as it could cause leakage.



2. Deburr pipe

After the pipe is cut to length, deburr the inside and outside with a file, hand deburrer and an electrical pipe deburrer to remove debris and prevent damage to the sealing element. Once the pipe has been deburred, lightly clean the end of the pipe with a piece of sand cloth or similar material to ensure a smooth, and oil-free surface.



3. Check press fittings

In addition to checking the pipe for any imperfections, check the fitting to ensure that it is free of debris, burrs, etc., and that the sealing element is present and appropriate for the application. If the sealing element is lifted from its bead pocket, gently push it back into place being sure to not transfer dirt or debris to the sealing surface. When checking the seal for the correct fit, do not use oil and lubricants.

4. Measure & mark pipe

With a permanent marker, mark the proper insertion depth at the appropriate distance from the end of the pipe as indicated in the CarbonPress® Insertion Depth Chart.

NOTE: improper insertion depth may result in an improper seal.

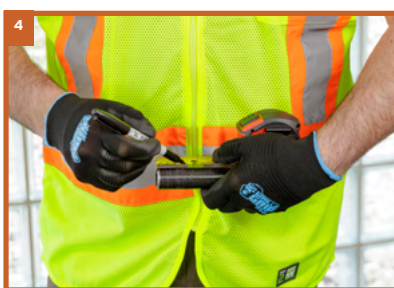

5. Insert pipe into fitting

Carefully insert the pipe into the fitting to the prescribed insertion depth. The insertion depth mark must be visible after the pipe is inserted in to the fitting to identify any movement that may occur before or after the pressing. In the instance that a fitting does not have a stop, the fitting must be centered between the pipe ends, however, the minimum pipe insertion depth must be maintained and marked.

NOTE: if the pipe is roughly or carelessly inserted into the press fitting, it may cause damage to the sealing element.



6. Verify tool & jaw

Verify that the tool and jaw being used for the application are the appropriate size for the fitting using an approved press tool from the CarbonPress® Tooling Table.



NOTE: failure to follow these instructions may void the warranty.

CarbonPress® Insertion Depth Chart

Nominal Pipe Size	Insertion Size
1/2"	1.06"
3/4"	1.19"
1"	1.38"
1-1/4"	1.81"
1-1/2"	1.88"
2"	2"

7. Position tool

Ensure jaw pressing surfaces are free from debris. Once inspected, insert the approved jaw into the pressing tool and push in, hold the pin until it locks in place.



8. Press connection

To begin the pressing process, position the tool jaws on the the raised portion at the fitting end(s) then squeeze until the trigger has engaged the sealing element or VIPR® (Visual Indicator Press Ring®). The press tool will complete a cycle then stop. Do not release the trigger until the pressing action is complete. An incomplete press may reduce the pressure retention capabilities of the joint and lead to subsequent system leakage.



9. Remove tool & Inspect press connection

Once the tool has completed a full pressing cycle, release the trigger, and remove the jaw from the fitting. Once the jaw is removed from the fitting, the VIPR® will break off, indicating a complete press.

NOTE: if the VIPR® does not instantly break off, simply remove by hand.



Leak testing

Unpressed connections can be identified prior to pressurization by the presence of the VIPR® on the bead outer diameter. The CarbonPress® sealing element is designed to physically leak while unpressed when the system is pressurized with air (45 psi max) or water (85 psi max) or per local codes, giving redundant assurance of installation integrity.



LIMITED WARRANTY



LIMITED WARRANTY FOR COPPERPRESS® FITTINGS, COPPERPRESS® VALVES, CARBONPRESS® FITTINGS AND STAINLESSPRESS® FITTINGS AND STAINLESSPRESS® VALVES.

THIS LIMITED WARRANTY GIVES YOU SPECIFIC LEGAL RIGHTS AND YOU MAY ALSO HAVE OTHER RIGHTS, WHICH VARY FROM STATE TO STATE.

THE LIMITED WARRANTY CAN ALSO BE FOUND ONLINE AT WWW.MERITBRASS.COM/WARRANTY-POLICY AND/OR IN THE DOCUMENTATION WE PROVIDE WITH THE APPLICABLE PRODUCT.

WE WARRANT THAT DURING THE WARRANTY PERIOD, THE PRODUCT WILL BE FREE FROM DEFECTS IN MATERIALS AND WORKMANSHIP AS DESCRIBED IN OUR LITERATURE.

WE LIMIT THE DURATION AND REMEDIES OF ALL IMPLIED WARRANTIES, INCLUDING WITHOUT LIMITATION THE WARRANTIES OF MERCHANTABILITY AND FITNESS FOR A PARTICULAR PURPOSE TO THE DURATION OF THIS EXPRESS LIMITED WARRANTY.

SOME STATES DO NOT ALLOW LIMITATIONS ON HOW LONG AN IMPLIED WARRANTY LASTS, SO THE ABOVE LIMITATION MAY NOT APPLY TO YOU.

OUR RESPONSIBILITY FOR DEFECTIVE GOODS IS LIMITED TO REPAIR, OR REPLACEMENT AS DESCRIBED BELOW IN THIS WARRANTY STATEMENT.

Who may use this warranty?

Merit Brass Company located at One Merit Drive, PO Box 43127 Cleveland, OH 44143 ("we") extend this limited warranty only to the consumer who originally purchased the applicable product ("you"). It does not extend to any subsequent owner or other transferee of the product.

What does this warranty cover?

This limited warranty covers defects in materials and workmanship of the: (i) CopperPress® fittings, (ii) the press valves, (iii) the Carbonpress® fittings, and (iv) the Stainlesspress® fittings exclusive of all marine applications and chemical compatibility must be verified via Merit's literature or confirmed by its Technical Department prior to installation (the "product") for the Warranty Period as defined below.

What does this warranty not cover?

This limited warranty does not cover any damage due to: (a) transportation; (b) storage; (c) improper use; (d) failure to follow the product instructions or to perform any preventive maintenance; (e) modifications; (f) unauthorized repair; (g) normal wear and tear; or (h) external causes such as

accidents, abuse, or other actions or events beyond our reasonable control.

What is the period of coverage?

This limited warranty starts on the date of your purchase and lasts for: (i) fifty (50) years for **CopperPress®** fittings, (ii) fifteen (15) years for the **Carbonpress®** fittings and the **Stainlesspress®** fittings, and (iii) five (5) years for the press valves (collectively the "**Warranty Period**"). The Warranty Period is not extended if we repair or replace the product. We may change the availability of this limited warranty at our discretion, but any changes will not be retroactive.

What are your remedies under this warranty?

With respect to any defective product during the applicable Warranty Period, we will, in our sole discretion repair or replace such product (or the defective part) free of charge. We will also pay for shipping and handling fees to return the repaired or replacement product to you.

How do you obtain warranty service?

To obtain warranty service, you must call 1-800-726-9800 or email our Warranty Claims Department at returns@meritbrass.com during the applicable Warranty Period to obtain a Return Material Authorization ("RMA") number. No warranty service will be provided without an RMA number. Upon receipt of the RMA, and at your expense, products suspected of being defective shall be returned to Merit's Warranty Claims Department at One Merit Drive, Cleveland, OH 44143. Within about six weeks of receipt, Merit will determine the cause of failure and notify the purchaser of our findings.

Limitation of liability

THE REMEDIES DESCRIBED ABOVE ARE YOUR SOLE AND EXCLUSIVE REMEDIES AND OUR ENTIRE LIABILITY FOR ANY BREACH OF THIS LIMITED WARRANTY. OUR LIABILITY SHALL UNDER NO CIRCUMSTANCES EXCEED THE ACTUAL AMOUNT PAID BY YOU FOR THE DEFECTIVE PRODUCT, NOR SHALL WE UNDER ANY CIRCUMSTANCES BE LIABLE FOR ANY CONSEQUENTIAL, INCIDENTAL, SPECIAL OR PUNITIVE DAMAGES OR LOSSES, WHETHER DIRECT OR INDIRECT AND/OR WHETHER CAUSED BY WATER, MOLD, LOSS OF EQUIPMENT, PROPERTY, REVENUE OR COST OF CAPITAL.

SOME STATES DO NOT ALLOW THE EXCLUSION OR LIMITATION OF INCIDENTAL OR CONSEQUENTIAL DAMAGES, SO THE ABOVE LIMITATION OR EXCLUSION MAY NOT APPLY TO YOU.



LOCATIONS

SPARKS DISTRIBUTION CENTER

200 Vista Boulevard Suite #106
Sparks, NV 89434

LONG BEACH PIPE DEPOT

2396 E. Artesia Blvd
Long Beach, CA 90805

DALLAS DISTRIBUTION CENTER

10614 King William Drive
Dallas, TX 75220

CLEVELAND HEADQUARTERS

One Merit Drive/PO Box 43127
Cleveland, OH 44143

BIRMINGHAM DISTRIBUTION CENTER

220 Oxmoor Court
Birmingham, AL 35209

HOUSTON DISTRIBUTION CENTER

4680 S. Sam Houston Pkwy W, Suite 120
Houston, TX 77053

CONTACT US



800.726.9800

contactus@meritbrass.com

LEARN MORE



Revised May 2023