

PVC DWV Schedule 40 Cellular Core

Conforms to ASTM F891

- Certified to the requirements of ANSI/NSF-14
- Product manufactured in plain end or with one integral solvent-weld bell per length
- Standard overall pipe length is 10 feet or 20 feet
- Standard color is white

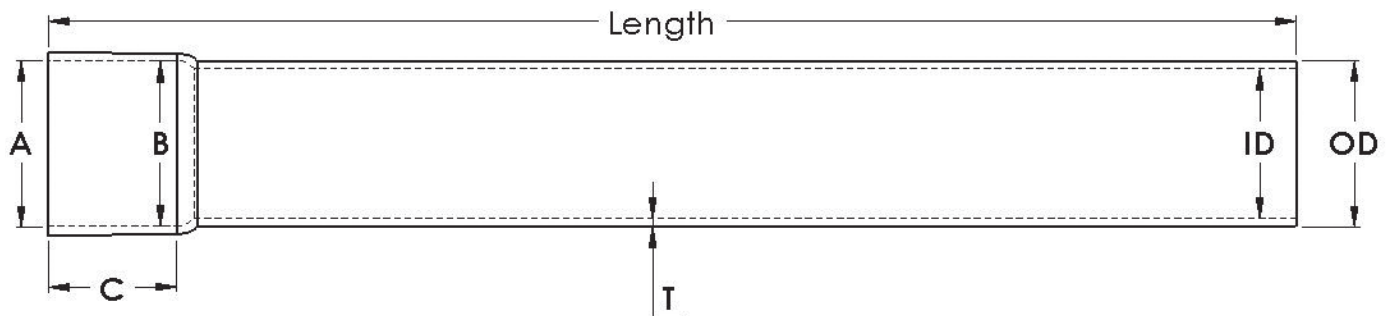

| Trade Size | 10 Foot Part Number | | 20 Foot Part Number | | Dimensions (in) | | | Bell Dimensions (in) | | | Approx Weight per 100' (lbs) | Crate Quantity (ft) | |
|------------|---------------------|-----------|---------------------|-----------|-----------------|-----------|--------------------|----------------------|-------|-------|------------------------------|---------------------|---------|
| | Bell End | Plain End | Bell End | Plain End | Avg OD | Approx ID | Min Wall Thickness | A | B | C | | 10 Foot | 20 Foot |
| 1-½ | - | 2415010P | - | 2415020P | 1.900 | 1.60 | 0.145 | - | - | - | 38 | 1,800 | 3,600 |
| 2 | - | 2420010P | - | 2420020P | 2.375 | 2.06 | 0.154 | - | - | - | 48 | 1,050 | 2,100 |
| 3 | 2430010 | 2430010P | 2430020 | 2430020P | 3.500 | 3.06 | 0.216 | 3.515 | 3.492 | 4.000 | 99 | 750 | 1,500 |
| 4 | 2440010 | 2440010P | 2440020 | 2440020P | 4.500 | 4.01 | 0.237 | 4.515 | 4.491 | 5.000 | 131 | 570 | 1,140 |
| 6 | 2460010 | 2460010P | 2460020 | 2460020P | 6.625 | 6.05 | 0.280 | 6.614 | 6.614 | 6.500 | 246 | 260 | 520 |