

9009FF

2-hole swivel plate
1-5/8" x 5-1/4"

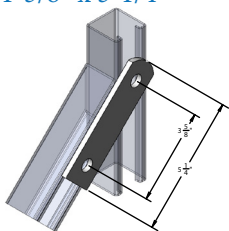

Materials/Finishes:	Zinc Plated (9009FFZ)
Thickness:	1/4"
Hole Dim:	9/16"
Wgt. each (lbs)	.48

9010FF

3-hole swivel plate
1-5/8" x 7-1/8"

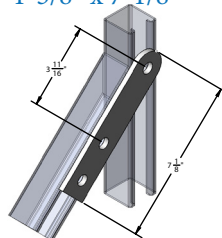

Materials/Finishes:	Zinc Plated (9010FFZ)
	T-304 Stainless (9010FFSS)
	T-316 Stainless (9010FFSX)
Thickness:	1/4"
Hole Dim:	9/16"
Wgt. each (lbs)	.69

9011FF

3-hole corner plate
3-1/2" x 3-1/2"

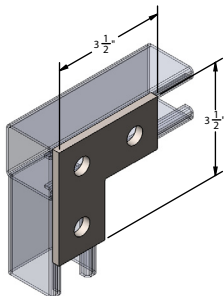

Materials/Finishes:	Zinc Plated (9011FFZ)
	T-304 Stainless (9011FFSS)
	T-316 Stainless (9011FFSX)
Thickness:	1/4"
Hole Dim:	9/16"
Wgt. each (lbs)	.56

9012FF

3-hole corner gusset
3-1/2" x 3-1/2"

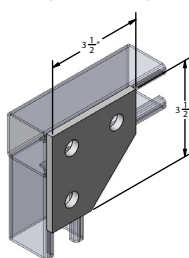

Materials/Finishes:	Zinc Plated (9012FFZ)
Thickness:	1/4"
Hole Dim:	9/16"
Wgt. each (lbs)	.70

9014FF

4-hole corner plate
3-1/2" x 5-3/8"

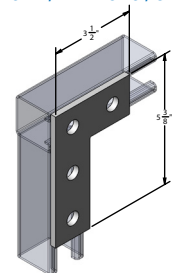

Materials/Finishes:	Zinc Plated (9014FFZ)
	T-304 Stainless (9014FFSS)
	T-316 Stainless (9014FFSX)
Thickness:	1/4"
Hole Dim:	9/16"
Wgt. each (lbs)	.75

9015FF

4-hole corner gusset
3-1/2" x 5-3/8"

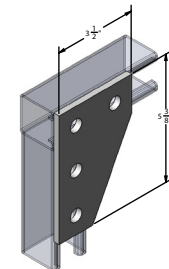

Materials/Finishes:	Zinc Plated (9015FFZ)
Thickness:	1/4"
Hole Dim:	9/16"
Wgt. each (lbs)	1.02

9020FF

5-hole corner gusset
5-3/8" x 5-3/8"

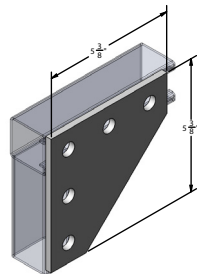

Materials/Finishes:	Zinc Plated (9020FFZ)
Thickness:	1/4"
Hole Dim:	9/16"
Wgt. each (lbs)	1.45

PROJECT INFORMATION		APPROVAL STAMP
Project:	Notes:	
Address:		
Contractor:		
Engineer:		
Date:		
Approved	Approved as Noted	Not Approved