

# tech data

## DUCTILE IRON THREADED FITTINGS



Dimensions: ANSI B16.3 CLASS 150

- Material: Ductile Iron per ASTM A536 Grade 65-45-12
- Coating: Black
- Threads: Pipe Threads, General Purpose ASME B1.20.1

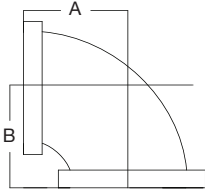

### 90 DEGREE ELBOW

Item #	Size	A	B	Weight
7110000	1"	1.5	1.5	0.62
7110001	1-1/4"	1.75	1.75	0.90
7110002	1-1/2"	1.94	1.94	1.20
7110003	2"	2.25	2.25	1.85

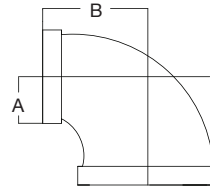

### 90 DEGREE REDUCING ELBOW

Item #	Size	A	B	Weight
7110080	1" x 1/2"	1.25	1.36	0.44
7110081	1" x 3/4"	1.37	1.45	0.52
7110082	1-1/4" x 1/2"	1.34	1.53	0.64
7110083	1-1/4" x 3/4"	1.45	1.62	0.72
7110084	1-1/4" x 1"	1.58	1.67	0.75
7110085	1-1/2" x 1"	1.65	1.80	0.92
7110086	1-1/2" x 1-1/4"	1.82	1.88	1.08
7110087	2" x 1/2"	1.49	1.88	1.08
7110088	2" x 3/4"	1.60	1.97	1.24
7110089	2" x 1"	1.73	2.02	1.40
7110090	2" x 1-1/4"	1.90	2.10	1.52
7110091	2" x 1-1/2"	2.02	2.16	1.65

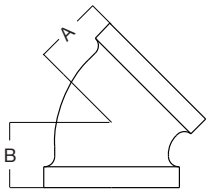

### 45 DEGREE ELBOW

Item #	Size	A	B	Weight
7110006	1"	1.12	1.12	0.48
7110007	1-1/4"	1.29	1.29	0.73
7110008	1-1/2"	1.43	1.43	0.92
7110009	2"	1.68	1.66	1.50

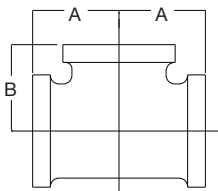

### STRAIGHT TEE

Item #	Size	A	B	Weight
7110012	1"	1.5	1.5	0.85
7110013	1-1/4"	1.75	1.75	1.22
7110014	1-1/2"	1.94	1.94	1.55
7110015	2"	2.25	2.25	1.45

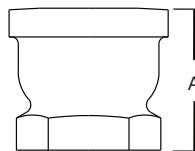

### REDUCING COUPLING

Item #	Size	A	Weight
7110022	1" x 1/2"	1.5	0.39
7110023	1" x 1/2"	1.75	0.53



### COUPLING

Item #	Size	A	Weight
7110018	1"	1.5	0.85
7110019	1-1/4"	1.75	1.22
7110020	1-1/2"	1.94	1.55
7110021	2"	2.25	2.25

# DUCTILE IRON THREADED FITTINGS

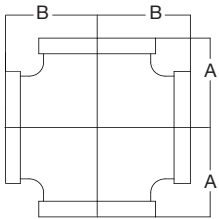

## CROSS

Item #	Size	A	B	Weight
7110094	1"	1.50	1.50	0.98
7110095	1-1/4" x 1"	1.58	1.58	1.27
7110096	1-1/2" x 1"	1.65	1.65	1.45
7110097	2" x 1"	1.73	1.73	2.10
7110098	1-1/4"	1.75	1.75	1.50
7110099	1-1/2"	1.94	1.94	1.90
7110100	2"	2.25	2.25	2.95

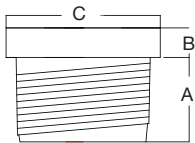

## BUSHING

Item #	Size	A	B	C	Weight
7110103	1" x 1/2"	0.75	0.25	1.42	0.22
7110104	1" x 3/4"	0.75	0.25	1.42	0.17
7110105	1-1/4" x 1"	0.80	0.28	1.76	1.28
7110106	1-1/2" x 1"	0.83	0.31	2.00	0.44
7110107	1-1/2" x 1-1/4"	0.83	0.31	2.00	0.30
7110108	2" x 1"	0.88	0.41	1.95	0.66
7110109	2" x 1-1/4"	0.88	0.34	2.48	0.72
7110110	2" x 1-1/2"	0.88	0.34	2.48	0.61

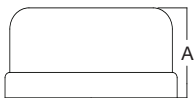

## CAP

Item #	Size	A	Weight
7110113	1"	1.16	0.32
7110114	1-1/4"	1.28	0.43
7110115	1-1/2"	1.33	0.60
7110116	2"	1.45	0.91

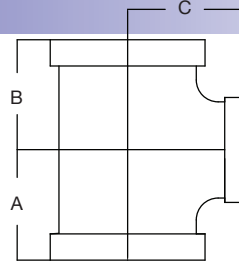

## REDUCING TEE

Item #	Size	A	B	C	Weight
7110026	1" x 1/2" x 1"	1.50	1.36	1.50	0.71
7110027	1" x 3/4" x 1"	1.50	1.45	1.50	0.76
7110028	1" x 1" x 1/2"	1.26	1.26	1.36	0.73
7110029	1" x 1" x 3/4"	1.37	1.37	1.45	0.73
7110030	1" x 1" x 1-1/2"	1.80	1.80	1.65	1.16
7110030A	1" x 1" x 1-1/4"	1.67	1.67	1.58	0.98
7110031	1-1/4" x 1" x 1/2"	1.34	1.26	1.53	0.82
7110032	1-1/4" x 1" x 3/4"	1.45	1.37	1.62	0.90
7110033	1-1/4" x 1" x 1"	1.58	1.50	1.67	1.00
7110034	1-1/4" x 1" x 1-1/4"	1.75	1.67	1.75	1.08
7110035	1-1/4" x 1" x 1-1/2"	1.88	1.88	1.82	1.42
7110036	1-1/4" x 1-1/4" x 1/2"	1.34	1.34	1.53	0.86
7110037	1-1/4" x 1-1/4" x 3/4"	1.45	1.45	1.62	0.92
7110038	1-1/4" x 1-1/4" x 1"	1.58	1.58	1.67	0.95
7110039	1-1/4" x 1-1/4" x 1-1/2"	1.88	1.88	1.82	1.45
7110041	1-1/2" x 1" x 1/2"	1.41	1.34	1.66	0.95
7110042	1-1/2" x 1" x 3/4"	1.52	1.37	1.75	1.14
7110043	1-1/2" x 1" x 1"	1.65	1.50	1.80	1.17
7110045	1-1/2" x 1" x 1-1/2"	1.94	1.80	1.94	1.45
7110046	1-1/2" x 1-1/4" x 1/2"	1.41	1.34	1.66	1.05
7110047	1-1/2" x 1-1/4" x 3/4"	1.52	1.45	1.75	1.15
7110048	1-1/2" x 1-1/4" x 1"	1.65	1.58	1.80	1.25
7110050	1-1/2" x 1-1/2" x 1/2"	1.41	1.41	1.16	1.15
7110051	1-1/2" x 1-1/2" x 3/4"	1.52	1.52	1.75	1.24
7110052	1-1/2" x 1-1/2" x 1"	1.65	1.65	1.80	1.30
7110053	1-1/2" x 1-1/2" x 1-1/4"	1.82	1.82	1.88	1.48
7110055	2" x 1" x 2"	2.25	2.02	2.25	2.15
7110056	2" x 1-1/4" x 2"	2.25	2.10	2.25	2.30
7110057	2" x 1-1/2" x 1/2"	1.49	1.41	1.88	1.50
7110058	2" x 1-1/2" x 3/4"	1.60	1.52	1.97	1.62
7110059	2" x 1-1/2" x 1"	1.73	1.65	2.02	1.64
7110060	2" x 1-1/2" x 1-1/4"	1.90	1.82	2.10	1.80
7110061	2" x 1-1/2" x 1-1/2"	2.02	1.94	2.16	2.00
7110062	2" x 1-1/2" x 2"	2.25	2.16	2.25	2.35
7110063	2" x 2" x 1/2"	1.49	1.49	1.88	1.60
7110064	2" x 2" x 3/4"	1.60	1.60	1.97	1.68
7110065	2" x 2" x 1"	1.73	1.73	2.02	1.85
7110066	2" x 2" x 1-1/4"	1.90	1.90	2.10	2.04
7110067	2" x 2" x 1-1/2"	2.02	2.02	2.16	2.18