

Building connections that last™



SCI® Malleable Iron Threaded Fittings





Malleable Iron Threaded Fittings

Class 150 and Class 300 Specifications




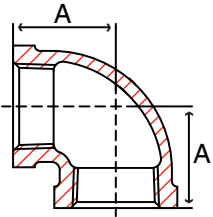
-  branded Class 150 fittings are UL Listed and FM Approved at 300 psi
-  branded Class 300 fittings are UL Listed
- Hot-dipped galvanized fittings are certified to; NSF/ANSI 372 and California AB1953 Lead Free
- Canadian Registration Numbers available at www.smithcooper.com
- Malleable castings conform to ASTM A197
- Hot-dipped galvanized fittings conform to ASTM A153
- Malleable fitting dimensions conform to ASME B16.3
- Malleable bushings, plugs and locknuts conform to ASME B16.14
- Malleable unions conform to ASME B16.39
- NPT threads on all fittings conform to ASME B1.20.1
- Independent lab verification that fittings meet applicable chemical & mechanical properties
- Manufacturing facilities are ISO 9001:2008 and ISO 14001
-  branded fittings are 100% air tested
- ProPak™ Packaging

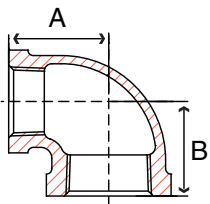


Fig. 33E 1 & 34E 1 – 90° Elbow



Size in	Part Number		A in	Packing		Weight lb
	Black	Galvanized		Inner	Master	
1/8	33E 1001C	34E 1001C	0.69	50	800	0.1
1/4	33E 1002C	34E 1002C	0.81	35	560	0.1
3/8	33E 1003C	34E 1003C	0.95	45	360	0.2
1/2	33E 1004C	34E 1004C	1.12	50	200	0.2
3/4	33E 1006C	34E 1006C	1.31	35	140	0.3
1	33E 1010C	34E 1010C	1.50	20	80	0.6
1-1/4	33E 1012C	34E 1012C	1.75	20	40	0.9
1-1/2	33E 1014C	34E 1014C	1.94	15	30	1.2
2	33E 1020C	34E 1020C	2.25	8	16	1.8
2-1/2	33E 1024C	34E 1024C	2.70	6	12	3.1
3	33E 1030C	34E 1030C	3.08	-	7	3.9
3-1/2	33E 1034C	34E 1034C	3.42	-	4	6.6
4	33E 1040C	34E 1040C	3.79	-	3	7.5
5	33E 1050C	34E 1050C	4.50	-	2	13.2
6	33E 1060C	34E 1060C	5.13	-	1	19.8
8	33E 1080C	34E 1080C	6.38	-	1	32.0

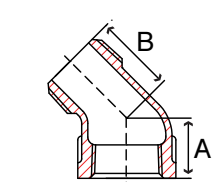
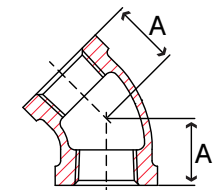
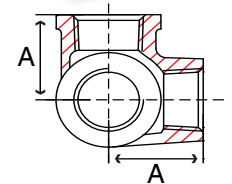
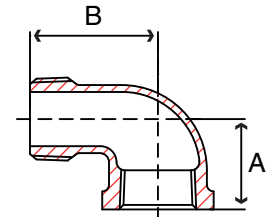
Fig. 33RE1 & 34RE1 – 90° Reducing Elbow



Size in	Part Number		A in	B in	Packing		Weight lb
	Black	Galvanized			Inner	Master	
1/4 x 1/8	33RE1002001C	34RE1002001C	0.76	0.74	40	640	0.2
3/8 x 1/8	33RE1003001C	34RE1003001C	0.85	0.81	70	560	0.2
3/8 x 1/4	33RE1003002C	34RE1003002C	0.90	0.88	60	480	0.2
1/2 x 1/8	33RE1004001C	34RE1004001C	0.98	0.96	50	400	0.2
1/2 x 1/4	33RE1004002C	34RE1004002C	0.98	0.97	40	320	0.2
1/2 x 3/8	33RE1004003C	34RE1004003C	1.04	1.03	50	200	0.2
3/4 x 1/8	33RE1006001C	34RE1006001C	1.08	1.02	40	160	0.3
3/4 x 1/4	33RE1006002C	34RE1006002C	1.08	1.05	40	160	0.3
3/4 x 3/8	33RE1006003C	34RE1006003C	1.13	1.12	40	160	0.3
3/4 x 1/2	33RE1006004C	34RE1006004C	1.22	1.20	40	160	0.3
1 x 1/4	33RE1010002C	34RE1010002C	1.22	1.10	25	300	0.3
1 x 3/8	33RE1010003C	34RE1010003C	1.27	1.18	25	100	0.5
1 x 1/2	33RE1010004C	34RE1010004C	1.36	1.26	25	100	0.4
1 x 3/4	33RE1010006C	34RE1010006C	1.45	1.37	25	100	0.5
1-1/4 x 1/2	33RE1012004C	34RE1012004C	1.53	1.34	20	80	0.6
1-1/4 x 3/4	33RE1012006C	34RE1012006C	1.62	1.45	15	60	0.7
1-1/4 x 1	33RE1012010C	34RE1012010C	1.67	1.58	10	40	0.8
1-1/2 x 1/2	33RE1014004C	34RE1014004C	1.75	1.52	15	60	0.8
1-1/2 x 3/4	33RE1014006C	34RE1014006C	1.75	1.52	10	40	0.8
1-1/2 x 1	33RE1014010C	34RE1014010C	1.80	1.65	10	40	0.9
1-1/2 x 1-1/4	33RE1014012C	34RE1014012C	1.88	1.82	8	32	1.1
2 x 1/2	33RE1020004C	34RE1020004C	1.97	1.60	10	40	1.2
2 x 3/4	33RE1020006C	34RE1020006C	1.97	1.60	10	40	1.2
2 x 1	33RE1020010C	34RE1020010C	2.02	1.73	14	28	1.5
2 x 1-1/4	33RE1020012C	34RE1020012C	2.10	1.90	10	20	1.5
2 x 1-1/2	33RE1020014C	34RE1020014C	2.16	2.02	10	20	1.6
2-1/2 x 3/4	33RE1024006C	34RE1024006C	2.30	1.73	10	20	1.9
2-1/2 x 1	33RE1024010C	34RE1024010C	2.36	1.87	8	16	2.1
2-1/2 x 1-1/4	33RE1024012C	34RE1024012C	2.44	2.03	8	16	2.2
2-1/2 x 1-1/2	33RE1024014C	34RE1024014C	2.51	2.16	8	16	2.3
2-1/2 x 2	33RE1024020C	34RE1024020C	2.60	2.39	8	16	2.6
3 x 1/2	33RE1030004C	34RE1030004C	2.56	1.69	10	20	6.0
3 x 3/4	33RE1030006C	34RE1030006C	2.60	1.87	8	16	6.6
3 x 1	33RE1030010C	34RE1030010C	2.66	1.99	8	16	2.4
3 x 1-1/4	33RE1030012C	34RE1030012C	2.74	2.16	5	10	6.0
3 x 1-1/2	33RE1030014C	34RE1030014C	2.80	2.28	-	8	2.5
3 x 2	33RE1030020C	34RE1030020C	2.89	2.52	-	8	2.7
3 x 2-1/2	33RE1030024C	34RE1030024C	2.99	2.83	-	8	4.0
4 x 1-1/2	33RE1040014C	34RE1040014C	2.31	2.50	-	5	4.7
4 x 2	33RE1040020C	34RE1040020C	3.41	2.74	-	5	5.1
4 x 2-1/2	33RE1040024C	34RE1040024C	3.50	3.05	-	5	6.3
4 x 3	33RE1040030C	34RE1040030C	3.60	3.30	-	5	6.6

MALLEABLE

**Fig. 33SE1 & 34SE1 – 90° Street Elbow &
Fig. 33RS1 & 34RS1 – Reducing 90° Street Elbow**



Size in	Part Number		A in	B in	Packing		Weight lb
	Black	Galvanized			Inner	Master	
1/8	33SE1001C	34SE1001C	0.69	1.00	60	960	0.05
1/4	33SE1002C	34SE1002C	0.81	1.19	35	560	0.1
3/8	33SE1003C	34SE1003C	0.95	1.44	40	320	0.2
1/2	33SE1004C	34SE1004C	1.12	1.61	120	240	0.2
3/4	33SE1006C	34SE1006C	1.30	1.89	70	140	0.3
1	33SE1010C	34SE1010C	1.50	2.13	40	80	0.6
1-1/4	33SE1012C	34SE1012C	1.75	2.44	25	50	0.8
1-1/2	33SE1014C	34SE1014C	1.94	2.67	8	32	1.2
2	33SE1020C	34SE1020C	2.25	3.27	8	16	2.0
2-1/2	33SE1024C	34SE1024C	2.70	3.86	-	10	3.6
3	33SE1030C	34SE1030C	3.08	4.51	-	7	4.2
4	33SE1040C	34SE1040C	3.79	5.69	-	3	9.1
6	33SE1060C	34SE1060C	5.13	8.03	-	1	23.1
Reducing 90° Street Elbow							
3/4 x 1/2	33RS1006004C	34RS1006004C	1.20	1.70	35	140	0.28
1 x 3/4	33RS1010006C	34RS1010006C	1.37	1.89	50	100	0.48
1-1/4 x 1	33RS1014010C	34RS1014010C	1.58	2.38	25	50	0.75

All male threads come with plastic protective caps

Fig. 33OE1 & 34OE1 – 90° Side Outlet Elbow

Size in	Part Number		A in	Packing		Weight lb
	Black	Galvanized		Inner	Master	
1/8	33OE1001C	34OE1001C	0.69	45	720	0.1
1/4	33OE1002C	34OE1002C	0.81	50	400	0.2
3/8	33OE1003C	34OE1003C	0.95	50	200	0.2
1/2	33OE1004C	34OE1004C	1.12	45	180	0.2
3/4	33OE1006C	34OE1006C	1.31	20	80	0.4
1	33OE1010C	34OE1010C	1.50	20	40	0.7
1-1/4	33OE1012C	34OE1012C	1.75	15	30	1.1
1-1/2	33OE1014C	34OE1014C	1.94	12	24	1.3
2	33OE1020C	34OE1020C	2.25	-	12	2.5

Fig. 33F 1 & 34F 1 – 45° Elbow

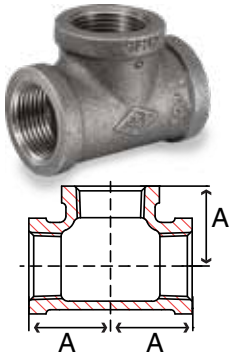
Size in	Part Number		A in	Packing		Weight lb
	Black	Galvanized		Inner	Master	
1/8	33F 1001C	34F 1001C	0.60	50	800	0.1
1/4	33F 1002C	34F 1002C	0.73	30	480	0.1
3/8	33F 1003C	34F 1003C	0.80	50	400	0.1
1/2	33F 1004C	34F 1004C	0.88	50	200	0.2
3/4	33F 1006C	34F 1006C	0.98	40	160	0.3
1	33F 1010C	34F 1010C	1.12	20	80	0.5
1-1/4	33F 1012C	34F 1012C	1.29	20	40	0.7
1-1/2	33F 1014C	34F 1014C	1.43	8	32	1.1
2	33F 1020C	34F 1020C	1.68	12	24	1.7
2-1/2	33F 1024C	34F 1024C	1.95	-	15	2.9
3	33F 1030C	34F 1030C	2.17	-	10	3.4
4	33F 1040C	34F 1040C	2.61	-	3	6.4
5	33F 1050C	34F 1050C	3.05	-	2	12.1
6	33F 1060C	34F 1060C	3.46	-	1	15.4
8	33F 1080C	34F 1080C	4.00	-	1	26.0

Fig. 33SF1 & 34SF1 – 45° Street Elbow

Size in	Part Number		A in	B in	Packing		Weight lb
	Black	Galvanized			Inner	Master	
1/8	33SF1001C	34SF1001C	0.65	0.85	70	1120	0.1
1/4	33SF1002C	34SF1002C	0.73	0.94	40	640	0.1
3/8	33SF1003C	34SF1003C	0.80	1.03	40	480	0.1
1/2	33SF1004C	34SF1004C	0.88	1.15	65	260	0.2
3/4	33SF1006C	34SF1006C	0.98	1.29	40	160	0.3
1	33SF1010C	34SF1010C	1.12	1.47	25	100	0.5
1-1/4	33SF1012C	34SF1012C	1.29	1.71	10	40	0.8
1-1/2	33SF1014C	34SF1014C	1.43	1.88	10	40	0.9
2	33SF1020C	34SF1020C	1.68	2.22	12	24	1.5
2-1/2	33SF1024C	34SF1024C	1.95	2.57	5	10	2.7
3	33SF1030C	34SF1030C	2.17	3.00	-	6	3.6
4	33SF1040C	34SF1040C	2.61	3.70	-	4	9.2

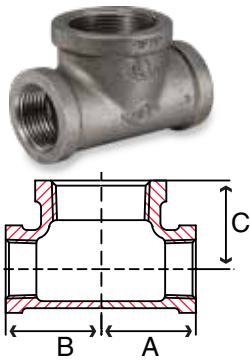
MALLEABLE

Fig. 33T 1 & 34T 1 – Tee



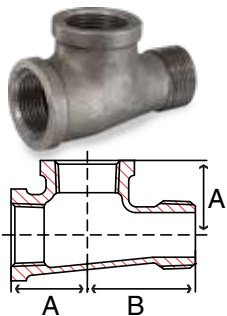
Size in	Part Number		A in	Packing		Weight lb
	Black	Galvanized		Inner	Master	
1/8	33T 1001C	34T 1001C	0.69	80	640	0.1
1/4	33T 1002C	34T 1002C	0.81	45	360	0.1
3/8	33T 1003C	34T 1003C	0.95	25	200	0.2
1/2	33T 1004C	34T 1004C	1.12	35	140	0.3
3/4	33T 1006C	34T 1006C	1.31	20	80	0.5
1	33T 1010C	34T 1010C	1.50	25	50	0.8
1-1/4	33T 1012C	34T 1012C	1.75	14	28	1.2
1-1/2	33T 1014C	34T 1014C	1.94	12	24	1.6
2	33T 1020C	34T 1020C	2.25	-	15	2.5
2-1/2	33T 1024C	34T 1024C	2.70	-	10	4.2
3	33T 1030C	34T 1030C	3.08	-	6	6.1
3-1/2	33T 1034C	34T 1034C	3.42	-	2	9.4
4	33T 1040C	34T 1040C	3.79	-	2	9.7
5	33T 1050C	34T 1050C	4.50	-	2	15.4
6	33T 1060C	34T 1060C	5.13	-	1	26.4
8	33T 1080C	34T 1080C	6.50	-	1	50.7

Fig. 33BT1 & 34BT1 – Bull Head Tee



Size in	Part Number		A in	B in	C in	Packing		Weight lb
	Black	Galvanized				Inner	Master	
1/4 x 3/8	33BT1002003C	34BT1002003C	0.90	0.90	0.88	20	240	0.3
1/2 x 3/4	33BT1004006C	34BT1004006C	1.22	1.22	1.20	25	100	0.3
1/2 x 1	33BT1004010C	34BT1004010C	1.36	1.36	1.26	40	80	0.5
3/4 x 1	33BT1006010C	34BT1006010C	1.45	1.45	1.37	15	60	0.5
3/4 x 1-1/4	33BT1006012C	34BT1006012C	1.62	1.62	1.45	20	40	0.7
1 x 1-1/4	33BT1010012C	34BT1010012C	1.67	1.67	1.58	8	32	0.9
1 x 1-1/2	33BT1010014C	34BT1010014C	1.80	1.80	1.65	15	30	1.1
1 x 2	33BT1010020C	34BT1010020C	2.02	2.02	1.73	12	24	1.2
1-1/4 x 1-1/2	33BT1012014C	34BT1012014C	1.88	1.88	1.82	10	20	1.3
1-1/4 x 2	33BT1012020C	34BT1012020C	2.10	2.10	1.90	8	16	1.8
1-1/2 x 2	33BT1014020C	34BT1014020C	2.16	2.16	2.02	8	16	1.7
2 x 2-1/2	33BT1020024C	34BT1020024C	2.60	2.60	2.39	6	12	3.0
2 x 3	33BT1020030C	34BT1020030C	2.88	2.88	2.55	-	6	4.0
2-1/2 x 3	33BT1024030C	34BT1024030C	3.00	3.00	2.83	-	6	5.8
3 x 4	33BT1030040C	34BT1030040C	3.60	3.60	3.30	-	2	8.6

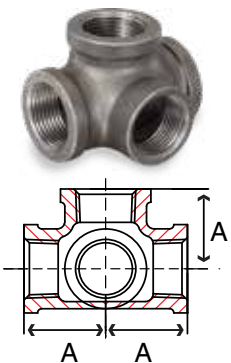
Fig. 33ST1 & 34ST1 – Service Tee



Size in	Part Number		A in	B in	Packing		Weight lb
	Black	Galvanized			Inner	Master	
1/2	33ST1004C	34ST1004C	1.12	1.63	40	160	0.3
3/4	33ST1006C	34ST1006C	1.31	1.89	25	100	0.5
1	33ST1010C	34ST1010C	1.50	2.14	30	60	0.8
1-1/4	33ST1012C	34ST1012C	1.75	2.45	15	30	1.2
1-1/2	33ST1014C	34ST1014C	1.94	2.69	10	20	1.7
2	33ST1020C	34ST1020C	2.25	3.26	6	12	2.0

All male threads come with plastic protective caps

Fig. 330T1 & 340T1 – Side Outlet Tee



Size in	Part Number		A in	Packing		Weight lb
	Black	Galvanized		Inner	Master	
1/2	330T1004C	340T1004C	1.12	20	80	0.2
3/4	330T1006C	340T1006C	1.31	15	60	0.6
1	330T1010C	340T1010C	1.50	20	40	0.9
1-1/4	330T1012C	340T1012C	1.75	12	24	1.1
1-1/2	330T1014C	340T1014C	1.94	8	16	1.4
2	330T1020C	340T1020C	2.25	-	10	2.7

MALLEABLE



Fig. 33X 1 & 34X 1 – Cross

Size in	Part Number		A in	Packing		Weight lb
	Black	Galvanized		Inner	Master	
1/8	33X 1001C	34X 1001C	0.69	20	320	0.2
1/4	33X 1002C	34X 1002C	0.81	40	320	0.2
3/8	33X 1003C	34X 1003C	0.95	40	160	0.3
1/2	33X 1004C	34X 1004C	1.12	30	120	0.3
3/4	33X 1006C	34X 1006C	1.31	20	80	0.6
1	33X 1010C	34X 1010C	1.50	20	40	1.1
1-1/4	33X 1012C	34X 1012C	1.75	-	20	1.4
1-1/2	33X 1014C	34X 1014C	1.94	-	18	1.9
2	33X 1020C	34X 1020C	2.25	-	10	2.8
2-1/2	33X 1024C	34X 1024C	2.70	-	6	5.0
3	33X 1030C	34X 1030C	3.08	-	4	7.3
4	33X 1040C	34X 1040C	3.79	-	2	12.6

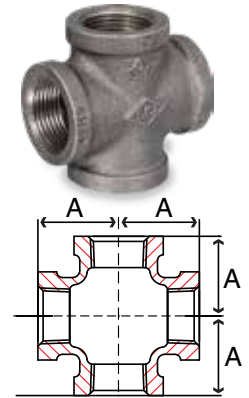


Fig. 33C 1 & 34C 1 – Cap

Size in	Part Number		A in	Packing		Weight lb
	Black	Galvanized		Inner	Master	
1/8	33C 1001C	34C 1001C	0.53	120	1920	0.05
1/4	33C 1002C	34C 1002C	0.63	80	1280	0.05
3/8	33C 1003C	34C 1003C	0.74	60	720	0.1
1/2	33C 1004C	34C 1004C	0.87	75	600	0.1
3/4	33C 1006C	34C 1006C	0.97	40	320	0.2
1	33C 1010C	34C 1010C	1.16	25	200	0.3
1-1/4	33C 1012C	34C 1012C	1.28	25	100	0.5
1-1/2	33C 1014C	34C 1014C	1.33	25	100	0.6
2	33C 1020C	34C 1020C	1.45	15	60	1.1
2-1/2	33C 1024C	34C 1024C	1.70	20	40	1.6
3	33C 1030C	34C 1030C	1.80	12	24	2.2
3-1/2	33C 1034C	34C 1034C	1.90	6	12	3.5
4	33C 1040C	34C 1040C	2.08	-	12	3.9
5	33C 1050C	34C 1050C	2.32	-	10	5.6
6	33C 1060C	34C 1060C	2.55	-	5	8.8
8	33C 1080C	34C 1080C	3.20	-	4	17.0

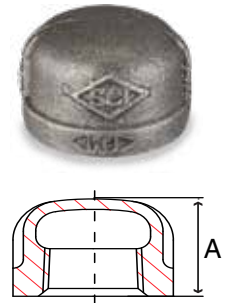


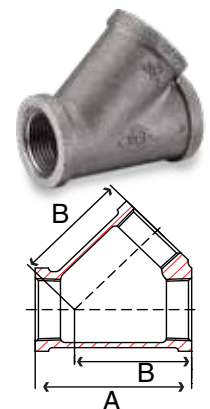
Fig. 33EP1 & 34EP1 – Extension Piece

Size in	Part Number		A in	Packing		Weight lb
	Black	Galvanized		Inner	Master	
1/2	33EP1004C	34EP1004C	1.72	50	400	0.2
3/4	33EP1006C	34EP1006C	1.82	40	160	0.2
1	33EP1010C	34EP1010C	2.20	30	120	0.3
1-1/4	33EP1012C	34EP1012C	2.60	30	60	0.6
1-1/2	33EP1014C	34EP1014C	2.65	20	40	0.8
2	33EP1020C	34EP1020C	2.85	15	30	0.9



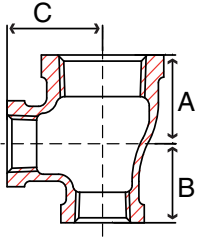
Fig. 33LT1 & 34LT1 – Lateral

Size in	Part Number		A in	B in	Packing		Weight lb
	Black	Galvanized			Inner	Master	
1/2	33LT1004C	34LT1004C	2.32	1.71	30	120	0.3
3/4	33LT1006C	34LT1006C	2.77	2.05	40	80	0.6
1	33LT1010C	34LT1010C	3.28	2.43	20	40	0.9
1-1/4	33LT1012C	34LT1012C	3.94	2.92	12	24	1.4
1-1/2	33LT1014C	34LT1014C	4.38	3.28	10	20	2.0
2	33LT1020C	34LT1020C	5.17	3.93	5	10	3.1
2-1/2	33LT1024C	34LT1024C	6.25	4.73	-	4	8.2
3	33LT1030C	34LT1030C	7.26	5.55	-	2	16.1
4	33LT1040C	34LT1040C	8.98	6.97	-	2	20.0



MALLEABLE

Fig. 33RT1 & 34RT1 – Reducing Tee



Size in	Part Number		A in	B in	C in	Packing		Weight lb
	Black	Galvanized				Inner	Master	
3/8 x 1/8	33RT1003001C	34RT1003001C	0.81	0.81	0.86	60	240	0.2
3/8 x 1/4	33RT1003002C	34RT1003002C	0.81	0.81	0.86	40	160	0.2
1/2 x 1/8	33RT1004001C	34RT1004001C	0.91	0.91	0.97	20	480	0.3
1/2 x 1/4	33RT1004002C	34RT1004002C	0.97	0.97	0.98	20	160	0.2
1/2 x 1/4 x 1/2	33RT1004002004C	34RT1004002004C	1.12	0.97	1.12	20	160	0.2
1/2 x 3/8	33RT1004003C	34RT1004003C	1.04	1.04	1.03	20	160	0.2
1/2 x 3/8 x 1/2	33RT1004003004C	34RT1004003004C	1.12	1.03	1.12	20	160	0.2
3/4 x 1/4	33RT1006002C	34RT1006002C	1.12	1.12	1.12	25	100	0.3
3/4 x 3/8	33RT1006003C	34RT1006003C	1.12	1.12	1.13	25	100	0.4
3/4 x 3/8 x 3/4	33RT1006003006C	34RT1006003006C	1.31	1.13	1.31	25	100	0.4
3/4 x 1/2	33RT1006004C	34RT1006004C	1.20	1.20	1.22	20	80	0.4
3/4 x 1/2 x 1/2	33RT1006004004C	34RT1006004004C	1.20	1.12	1.22	25	100	0.3
3/4 x 1/2 x 3/4	33RT1006004006C	34RT1006004006C	1.31	1.22	1.31	20	80	0.4
3/4 x 1/2 x 1	33RT1006004010C	34RT1006004010C	1.45	1.36	1.37	18	72	0.5
1 x 1/4	33RT1010002C	34RT1010002C	1.12	1.12	1.25	20	80	0.5
1 x 3/8	33RT1010003C	34RT1010003C	1.18	1.18	1.27	15	60	0.5
1 x 1/2	33RT1010004C	34RT1010004C	1.26	1.26	1.36	15	60	0.6
1 x 1/2 x 1/2	33RT1010004004C	34RT1010004004C	1.26	1.12	1.36	20	80	0.6
1 x 1/2 x 3/4	33RT1010004006C	34RT1010004006C	1.37	1.22	1.45	20	80	0.6
1 x 1/2 x 1	33RT1010004010C	34RT1010004010C	1.50	1.36	1.50	15	60	0.7
1 x 3/4	33RT1010006C	34RT1010006C	1.38	1.31	1.45	12	48	0.7
1 x 3/4 x 1/2	33RT1010006004C	34RT1010006004C	1.26	1.20	1.36	20	80	0.6
1 x 3/4 x 3/4	33RT1010006006C	34RT1010006006C	1.38	1.31	1.45	15	60	0.6
1 x 3/4 x 1	33RT1010006010C	34RT1010006010C	1.50	1.45	1.50	15	60	0.7
1-1/4 x 3/8	33RT1012003C	34RT1012003C	1.26	1.26	1.44	20	40	0.8
1-1/4 x 1/2	33RT1012004C	34RT1012004C	1.34	1.34	1.53	20	40	0.8
1-1/4 x 1/2 x 1/2	33RT1012004004C	34RT1012004004C	1.36	1.12	1.53	25	50	0.6
1-1/4 x 1/2 x 3/4	33RT1012004006C	34RT1012004006C	1.45	1.26	1.53	25	50	0.7
1-1/4 x 1/2 x 1	33RT1012004010C	34RT1012004010C	1.58	1.36	1.67	20	40	0.8
1-1/4 x 1/2 x 1-1/4	33RT1012004012C	34RT1012004012C	1.75	1.53	1.75	20	40	1.1
1-1/4 x 3/4	33RT1012006C	34RT1012006C	1.45	1.45	1.62	20	40	0.9
1-1/4 x 3/4 x 1/2	33RT1012006004C	34RT1012006004C	1.34	1.12	1.53	10	40	0.7
1-1/4 x 3/4 x 3/4	33RT1012006006C	34RT1012006006C	1.45	1.31	1.62	10	40	0.9
1-1/4 x 3/4 x 1	33RT1012006010C	34RT1012006010C	1.58	1.45	1.67	10	40	0.9
1-1/4 x 3/4 x 1-1/4	33RT1012006012C	34RT1012006012C	1.75	1.62	1.75	10	40	1.1
1-1/4 x 1	33RT1012010C	34RT1012010C	1.58	1.58	1.67	20	40	1.0
1-1/4 x 1 x 1/2	33RT1012010004C	34RT1012010004C	1.34	1.26	1.53	20	40	0.8
1-1/4 x 1 x 3/4	33RT1012010006C	34RT1012010006C	1.45	1.38	1.63	20	40	1.0
1-1/4 x 1 x 1	33RT1012010010C	34RT1012010010C	1.58	1.50	1.69	20	40	0.9
1-1/4 x 1 x 1-1/4	33RT1012010012C	34RT1012010012C	1.75	1.69	1.75	20	40	1.1
1-1/2 x 3/8	33RT1014003C	34RT1014003C	1.36	1.36	1.66	18	36	1.0
1-1/2 x 1/2	33RT1014004C	34RT1014004C	1.41	1.41	1.66	18	36	1.0
1-1/2 x 1/2 x 1/2	33RT1014004004C	34RT1014004004C	1.35	1.08	1.67	12	48	0.7
1-1/2 x 1/2 x 3/4	33RT1014004006C	34RT1014004006C	1.56	1.18	1.80	12	48	1.1
1-1/2 x 1/2 x 1	33RT1014004010C	34RT1014004010C	1.65	1.35	1.80	18	36	1.0
1-1/2 x 1/2 x 1-1/4	33RT1014004012C	34RT1014004012C	1.81	1.56	1.88	15	30	1.1
1-1/2 x 1/2 x 1-1/2	33RT1014004014C	34RT1014004014C	1.94	1.66	1.94	12	24	1.1
1-1/2 x 3/4	33RT1014006C	34RT1014006C	1.52	1.52	1.75	15	30	1.0
1-1/2 x 3/4 x 1/2	33RT1014006004C	34RT1014006004C	1.35	1.12	1.77	15	30	1.1
1-1/2 x 3/4 x 3/4	33RT1014006006C	34RT1014006006C	1.55	1.35	1.77	15	30	1.1
1-1/2 x 3/4 x 1	33RT1014006010C	34RT1014006010C	1.82	1.35	1.88	15	30	1.0
1-1/2 x 3/4 x 1-1/4	33RT1014006012C	34RT1014006012C	1.94	1.66	1.88	12	24	1.1
1-1/2 x 3/4 x 1-1/2	33RT1014006014C	34RT1014006014C	1.94	1.75	1.94	12	24	1.3
1-1/2 x 1	33RT1014010C	34RT1014010C	1.65	1.65	1.80	15	30	1.2
1-1/2 x 1 x 1/2	33RT1014010004C	34RT1014010004C	1.44	1.25	1.69	15	30	0.8
1-1/2 x 1 x 3/4	33RT1014010006C	34RT1014010006C	1.50	1.44	1.75	15	30	1.0
1-1/2 x 1 x 1	33RT1014010010C	34RT1014010010C	1.65	1.50	1.80	15	30	1.1
1-1/2 x 1 x 1-1/4	33RT1014010012C	34RT1014010012C	1.82	1.67	1.88	12	24	1.2

MALLEABLE

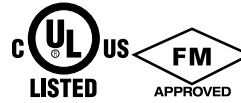
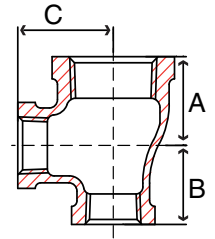


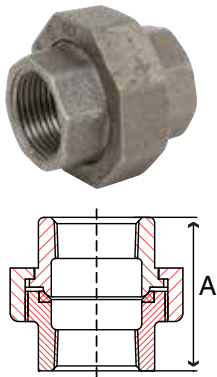
Fig. 33RT1 & 34RT1 – Reducing Tee, cont.

Size in	Part Number		A in	B in	C in	Packing		Weight lb
	Black	Galvanized				Inner	Master	
1-1/2 x 1 x 1-1/2	33RT1014010014C	34RT1014010014C	1.94	1.80	1.94	12	24	1.5
1-1/2 x 1-1/4	33RT1014012C	34RT1014012C	1.82	1.82	1.88	12	24	1.4
1-1/2 x 1-1/4 x 1/2	33RT1014012004C	34RT1014012004C	1.41	1.34	1.66	12	24	0.9
1-1/2 x 1-1/4 x 3/4	33RT1014012006C	34RT1014012006C	1.52	1.45	1.75	12	24	1.1
1-1/2 x 1-1/4 x 1	33RT1014012010C	34RT1014012010C	1.65	1.58	1.80	12	24	1.2
1-1/2 x 1-1/4 x 1-1/4	33RT1014012012C	34RT1014012012C	1.82	1.75	1.88	12	24	1.4
1-1/2 x 1-1/4 x 1-1/2	33RT1014012014C	34RT1014012014C	1.94	1.88	1.94	12	24	1.4
1-1/2 x 1-1/4 x 2	33RT1014012020C	34RT1014012020C	2.16	2.10	2.02	8	16	1.9
2 x 3/8	33RT1020003C	34RT1020003C	1.49	1.49	1.88	10	40	1.6
2 x 1/2	33RT1020004C	34RT1020004C	1.49	1.49	1.88	10	20	1.3
2 x 1/2 x 2	33RT1020004020C	34RT1020004020C	2.25	1.88	2.25	8	16	2.0
2 x 3/4	33RT1020006C	34RT1020006C	1.60	1.60	1.97	10	20	1.6
2 x 3/4 x 3/4	33RT1020006006C	34RT1020006006C	1.65	1.31	1.92	12	24	1.5
2 x 3/4 x 2	33RT1020006020C	34RT1020006020C	2.25	1.97	2.25	8	16	2.1
2 x 1	33RT1020010C	34RT1020010C	1.73	1.73	2.02	10	20	1.7
2 x 1 x 1	33RT1020010010C	34RT1020010010C	1.78	1.45	2.08	12	24	1.7
2 x 1 x 1-1/4	33RT1020010012C	34RT1020010012C	1.90	1.75	2.10	10	20	1.6
2 x 1 x 1-1/2	33RT1020010014C	34RT1020010014C	2.10	1.88	2.18	10	20	1.5
2 x 1 x 2	33RT1020010020C	34RT1020010020C	2.25	2.02	2.25	8	16	2.0
2 x 1-1/4	33RT1020012C	34RT1020012C	1.90	1.90	2.10	8	16	1.9
2 x 1-1/4 x 1	33RT1020012010C	34RT1020012010C	1.78	1.65	2.10	10	20	1.5
2 x 1-1/4 x 1-1/4	33RT1020012012C	34RT1020012012C	1.90	1.75	2.10	8	16	1.5
2 x 1-1/4 x 1-1/2	33RT1020012014C	34RT1020012014C	2.00	1.88	2.18	8	16	1.9
2 x 1-1/4 x 2	33RT1020012020C	34RT1020012020C	2.25	2.10	2.25	8	16	2.6
2 x 1-1/2	33RT1020014C	34RT1020014C	2.02	2.02	2.16	8	16	1.9
2 x 1-1/2 x 3/4	33RT1020014006C	34RT1020014006C	1.60	1.52	1.97	10	20	1.6
2 x 1-1/2 x 1	33RT1020014010C	34RT1020014010C	1.73	1.65	2.02	10	20	1.5
2 x 1-1/2 x 1-1/4	33RT1020014012C	34RT1020014012C	1.90	1.82	2.10	8	16	1.8
2 x 1-1/2 x 1-1/2	33RT1020014014C	34RT1020014014C	2.02	1.94	2.16	8	16	1.9
2 x 1-1/2 x 2	33RT1020014020C	34RT1020014020C	2.25	2.16	2.25	8	16	2.6
2-1/2 x 1/2	33RT1024004C	34RT1024004C	1.65	1.65	2.27	-	16	2.4
2-1/2 x 3/4	33RT1024006C	34RT1024006C	1.74	1.74	2.32	-	16	2.4
2-1/2 x 1	33RT1024010C	34RT1024010C	1.87	1.87	2.37	-	16	3.2
2-1/2 x 1-1/4	33RT1024012C	34RT1024012C	2.04	2.04	2.45	-	10	3.1
2-1/2 x 1-1/2	33RT1024014C	34RT1024014C	2.16	2.16	2.51	-	10	3.5
2-1/2 x 1-1/2 x 1-1/2	33RT1024014014C	34RT1024014014C	2.16	1.97	2.51	-	10	2.7
2-1/2 x 1-1/2 x 2	33RT1024014020C	34RT1024014020C	2.39	2.16	2.60	-	10	2.8
2-1/2 x 1-1/2 x 2-1/2	33RT1024014024C	34RT1024014024C	2.70	2.51	2.70	-	10	3.8
2-1/2 x 2	33RT1024020C	34RT1024020C	2.39	2.39	2.60	-	10	4.0
2-1/2 x 2 x 2	33RT1024020020C	34RT1024020020C	2.39	2.25	2.60	-	10	3.7
2-1/2 x 2 x 2-1/2	33RT1024020024C	34RT1024020024C	2.70	2.60	2.70	-	10	3.9
3 x 1/2	33RT1030004C	34RT1030004C	1.80	1.80	2.57	6	12	2.4
3 x 3/4	33RT1030006C	34RT1030006C	1.87	1.87	2.61	-	6	2.4
3 x 1	33RT1030010C	34RT1030010C	2.00	2.00	2.66	-	6	2.6
3 x 1-1/4	33RT1030012C	34RT1030012C	2.17	2.17	2.74	-	6	2.4
3 x 1-1/2	33RT1030014C	34RT1030014C	2.29	2.29	2.80	-	6	2.5
3 x 2	33RT1030020C	34RT1030020C	2.52	2.52	2.89	-	6	2.7
3 x 2 x 2	33RT1030020020C	34RT1030020020C	2.52	2.25	2.89	-	6	4.0
4 x 1/2	33RT1040004C	34RT1040004C	2.03	2.03	3.25	-	4	5.1
4 x 3/4	33RT1040006C	34RT1040006C	2.25	2.25	3.25	-	4	5.4
4 X 1-1/4	33RT1040012C	34RT1040012C	2.41	2.41	3.32	-	4	6.9
4 x 1-1/2	33RT1040014C	34RT1040014C	2.51	2.51	3.32	-	4	7.1
4 x 2	33RT1040020C	34RT1040020C	2.74	2.74	3.41	-	3	7.7
4 x 2-1/2	33RT1040024C	34RT1040024C	3.05	3.05	3.51	-	3	8.6
4 x 3	33RT1040030C	34RT1040030C	3.30	3.30	3.60	-	3	9.5
6 x 2	33RT1060020C	34RT1060020C	3.08	3.08	4.56	-	1	16.4
6 x 2-1/2	33RT1060024C	34RT1060024C	3.39	3.39	4.66	-	1	18.0
6 x 3	33RT1060030C	34RT1060030C	3.64	3.64	4.75	-	1	19.3
6 x 4	33RT1060040C	34RT1060040C	4.13	4.13	4.94	-	1	21.5
6 x 5	33RT1060050C	34RT1060050C	4.53	4.53	5.50	-	1	30.0



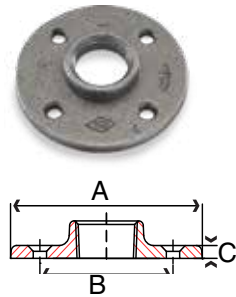
MALLEABLE

Fig. 33U 1 & 34U 1 – Union with Brass Seat



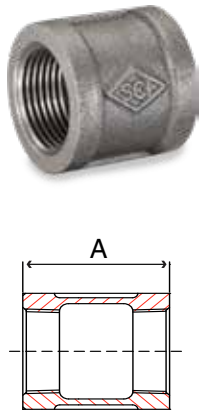
Size in	Part Number		A in	Packing		Weight lb
	Black	Galvanized		Inner	Master	
1/8	33U 1001C	34U 1001C	1.32	30	480	0.1
1/4	33U 1002C	34U 1002C	1.44	20	240	0.2
3/8	33U 1003C	34U 1003C	1.61	20	160	0.3
1/2	33U 1004C	34U 1004C	1.72	40	160	0.4
3/4	33U 1006C	34U 1006C	2.02	40	80	0.5
1	33U 1010C	34U 1010C	2.19	30	60	0.9
1-1/4	33U 1012C	34U 1012C	2.26	20	40	1.3
1-1/2	33U 1014C	34U 1014C	2.47	15	30	2.2
2	33U 1020C	34U 1020C	2.75	10	20	3.3
2-1/2	33U 1024C	34U 1024C	3.25	-	10	4.8
3	33U 1030C	34U 1030C	3.54	-	7	6.8
4	33U 1040C	34U 1040C	3.85	-	4	12.2

Fig. 33FF1 & 34FF1 – Floor Flange



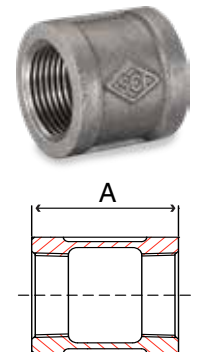
Size in	Part Number		A in	B in	C in	Packing		Weight lb
	Black	Galvanized				Inner	Master	
1/4	33FF1002C	34FF1002C	2.83	2.00	0.31	50	200	0.2
3/8	33FF1003C	34FF1003C	2.75	1.90	0.26	50	200	0.2
1/2	33FF1004C	34FF1004C	3.00	2.10	0.36	50	200	0.3
3/4	33FF1006C	34FF1006C	3.40	2.40	0.26	30	120	0.4
1	33FF1010C	34FF1010C	3.80	2.80	0.26	20	80	0.5
1-1/4	33FF1012C	34FF1012C	4.20	3.20	0.28	15	60	0.9
1-1/2	33FF1014C	34FF1014C	4.60	3.45	0.30	12	48	1.3
2	33FF1020C	34FF1020C	5.20	4.00	0.30	8	32	2.2
2-1/2	33FF1024C	34FF1024C	6.75	5.00	0.37	6	12	3.3
3	33FF1030C	34FF1030C	7.88	6.00	0.45	5	10	4.8
4	33FF1040C	34FF1040C	9.50	7.00	0.45	-	10	6.8

Fig. 33CP1 & 34CP1 – Banded Coupling



Size in	Part Number		A in	Packing		Weight lb
	Black	Galvanized		Inner	Master	
1/8	33CP1001C	34CP1001C	0.96	70	1120	0.05
1/4	33CP1002C	34CP1002C	1.06	40	640	0.1
3/8	33CP1003C	34CP1003C	1.16	40	480	0.1
1/2	33CP1004C	34CP1004C	1.34	40	320	0.2
3/4	33CP1006C	34CP1006C	1.52	50	200	0.3
1	33CP1010C	34CP1010C	1.67	25	100	0.4
1-1/4	33CP1012C	34CP1012C	1.93	20	80	0.6
1-1/2	33CP1014C	34CP1014C	2.15	12	48	0.8
2	33CP1020C	34CP1020C	2.53	12	24	1.3
2-1/2	33CP1024C	34CP1024C	2.88	8	16	2.2
3	33CP1030C	34CP1030C	3.18	8	16	2.8
3-1/2	33CP1034C	34CP1034C	3.50	-	8	3.5
4	33CP1040C	34CP1040C	3.69	-	6	4.6
5	33CP1050C	34CP1050C	3.75	-	3	8.4
6	33CP1060C	34CP1060C	4.75	-	3	11.0

Fig. 33RL1 & 34RL1 – Right and Left Coupling



Size in	Part Number		A in	Packing		Weight lb
	Black	Galvanized		Inner	Master	
1/2	33RL1004C	34RL1004C	1.34	40	320	0.2
3/4	33RL1006C	34RL1006C	1.52	50	200	0.3
1	33RL1010C	34RL1010C	1.67	25	100	0.4
1-1/4	33RL1012C	34RL1012C	1.93	20	80	0.6
1-1/2	33RL1014C	34RL1014C	2.15	12	48	0.8
2	33RL1020C	34RL1020C	2.53	12	24	1.3

MALLEABLE

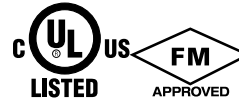
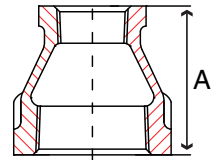


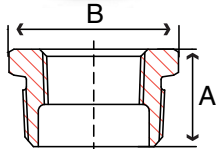
Fig. 33RC1 & 34RC1 – Reducing Coupling

Size in	Part Number		A in	Packing		Weight lb
	Black	Galvanized		Inner	Master	
1/4 x 1/8	33RC1002001C	34RC1002001C	1.00	50	600	0.1
3/8 x 1/8	33RC1003001C	34RC1003001C	1.13	35	420	0.1
3/8 x 1/4	33RC1003002C	34RC1003002C	1.13	30	360	0.1
1/2 x 1/8	33RC1004001C	34RC1004001C	1.25	50	400	0.1
1/2 x 1/4	33RC1004002C	34RC1004002C	1.25	50	400	0.1
1/2 x 3/8	33RC1004003C	34RC1004003C	1.25	40	320	0.1
3/4 x 1/8	33RC1006001C	34RC1006001C	1.44	35	280	0.2
3/4 x 1/4	33RC1006002C	34RC1006002C	1.44	30	240	0.2
3/4 x 3/8	33RC1006003C	34RC1006003C	1.44	60	240	0.2
3/4 x 1/2	33RC1006004C	34RC1006004C	1.44	60	240	0.2
1 x 1/4	33RC1010002C	34RC1010002C	1.69	45	180	0.3
1 x 3/8	33RC1010003C	34RC1010003C	1.69	30	120	0.3
1 x 1/2	33RC1010004C	34RC1010004C	1.69	30	120	0.3
1 x 3/4	33RC1010006C	34RC1010006C	1.69	25	100	0.4
1-1/4 x 3/8	33RC1012003C	34RC1012003C	2.06	25	100	0.5
1-1/4 x 1/2	33RC1012004C	34RC1012004C	2.06	25	100	0.5
1-1/4 x 3/4	33RC1012006C	34RC1012006C	2.06	25	100	0.5
1-1/4 x 1	33RC1012010C	34RC1012010C	2.06	15	60	0.5
1-1/2 x 3/8	33RC1014003C	34RC1014003C	2.31	15	60	0.6
1-1/2 x 1/2	33RC1014004C	34RC1014004C	2.31	15	60	0.6
1-1/2 x 3/4	33RC1014006C	34RC1014006C	2.31	15	60	0.6
1-1/2 x 1	33RC1014010C	34RC1014010C	2.31	15	60	0.7
1-1/2 x 1-1/4	33RC1014012C	34RC1014012C	2.31	12	48	0.7
2 x 3/8	33RC1020003C	34RC1020003C	2.81	14	56	0.9
2 x 1/2	33RC1020004C	34RC1020004C	2.81	12	48	0.9
2 x 3/4	33RC1020006C	34RC1020006C	2.81	12	48	1.0
2 x 1	33RC1020010C	34RC1020010C	2.81	12	48	1.0
2 x 1-1/4	33RC1020012C	34RC1020012C	2.81	14	28	1.0
2 x 1-1/2	33RC1020014C	34RC1020014C	2.81	12	24	1.0
2-1/2 x 1/2	33RC1024004C	34RC1024004C	3.25	-	25	1.5
2-1/2 x 3/4	33RC1024006C	34RC1024006C	3.25	-	25	1.5
2-1/2 x 1	33RC1024010C	34RC1024010C	3.25	-	25	1.6
2-1/2 x 1-1/4	33RC1024012C	34RC1024012C	3.25	-	25	1.7
2-1/2 x 1-1/2	33RC1024014C	34RC1024014C	3.25	-	25	1.7
2-1/2 x 2	33RC1024020C	34RC1024020C	3.25	-	25	1.8
3 x 1/2	33RC1030004C	34RC1030004C	3.69	-	20	2.0
3 x 3/4	33RC1030006C	34RC1030006C	3.69	-	20	2.4
3 x 1	33RC1030010C	34RC1030010C	3.69	-	20	2.2
3 x 1-1/4	33RC1030012C	34RC1030012C	3.69	-	20	2.0
3 x 1-1/2	33RC1030014C	34RC1030014C	3.69	-	20	2.2
3 x 2	33RC1030020C	34RC1030020C	3.69	-	18	2.4
3 x 2-1/2	33RC1030024C	34RC1030024C	3.69	-	12	2.5
4 x 1/2	33RC1040004C	34RC1040004C	4.38	-	10	4.0
4 x 3/4	33RC1040006C	34RC1040006C	4.38	-	10	4.0
4 x 1	33RC1040010C	34RC1040010C	4.38	-	10	3.7
4 x 1-1/4	33RC1040012C	34RC1040012C	4.38	-	10	3.7
4 x 1-1/2	33RC1040014C	34RC1040014C	4.38	-	10	4.4
4 x 2	33RC1040020C	34RC1040020C	4.38	-	10	4.4
4 x 2-1/2	33RC1040024C	34RC1040024C	4.38	-	10	4.0
4 x 3	33RC1040030C	34RC1040030C	4.38	-	8	4.2
5 x 2	33RC1050020C	34RC1050020C	3.87	-	4	7.2
5 x 2-1/2	33RC1050024C	34RC1050024C	3.87	-	4	5.5
5 x 3	33RC1050030C	34RC1050030C	3.87	-	4	7.8
5 x 4	33RC1050040C	34RC1050040C	4.86	-	4	9.8
6 x 2	33RC1060020C	34RC1060020C	4.20	-	4	7.5
6 x 2-1/2	33RC1060024C	34RC1060024C	4.20	-	4	7.5
6 x 3	33RC1060030C	34RC1060030C	4.20	-	4	7.9
6 x 4	33RC1060040C	34RC1060040C	4.20	-	3	9.9
6 x 5	33RC1060050C	34RC1060050C	4.20	-	3	8.7
8 x 6	33RC1080060C	34RC1080060C	5.25	-	2	17.1



MALLEABLE

Fig. 33HB1 & 34HB1 – Hex Bushing



Size in	Part Number		A in	B in	Hex	Packing		Weight lb
	Black	Galvanized				Inner	Master	
1/4 x 1/8	33HB1002001C	34HB1002001C	0.61	.066	Out	120	1920	0.05
3/8 x 1/8	33HB1003001C	34HB1003001C	0.81	0.73	Out	75	1200	0.05
3/8 x 1/4	33HB1003002C	34HB1003002C	0.81	0.73	Out	75	1200	0.05
1/2 x 1/8	33HB1004001C	34HB1004001C	0.95	0.88	Out	100	800	0.1
1/2 x 1/4	33HB1004002C	34HB1004002C	0.95	0.88	Out	100	800	0.1
1/2 x 3/8	33HB1004003C	34HB1004003C	0.95	0.88	Out	100	800	0.1
3/4 x 1/8	33HB1006001C	34HB1006001C	0.95	1.18	Out	40	320	0.2
3/4 x 1/4	33HB1006002C	34HB1006002C	1.05	1.18	Out	40	320	0.2
3/4 x 3/8	33HB1006003C	34HB1006003C	1.05	1.18	Out	40	320	0.2
3/4 x 1/2	33HB1006004C	34HB1006004C	1.05	1.18	Out	40	320	0.2
1 x 1/8	33HB1010001C	34HB1010001C	1.12	1.15	In	30	240	0.2
1 x 1/4	33HB1010002C	34HB1010002C	1.12	1.15	In	30	240	0.2
1 x 3/8	33HB1010003C	34HB1010003C	1.16	1.40	Out	30	240	0.2
1 x 1/2	33HB1010004C	34HB1010004C	1.16	1.40	Out	30	240	0.2
1 x 3/4	33HB1010006C	34HB1010006C	1.18	1.40	Out	30	240	0.2
1-1/4 x 1/4	33HB1012002C	34HB1012002C	1.16	1.15	In	30	120	0.4
1-1/4 x 3/8	33HB1012003C	34HB1012003C	1.20	1.15	In	30	120	0.4
1-1/4 x 1/2	33HB1012004C	34HB1012004C	1.25	1.38	In	30	120	0.4
1-1/4 x 3/4	33HB1012006C	34HB1012006C	1.25	1.80	Out	30	120	0.3
1-1/4 x 1	33HB1012010C	34HB1012010C	1.25	1.80	Out	30	120	0.3
1-1/2 x 1/8	33HB1014001C	34HB1014001C	1.30	1.18	In	25	100	0.4
1-1/2 x 1/4	33HB1014002C	34HB1014002C	1.30	1.18	In	25	100	0.6
1-1/2 x 3/8	33HB1014003C	34HB1014003C	1.30	1.18	In	25	100	0.6
1-1/2 x 1/2	33HB1014004C	34HB1014004C	1.30	1.40	In	25	100	0.5
1-1/2 x 3/4	33HB1014006C	34HB1014006C	1.30	1.66	In	25	100	0.5
1-1/2 x 1	33HB1014010C	34HB1014010C	1.30	1.95	Out	25	100	0.5
1-1/2 x 1-1/4	33HB1014012C	34HB1014012C	1.30	1.95	Out	25	100	0.3
2 x 1/4	33HB1020002C	34HB1020002C	1.40	1.18	In	20	80	0.7
2 x 3/8	33HB1020003C	34HB1020003C	1.40	1.18	In	20	80	0.8
2 x 1/2	33HB1020004C	34HB1020004C	1.50	1.37	In	20	80	0.9
2 x 3/4	33HB1020006C	34HB1020006C	1.50	1.68	In	20	80	0.9
2 x 1	33HB1020010C	34HB1020010C	1.50	1.97	In	20	80	0.8
2 x 1-1/4	33HB1020012C	34HB1020012C	1.50	2.55	Out	20	80	0.7
2 x 1-1/2	33HB1020014C	34HB1020014C	1.50	2.55	Out	20	80	0.7
2-1/2 x 1/2	33HB1024004C	34HB1024004C	1.70	3.25	Out	15	60	0.9
2-1/2 x 3/4	33HB1024006C	34HB1024006C	1.58	1.65	In	15	60	1.5
2-1/2 x 1	33HB1024010C	34HB1024010C	1.58	2.00	In	15	60	1.5
2-1/2 x 1-1/4	33HB1024012C	34HB1024012C	1.58	2.40	In	15	60	1.4
2-1/2 x 1-1/2	33HB1024014C	34HB1024014C	1.58	2.70	In	12	48	1.4
2-1/2 x 2	33HB1024020C	34HB1024020C	1.65	3.00	Out	12	48	1.1
3 x 1/2	33HB1030004C	34HB1030004C	1.88	3.80	Out	6	24	2.0
3 x 3/4	33HB1030006C	34HB1030006C	1.75	1.70	In	6	24	1.9
3 x 1	33HB1030010C	34HB1030010C	1.70	2.00	In	6	24	2.1
3 x 1-1/4	33HB1030012C	34HB1030012C	1.70	2.40	In	6	24	2.1
3 x 1-1/2	33HB1030014C	34HB1030014C	1.70	2.70	In	6	24	2.2
3 x 2	33HB1030020C	34HB1030020C	1.80	3.70	Out	6	24	2.0
3 x 2-1/2	33HB1030024C	34HB1030024C	1.90	3.90	Out	6	24	1.6
3-1/2 x 1-1/2	33HB1034014C	34HB1034014C	1.75	2.75	In	-	20	1.5
3-1/2 x 2	33HB1034020C	34HB1034020C	1.94	1.80	In	-	20	2.4
3-1/2 x 2-1/2	33HB1034024C	34HB1034024C	1.70	4.30	Out	-	20	2.5
3-1/2 x 3	33HB1034030C	34HB1034030C	1.75	4.60	Out	-	20	1.9
4 x 3/4	33HB1040006C	34HB1040006C	2.00	2.00	In	-	20	4.4
4 x 1	33HB1040010C	34HB1040010C	1.90	2.00	In	-	20	4.5
4 x 1-1/4	33HB1040012C	34HB1040012C	1.90	2.40	In	-	20	2.7
4 x 1-1/2	33HB1040014C	34HB1040014C	1.90	2.70	In	-	20	4.2
4 x 2	33HB1040020C	34HB1040020C	1.90	3.30	In	-	20	3.8
4 x 2-1/2	33HB1040024C	34HB1040024C	1.90	3.95	In	-	20	3.9
4 x 3	33HB1040030C	34HB1040030C	2.10	4.70	Out	-	20	3.3
4 x 3-1/2	33HB1040034C	34HB1040034C	2.33	4.75	Out	-	20	3.0
5 x 2	33HB1050020C	34HB1050020C	2.05	3.30	In	-	10	5.1
5 x 2-1/2	33HB1050024C	34HB1050024C	2.10	4.00	In	-	10	4.2
5 x 3	33HB1050030C	34HB1050030C	2.10	4.70	In	-	10	4.4
5 x 4	33HB1050040C	34HB1050040C	2.10	5.80	Out	-	10	4.0

Bushings may have hexagon or octagon heads.

MALLEABLE

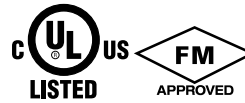


Fig. 33HB1 & 34HB1 – Hex Bushing cont.

Size in	Part Number		A in	B in	Hex	Packing		Weight lb
	Black	Galvanized				Inner	Master	
6 x 1-1/2	33HB1060014C	34HB1060014C	2.20	3.35	In	-	7	12.0
6 x 2	33HB1060020C	34HB1060020C	2.20	3.35	In	-	7	10.0
6 x 2-1/2	33HB1060024C	34HB1060024C	2.20	3.90	In	-	7	7.9
6 x 3	33HB1060030C	34HB1060030C	2.30	4.70	In	-	7	7.7
6 x 4	33HB1060040C	34HB1060040C	2.30	5.90	In	-	7	6.7
6 x 5	33HB1060050C	34HB1060050C	2.50	7.20	Out	-	7	6.3
8 x 6	33HB1080060C	34HB1080060C	2.75	9.00	Out	-	4	13.1

Bushings may have hexagon or octagon heads.

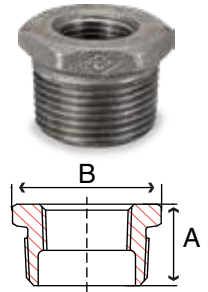


Fig. 33SP1 & 34SP1 – Square Head Plug

Size in	Part Number		A in	B in	Packing		Weight lb
	Black	Galvanized			Inner	Master	
1/8	33SP1001C	34SP1001C	0.65	0.30	300	4800	0.01
1/4	33SP1002C	34SP1002C	0.75	0.38	150	2400	0.03
3/8	33SP1003C	34SP1003C	0.85	0.44	100	1600	0.05
1/2	33SP1004C	34SP1004C	1.00	0.53	50	800	0.1
3/4	33SP1006C	34SP1006C	1.15	0.58	30	360	0.1
1	33SP1010C	34SP1010C	1.30	0.71	20	240	0.2
1-1/4	33SP1012C	34SP1012C	1.40	0.90	40	160	0.3
1-1/2	33SP1014C	34SP1014C	1.50	1.10	30	120	0.5
2	33SP1020C	34SP1020C	1.60	1.30	20	80	0.7
2-1/2	33SP1024C	34SP1024C	1.85	1.50	16	64	1.2
3	33SP1030C	34SP1030C	1.95	1.69	16	32	1.7
3-1/2	33SP1034C	34SP1034C	2.10	1.84	-	16	2.5
4	33SP1040C	34SP1040C	2.30	2.16	8	16	3.0
5	33SP1050C	34SP1050C	2.50	2.50	5	10	5.0
6	33SP1060C	34SP1060C	2.80	2.62	-	10	7.3

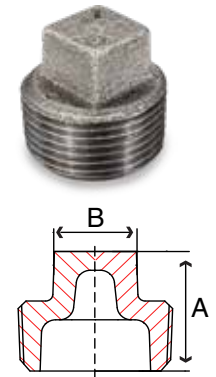


Fig. 33BP1 & 34BP1 – Bar Plug

Size in	Part Number		A in	Packing		Weight lb
	Black	Galvanized		Inner	Master	
4	33BP1040C	34BP1040C	2.30	8	16	3.5
5	33BP1050C	34BP1050C	2.45	-	10	5.2
6	33BP1060C	34BP1060C	2.70	-	10	8.3
8	33BP1080C	34BP1080C	3.00	-	4	20.7

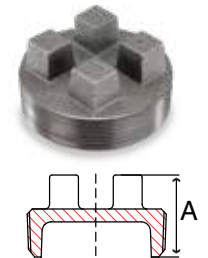


Fig. 33LN1 & 34LN1 – Lock Nut*

Size in	Part Number		A in	B in	Packing		Weight lb
	Black	Galvanized			Inner	Master	
1/8	33LN1001C	34LN1001C	0.30	0.71	250	4000	0.03
1/4	33LN1002C	34LN1002C	0.34	0.90	125	2000	0.03
3/8	33LN1003C	34LN1003C	0.30	1.05	125	1500	0.04
1/2	33LN1004C	34LN1004C	0.38	1.27	100	800	0.07
3/4	33LN1006C	34LN1006C	0.40	1.50	60	480	0.1
1	33LN1010C	34LN1010C	0.50	1.88	40	320	0.1
1-1/4	33LN1012C	34LN1012C	0.50	2.15	30	240	0.2
1-1/2	33LN1014C	34LN1014C	0.53	2.56	45	180	0.3
2	33LN1020C	34LN1020C	0.57	3.10	25	100	0.5
2-1/2	33LN1024C	34LN1024C	0.72	4.00	14	56	0.7
3	33LN1030C	34LN1030C	0.80	4.60	20	40	1.2
4	33LN1040C	34LN1040C	0.90	5.80	7	14	2.9

*NPSL Threads

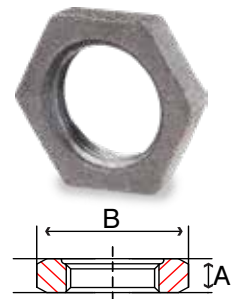


Fig. 33WN1 & 34WN1 – Waste Nut

Size in	Part Number		A in	B in	Packing		Weight lb
	Black	Galvanized			Inner	Master	
1/2	33WN1004C	34WN1004C	2.00	3.15	25	200	0.4
3/4	33WN1006C	34WN1006C	2.50	3.87	20	160	0.5

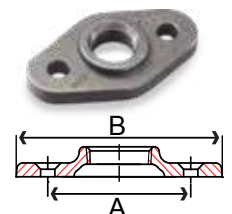
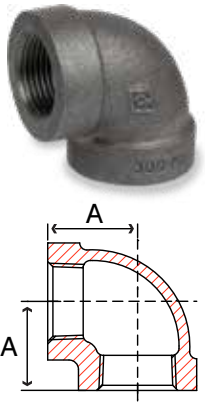
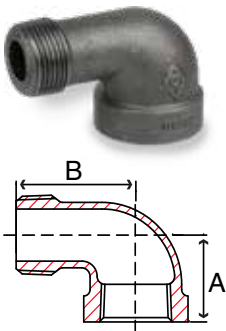


Fig. 33E 3 & 34E 3 – 90° Elbow



Size in	Part Number		A in	Packing		Weight lb
	Black	Galvanized		Inner	Master	
1/4	33E 3002C	34E 3002C	0.94	150	300	0.1
3/8	33E 3003C	34E 3003C	1.06	60	120	0.2
1/2	33E 3004C	34E 3004C	1.25	60	120	0.4
3/4	33E 3006C	34E 3006C	1.44	50	100	0.6
1	33E 3010C	34E 3010C	1.63	20	40	1.0
1-1/4	33E 3012C	34E 3012C	1.94	14	28	1.6
1-1/2	33E 3014C	34E 3014C	2.13	12	24	2.2
2	33E 3020C	34E 3020C	2.50	6	12	3.5
2-1/2	33E 3024C	34E 3024C	2.94	-	8	5.5
3	33E 3030C	34E 3030C	3.38	-	4	8.4
4	33E 3040C	34E 3040C	4.50	-	2	16.2

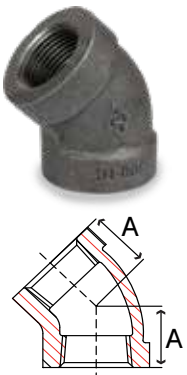
Fig. 33SE3 & 34SE3 – 90° Street Elbow



Size in	Part Number		A in	B in	Packing		Weight lb
	Black	Galvanized			Inner	Master	
1/4	33SE3002C	34SE3002C	0.94	1.44	140	280	0.1
3/8	33SE3003C	34SE3003C	1.06	1.63	120	240	0.2
1/2	33SE3004C	34SE3004C	1.25	2.00	60	120	0.3
3/4	33SE3006C	34SE3006C	1.44	2.19	40	80	0.5
1	33SE3010C	34SE3010C	1.63	2.56	30	60	0.9
1-1/4	33SE3012C	34SE3012C	1.94	2.88	18	36	1.5
1-1/2	33SE3014C	34SE3014C	2.13	3.13	12	24	2.0
2	33SE3020C	34SE3020C	2.50	3.69	6	12	3.3
2-1/2	33SE3024C	34SE3024C	2.94	4.50	-	12	5.4
3	33SE3030C	34SE3030C	3.38	5.13	-	4	8.4

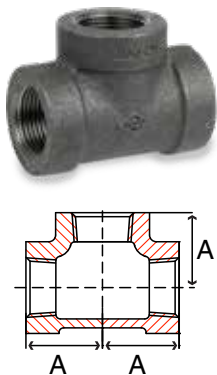
All male threads come with plastic protective caps

Fig. 33F 3 & 34F 3 – 45° Elbow



Size in	Part Number		A in	Packing		Weight lb
	Black	Galvanized		Inner	Master	
1/4	33F 3002C	34F 3002C	0.81	120	240	0.1
3/8	33F 3003C	34F 3003C	0.88	100	200	0.2
1/2	33F 3004C	34F 3004C	1.00	60	120	0.3
3/4	33F 3006C	34F 3006C	1.13	60	120	0.6
1	33F 3010C	34F 3010C	1.31	30	60	0.9
1-1/4	33F 3012C	34F 3012C	1.50	12	24	1.5
1-1/2	33F 3014C	34F 3014C	1.69	12	24	2.0
2	33F 3020C	34F 3020C	2.00	6	12	3.2
2-1/2	33F 3024C	34F 3024C	2.25	4	8	5.0
3	33F 3030C	34F 3030C	2.50	-	4	7.5
4	33F 3040C	34F 3040C	2.81	-	2	12.6

Fig. 33T 3 & 34T 3 – Tee



Size in	Part Number		A in	Packing		Weight lb
	Black	Galvanized		Inner	Master	
1/4	33T 3002C	34T 3002C	0.94	120	240	0.2
3/8	33T 3003C	34T 3003C	1.06	90	180	0.3
1/2	33T 3004C	34T 3004C	1.25	60	120	0.6
3/4	33T 3006C	34T 3006C	1.44	20	40	0.9
1	33T 3010C	34T 3010C	1.63	20	40	1.4
1-1/4	33T 3012C	34T 3012C	1.94	12	24	2.3
1-1/2	33T 3014C	34T 3014C	2.13	8	16	3.1
2	33T 3020C	34T 3020C	2.50	5	10	4.8
2-1/2	33T 3024C	34T 3024C	2.94	3	6	7.6
3	33T 3030C	34T 3030C	3.38	-	4	11.6
4	33T 3040C	34T 3040C	4.50	-	2	22.6

MALLEABLE



Fig. 33RT3 & 34RT3 – Reducing Tee

Size in	Part Number		A in	B in	Packing		Weight lb
	Black	Galvanized			Inner	Master	
3/4 x 1/2	33RT3006004C	34RT3006004C	1.31	1.38	20	40	0.8
1 x 1/2	33RT3010004C	34RT3010004C	1.44	1.50	20	40	1.1
1 x 3/4	33RT3010006C	34RT3010006C	1.50	1.56	20	40	1.2
1-1/4 x 1/2	33RT3012004C	34RT3012004C	1.50	1.69	12	24	1.6
1-1/4 x 3/4	33RT3012006C	34RT3012006C	1.63	1.75	12	24	1.8
1-1/4 x 1	33RT3012010C	34RT3012010C	1.75	1.81	12	24	2.0
1-1/2 x 1/2	33RT3014004C	34RT3014004C	1.63	1.81	8	16	2.1
1-1/2 x 3/4	33RT3014006C	34RT3014006C	1.69	1.88	8	16	2.3
1-1/2 x 1	33RT3014010C	34RT3014010C	1.81	2.00	8	16	2.5
1-1/2 x 1-1/4	33RT3014012C	34RT3014012C	2.00	2.06	8	16	2.8
2 x 1/2	33RT3020004C	34RT3020004C	1.75	2.06	5	10	3.1
2 x 3/4	33RT3020006C	34RT3020006C	1.81	2.13	5	10	3.2
2 x 1	33RT3020010C	34RT3020010C	2.00	2.25	5	10	3.6
2 x 1-1/4	33RT3020012C	34RT3020012C	2.13	2.31	5	10	3.9
2 x 1-1/2	33RT3020014C	34RT3020014C	2.25	2.38	5	10	4.2
2-1/2 x 2	33RT3024020C	34RT3024020C	2.69	2.75	-	8	6.7
3 x 2	33RT3030020C	34RT3030020C	2.81	3.13	-	4	9.1
4 x 2-1/2	33RT3040024C	34RT3040024C	3.70	4.00	2	4	9.5
4 x 3	33RT3040030C	34RT3040030C	4.00	4.25	2	4	10.3

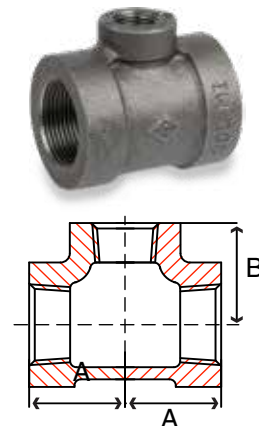


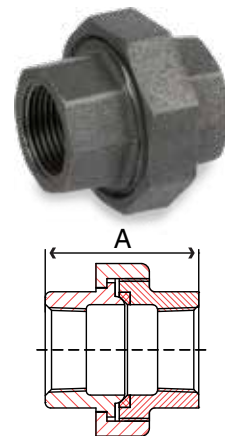
Fig. 33C 3 & 34C 3 – Cap

Size in	Part Number		A in	Packing		Weight lb
	Black	Galvanized		Inner	Master	
1/4	33C 3002C	34C 3002C	0.78	240	480	0.1
3/8	33C 3003C	34C 3003C	0.83	180	360	0.1
1/2	33C 3004C	34C 3004C	0.98	60	120	0.2
3/4	33C 3006C	34C 3006C	1.08	40	80	0.3
1	33C 3010C	34C 3010C	1.26	25	50	0.5
1-1/4	33C 3012C	34C 3012C	1.38	20	40	0.8
1-1/2	33C 3014C	34C 3014C	1.43	20	40	1.1
2	33C 3020C	34C 3020C	1.68	12	24	1.7
2-1/2	33C 3024C	34C 3024C	2.06	6	12	2.8
3	33C 3030C	34C 3030C	2.17	6	12	4.2
4	33C 3040C	34C 3040C	2.48	3	6	7.2



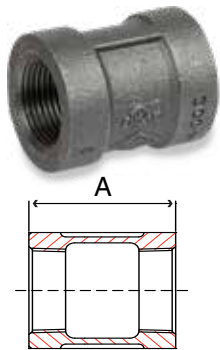
Fig. 33U 3 & 34U 3 – Union with Brass Seat

Size in	Part Number		A in	Packing		Weight lb
	Black	Galvanized		Inner	Master	
1/4	33U 3002C	34U 3002C	1.55	100	200	0.3
3/8	33U 3003C	34U 3003C	1.71	60	120	0.4
1/2	33U 3004C	34U 3004C	1.81	40	80	0.5
3/4	33U 3006C	34U 3006C	2.12	20	40	0.8
1	33U 3010C	34U 3010C	2.31	25	50	1.1
1-1/4	33U 3012C	34U 3012C	2.66	15	30	1.9
1-1/2	33U 3014C	34U 3014C	2.85	12	24	2.5
2	33U 3020C	34U 3020C	3.23	6	12	3.6
2-1/2	33U 3024C	34U 3024C	3.33	4	8	5.1
3	33U 3030C	34U 3030C	4.09	4	8	7.8
4	33U 3040C	34U 3040C	4.47	-	4	13.1



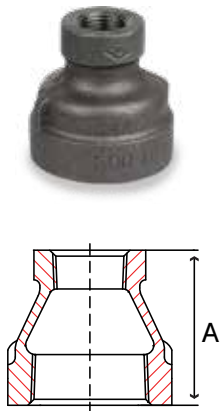
MALLEABLE

Fig. 33CP3 & 34CP3 – Banded Coupling



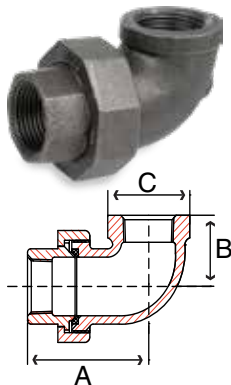
Size in	Part Number		A in	Packing		Weight lb
	Black	Galvanized		Inner	Master	
1/4	33CP3002C	34CP3002C	1.37	200	400	0.1
3/8	33CP3003C	34CP3003C	1.62	100	200	0.2
1/2	33CP3004C	34CP3004C	1.87	60	120	0.3
3/4	33CP3006C	34CP3006C	2.12	40	80	0.5
1	33CP3010C	34CP3010C	2.37	40	80	0.9
1-1/4	33CP3012C	34CP3012C	2.87	12	24	1.5
1-1/2	33CP3014C	34CP3014C	2.87	12	24	1.9
2	33CP3020C	34CP3020C	3.62	8	16	3.1
2-1/2	33CP3024C	34CP3024C	4.12	4	8	4.9
3	33CP3030C	34CP3030C	4.12	4	8	6.8
4	33CP3040C	34CP3040C	4.69	-	4	11.3

Fig. 33RC3 & 34RC3 – Reducing Coupling



Size in	Part Number		A in	Packing		Weight lb
	Black	Galvanized		Inner	Master	
3/8 x 1/4	33RC3003002C	34RC3003002C	1.44	100	200	0.2
1/2 x 1/4	33RC3004002C	34RC3004002C	1.69	100	200	0.2
1/2 x 3/8	33RC3004003C	34RC3004003C	1.69	100	200	0.3
3/4 x 3/8	33RC3006003C	34RC3006003C	1.75	30	60	0.4
3/4 x 1/2	33RC3006004C	34RC3006004C	1.75	45	90	0.4
1 x 1/2	33RC3010004C	34RC3010004C	2.00	50	100	0.6
1 x 3/4	33RC3010006C	34RC3010006C	2.00	50	100	0.7
1-1/4 x 1/2	33RC3012004C	34RC3012004C	2.38	25	50	0.9
1-1/4 x 3/4	33RC3012006C	34RC3012006C	2.38	30	60	1.0
1-1/4 x 1	33RC3012010C	34RC3012010C	2.38	30	60	1.1
1-1/2 x 1/2	33RC3014004C	34RC3014004C	2.69	30	60	1.3
1-1/2 x 3/4	33RC3014006C	34RC3014006C	2.69	30	60	1.3
1-1/2 x 1	33RC3014010C	34RC3014010C	2.69	20	40	1.4
1-1/2 x 1-1/4	33RC3014012C	34RC3014012C	2.69	20	40	1.6
2 x 1/2	33RC3020004C	34RC3020004C	3.19	16	32	1.9
2 x 3/4	33RC3020006C	34RC3020006C	3.19	16	32	2.1
2 x 1	33RC3020010C	34RC3020010C	3.19	16	32	2.2
2 x 1-1/4	33RC3020012C	34RC3020012C	3.19	12	24	2.3
2 x 1-1/2	33RC3020014C	34RC3020014C	3.19	12	24	2.5
2-1/2 x 1-1/2	33RC3024014C	34RC3024014C	3.69	4	8	3.6
2-1/2 x 2	33RC3024020C	34RC3024020C	3.69	4	8	3.9
3 x 2	33RC3030020C	34RC3030020C	4.06	-	8	5.6
3 x 2-1/2	33RC3030024C	34RC3030024C	4.06	-	8	5.9
4 x 3	33RC3040030C	34RC3040030C	4.38	-	6	9.2

Fig. 33UE3 & 34UE3 – Union Elbow with Brass Seat*



Size in	Part Number		A in	B in	C in	Packing		Weight lb
	Black	Galvanized				Inner	Master	
1/2	33UE3004C	34UE3004C	2.16	0.98	1.20	40	80	0.3
3/4	33UE3006C	34UE3006C	2.36	1.14	1.46	30	60	0.9
1	33UE3010C	34UE3010C	2.81	1.34	1.77	20	40	1.3
1-1/4	33UE3012C	34UE3012C	3.23	1.61	2.15	10	20	2.0
1-1/2	33UE3014C	34UE3014C	3.53	1.80	2.43	10	20	2.5
2	33UE3020C	34UE3020C	4.10	2.14	2.96	5	10	3.7

* Made from ductile iron

***Order All This
And More . . .***



***On-Line with Order Pro
Learn more at www.smithcooper.com***

About ASC Engineered Solutions

ASC Engineered Solutions is defined by quality—in its products, services and support. With more than 1,400 employees, the company’s portfolio of precision-engineered piping support, valves and connections provides products to more than 4,000 customers across industries, such as mechanical, industrial, fire protection, oil and gas, and commercial and residential construction. Its portfolio of leading brands includes ABZ Valve®, AFCON®, Anvil®, Anvil EPS, Anvil Services, Basic-PSA, Beck®, Catawissa, Cooplet®, FlexHead®, FPPI®, Gruvlok®, J.B. Smith, Merit®, North Alabama Pipe, Quadrant®, SCI®, Sharpe®, SlideLOK®, SPF® and SprinkFLEX®. With headquarters in Commerce, CA, and Exeter, NH, ASC also has ISO 9001:2015 certified production facilities in PA, TN, IL, TX, AL, LA, KS, and RI.



asc-es.com

Building connections that last™

