

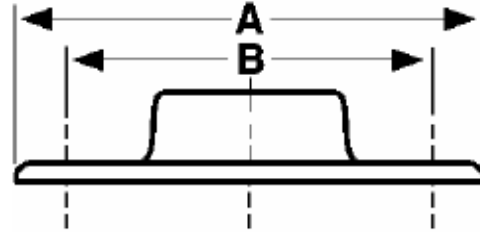

Floor Flange  
**150# Malleable Iron**  
Inches / Pounds



Size	A	B	Hole	Approximate Weight (in Pounds)
3/8	3.50	2.50	0.25	0.26
1/2	3.50	2.50	0.25	0.36
3/4	3.50	2.50	0.25	0.50
1	4.00	3.00	0.25	0.60
1 1/4	4.00	3.00	0.25	0.88
1 1/2	4.50	3.50	0.31	1.08
2	5.50	4.25	0.31	1.58

- \*Malleable Castings conform to ASTM A197*
- \*Hot-Dipped Galvanized Fittings conform to ASTM A153*
- \*Malleable Fitting Dimensions conform to ASME B16.3*
- \*Malleable Bushings, Plugs and Locknuts conform to ASME B16.14*
- \*Malleable Unions conform to ASME B16.39*
- \*NPT Threads on all fittings conform to ASME B1.20.1*