

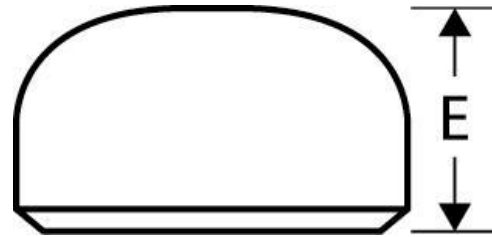

Caps
STANDARD WEIGHT
Inches / Pounds



Nominal Pipe Size	Outside Diameter	Inside Diameter	Wall Thickness	Length (E)	Pipe Schedule	Approximate Weight (in Pounds)
1/2	0.84	0.622	0.109	1.00	STD/40	0.08
3/4	1.05	0.824	0.113	1.25	STD/40	0.14
1	1.32	1.049	0.133	1.50	STD/40	0.21
1 1/4	1.66	1.380	0.140	1.50	STD/40	0.33
1 1/2	1.90	1.610	0.145	1.50	STD/40	0.54
2	2.38	2.067	0.154	1.50	STD/40	0.8
2 1/2	2.88	2.469	0.203	1.50	STD/40	1
3	3.50	3.068	0.216	2.00	STD/40	1.7
3 1/2	4.00	3.548	0.226	2.50	STD/40	2.3
4	4.50	4.026	0.237	2.50	STD/40	2.8
5	5.56	5.047	0.258	3.00	STD/40	4.6
6	6.62	6.065	0.280	3.50	STD/40	6.9
8	8.62	7.981	0.322	4.00	STD/40	11.8
10	10.75	10.020	0.365	5.00	STD/40	20.8
12	12.75	12.000	0.375	6.00	STD*	30.3
14	14.00	13.250	0.375	6.50	STD/30	36.5
16	16.00	15.250	0.375	7.00	STD/30	43.5
18	18.00	17.250	0.375	8.00	STD*	57
20	20.00	19.250	0.375	9.00	STD/20	75.7
22	22.00	21.250	0.375	10.00	STD/20	86
24	24.00	23.250	0.375	10.50	STD/20	101
26	26.00	25.250	0.375	10.50	STD*	110
30	30.00	29.250	0.380	10.50	STD*	137
34	34.00	33.250	0.380	10.50	STD*	160
36	36.00	35.250	0.380	10.50	STD*	175
42	42.00	41.250	0.380	12.00	STD*	229
48	48.00	47.240	0.380	13.50	STD*	350

** STD* designates Standard Weight (standard wall). This size and thickness do not correspond to any pipe schedule number.*

** Dimensions conform to ASME B16.9 & material conforms to ASTM SA-234 Grade B.*